

Material:
 Insulator: Glass filled Polyester UL 94V-0
 Shell: Steel, Tin plated as standard

Coaxial terminal
 Insulator: Teflon UL 94V-0, Color white
 Contact: Brass

#4-40 UNC TYP.2

Ordering Code

C8W8 S C V 3 0 1 75 D00
 ① ② ③ ④ ⑤ ⑥ ⑦ ⑧ ⑨

- ① Series No.
- ② Connector Type: S= Receptacle
- ③ Contact type: C= Coaxial Contact
- ④ Contact tail style: V= Straight Dip type
- ⑤ Coaxial contact plating:
 2= Gold flash plated over Nickel
 3= 15μ" Gold plated over Nickel
 4= 30μ" Gold plated over Nickel
 5= 50μ" Gold plated over Nickel
- ⑥ Singal contact plating:
 0= Without singal contact
- ⑦ Insulator color: 1= Black, 6= Green
- ⑧ Performance: 50= 50Ω, 75= 75Ω
- ⑨ Mounting Style:
 000= With ø3.05mm holes on shell
 B00= Riveted #4-40 UNC open nuts on front shell
 C00= Riveted #4-40 UNC open nuts on rear shell
 D00= Riveted #4-40 UNC ground stand-off on rear shell(standard)

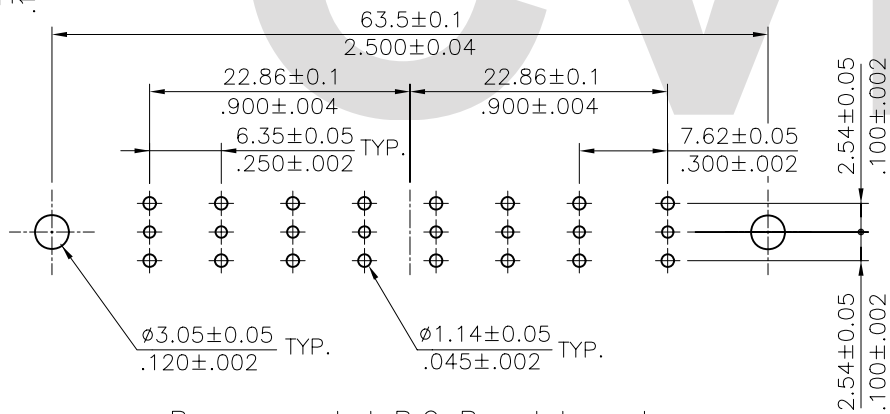
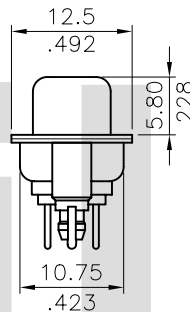
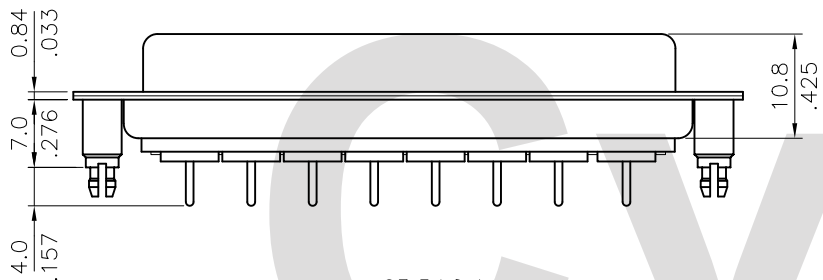
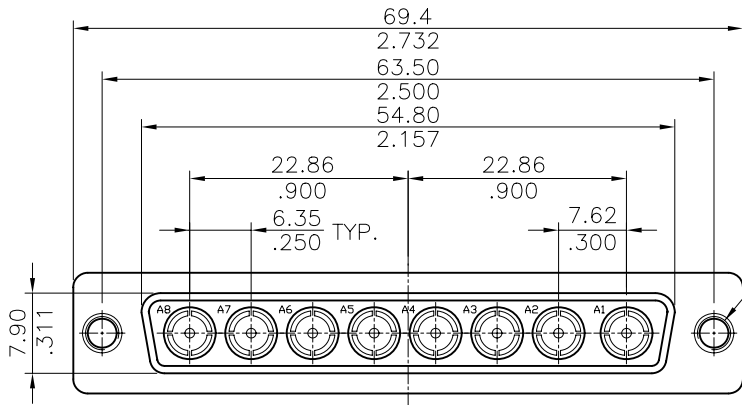

Recommended P.C Board Layout

Mounting Style				RoHS Compliant			
Code	000	Code	B00	Code	C00	Code	D00
		DIM. L= 4.0mm 		DIM. L= 4.0mm 		DIM. L= 7.0mm 	

△4				DATE	UNIT: mm / inch	TITLE: C8W8 COAXIAL FEMALE D-SUB CONNECTOR (TOP ENTRY BOARD MOUNT TYPE)	 瀚荃股份有限公司 CviLux Corporation
△3				DRAWN BY: Rita	TOLERANCE UNLESS OTHERWISE SPECIFIED	MATERIAL:	
△2				ENGINEER: David	.X ± 0.30/012 .X' ± 1'	FINISH:	
△1				CHECKED BY: David	.XX ± 0.20/008 .X' ±		
SYM	NAME	DATE	REVISIONS	APPROVED BY: Alex	10/19-01'	.XXX ± 0.10/004 .XX' ±	DRAWING NO. C8W804SB PART NO. C8W8SCV*0****00 SCALE 2 / 1 SHEET 1 OF 1

CVILUX.CORP
 2001.10.23
 ISSUED