

8. MATERIAL: HOUSING: PLASTIC; GROMMET/SEAL: RUBBER; THREADED INSERT: STEEL
7. MAX. ACCEPTABLE THICKNESS OF MOUNTING WALL IS .195 [4.95 mm].
6. RECOMMENDED TORQUE VALUE FOR SCREW: 19.91±2.21 IN/LB [2.25±0.25 Nm]
5. THIS RECEPTACLE MATES WITH DTV06-18S*-**** PLUG. (* = A,B,C,D KEYS; **** = ALL MODIFICATIONS). CONSULT FACTORY FOR MODS.
4. FOR CONTACT AND WIRE PERFORMANCE AND APPLICATION CHARACTERISTICS SEE ENVELOPE DRAWINGS 0425-015-0000.

3. ITEMS SOLD SEPARATELY: SECONDARY WEDGE LOCK (WV-18P)
2. DIMENSION TOLERANCE: ±.025 [.64].
1. ALL DIMENSIONS ARE INCHES [mm].

NOTES: UNLESS OTHERWISE SPECIFIED

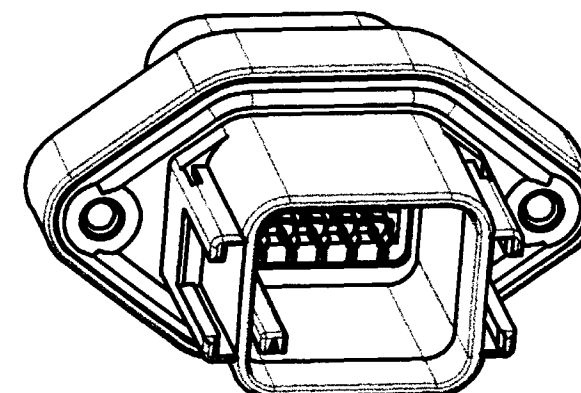

CONTACT SIZE	MIN. INSUL. O.D.	MAX. INSUL. O.D.	WIRE RANGE [mm ²] REF ONLY
16	.088 [2.23]	.145 [3.68]	14-20 AWG [2.0-0.5]

SIGNATURE & DATE	
DR	S. PALLUTH 03/27/01
CHK	4/5/00
PE	4/2/01
APPD	4/5/01
SCALE	NONE

RECEPTACLE
FLANGE MOUNT
18 CONTACTS, SIZE 16
KEYS A,B,C & D
DTV SERIES
ENVELOPE

CP 072	MATL. CODE
The Deutsch Company DEUTSCH I.P.D. 3850 INDUSTRIAL AVE. HEMET, CALIF. 92545	
B	DTV02-18P*
DWG SIZE	CODE 11139 SHEET 1 OF 2

REVISIONS			
REV	SYM	DESCRIPTION	DATE
NC	NC	NEW RELEASE PER E.O. P17206	4-5-01

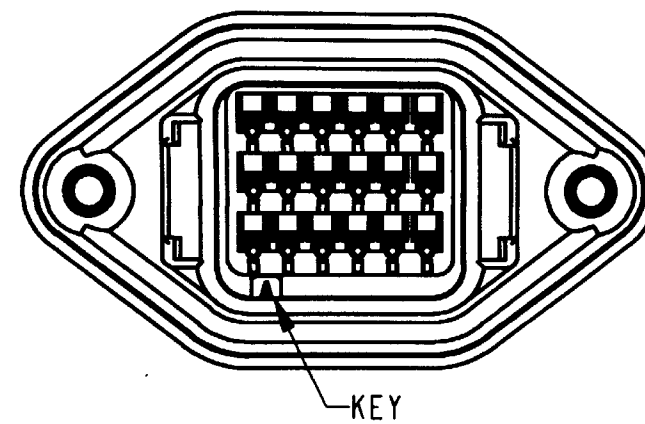

DTV02-18PA
KEY ARRANGEMENT -A-
COLOR: GREY

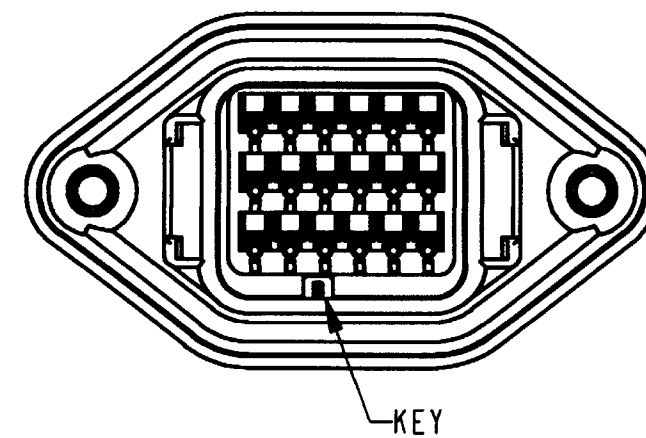

DTV02-18PB
KEY ARRANGEMENT -B-
COLOR: BLACK

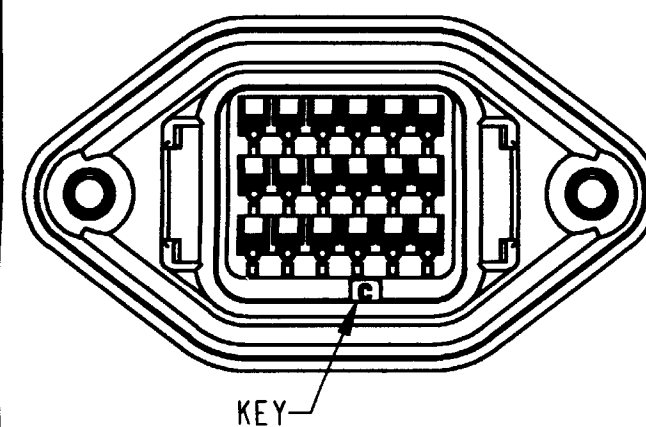

DTV02-18PC
KEY ARRANGEMENT -C-
COLOR: GREEN

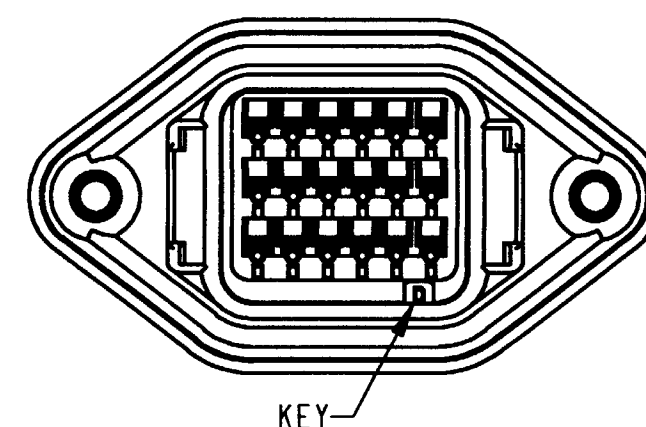

DTV02-18PD
KEY ARRANGEMENT -D-
COLOR: BROWN

NOTES:

REV
NC DTV02-18P *

REVISIONS			
SYM	DESCRIPTION	DATE	APPROVED
	SEE SHEET 1	4-5-01	RDR

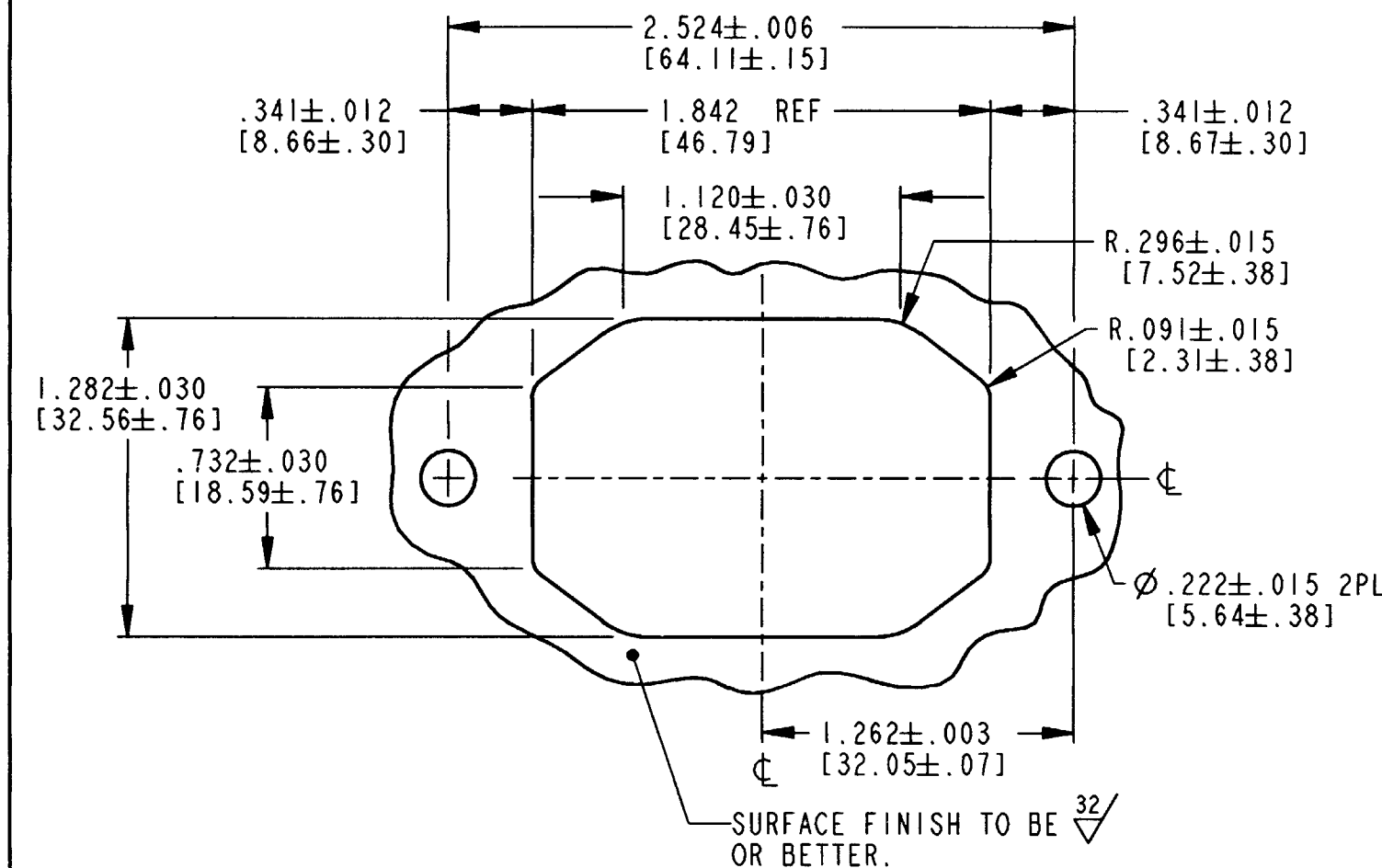

RECOMMENDED CUTOUT

SIGNATURE & DATE	
DR	S. PALLUTH 03/27/01
CHK	R. M. 4/5/01
PE	S. Palluth 4/2/01
APPD	D. M. 4/2/01
SCALE	NONE

RECEPTACLE
FLANGE MOUNT
18 CONTACTS, SIZE 16
KEYS A,B,C & D
DTV SERIES
ENVELOPE

CP 072	MATL. CODE
The Deutsch Company DEUTSCH I.P.D. 3850 INDUSTRIAL AVE. HEMET, CALIF. 92545	
B	DTV02-18P *
DWG SIZE	CODE 11139 SHEET 2 OF 2