

3D VIEW

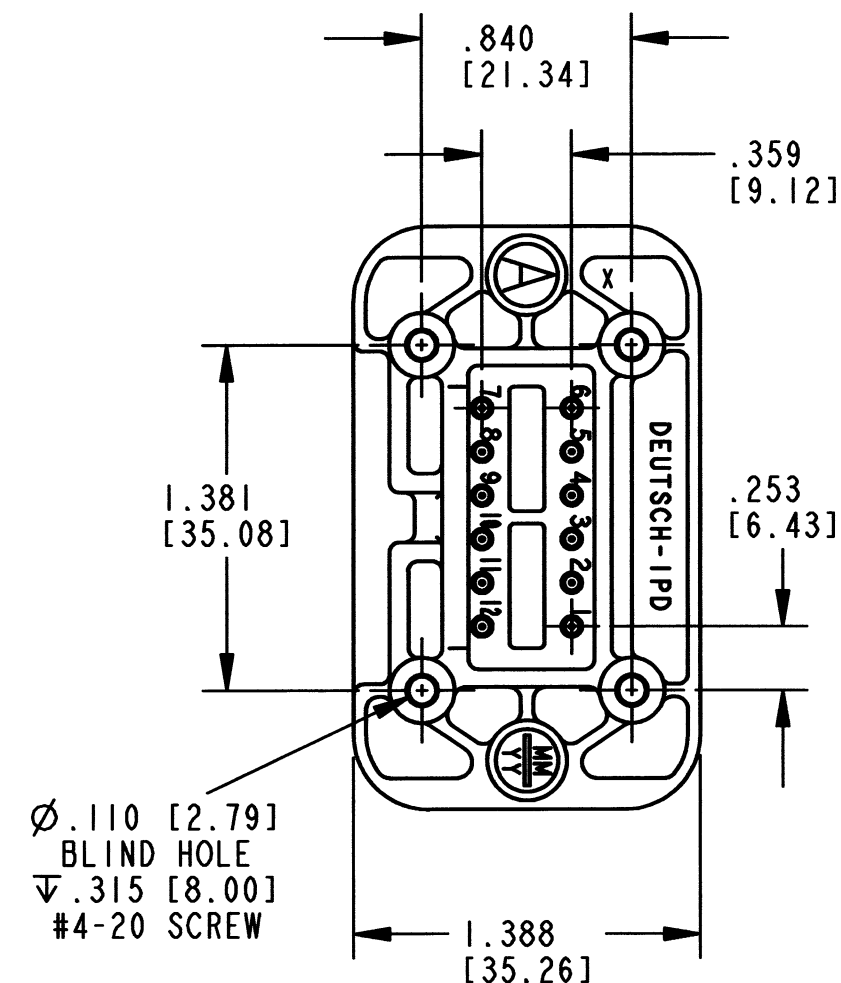
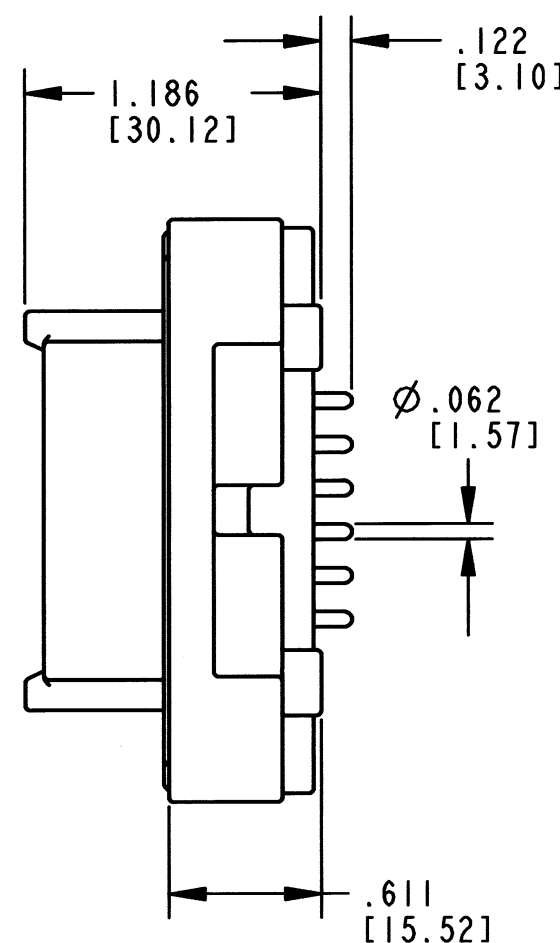
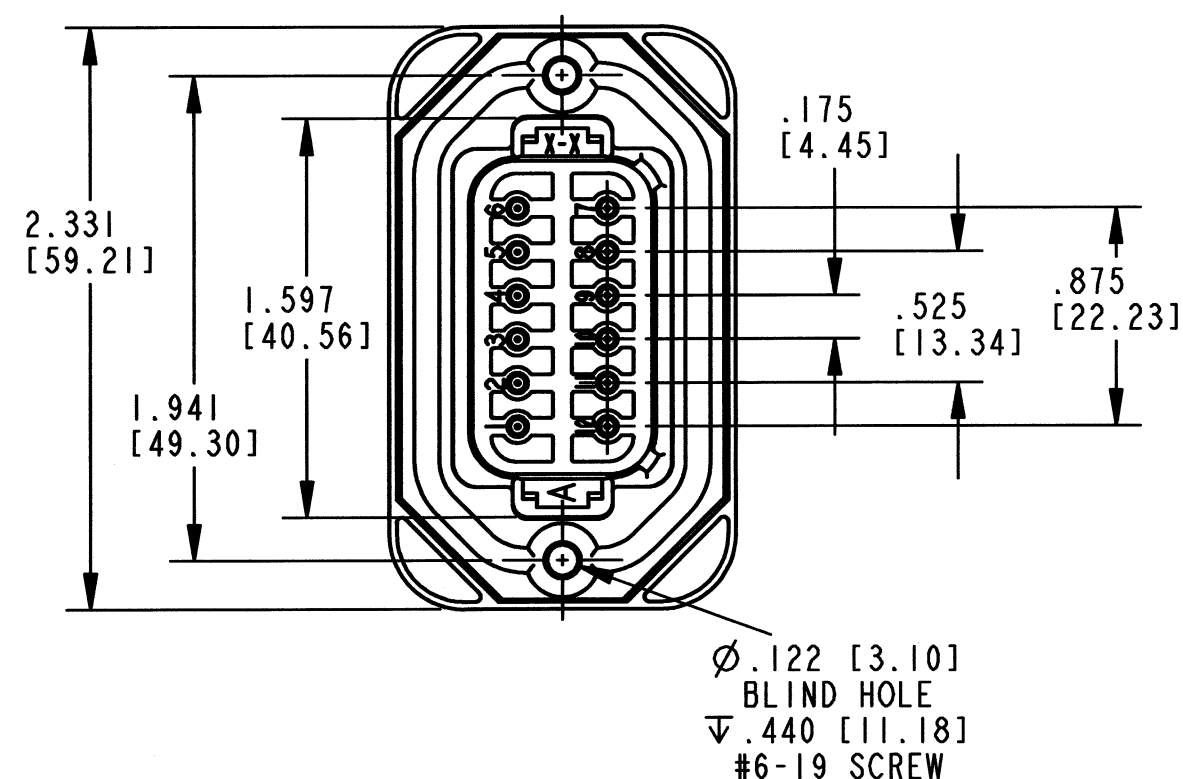

- NOTES:
1. DIMENSIONS SHOWN IN INCHES [MILLIMETERS].
 2. DIMENSION TOLERANCE $\pm .025$ [.64]. FOR PANEL CUTOUTS $\pm .010$ [.25].
 3. SHELL MATERIAL: PLASTIC; FLANGE SEAL MATERIAL: RUBBER.
 4. THIS RECEPTACLE MATES WITH DT06-12S* PLUG -****- ALL MODIFICATIONS.
 5. MOUNTING HOLES WILL ACCEPT CAMCAR PLASTITE SELF THREAD SCREWS (NOT INCLUDED). EXAMPLE: #6-19, #4-20.
 6. RECOMMENDED TORQUE VALUES ARE AS FOLLOWS: #6-19 SCREWS: 10-20 IN LB. [1.13-2.26 N-M]. #4-20 SCREWS: 6-10 IN LB. [.68-1.13 N-M].

REV
A DT15-12P*-G003

REVISIONS			
SYM	DESCRIPTION	DATE	APPROVED
NC	NEW RELEASE PER E.O. P17308	9/24/01	R.D.R.
A	REVISED PER E.O. P21065	8-26-11	ADP

SIGNATURE & DATE	
DR	P. BURKE 6/8/01
CHK	P. Byford 8/26/01
PE	Klicker 8/15/11
APPD	S. Beme 8/25/11
SCALE	NONE
WT	

PCB MOUNT
RECEPTACLE
12 PINS STRAIGHT
DT SERIES

ENVELOPE

EP	MATL. CODE
3850 INDUSTRIAL AVE. HEMET, CA 92545	
B	DT15-12P*-G003
DWG SIZE	CODE 11139
SHEET	1 OF 2

REV
A DT15-12P*-G003

REVISIONS			
SYM	DESCRIPTION	DATE	APPROVED
A	SEE SHEET ONE	8-26-11	ADR

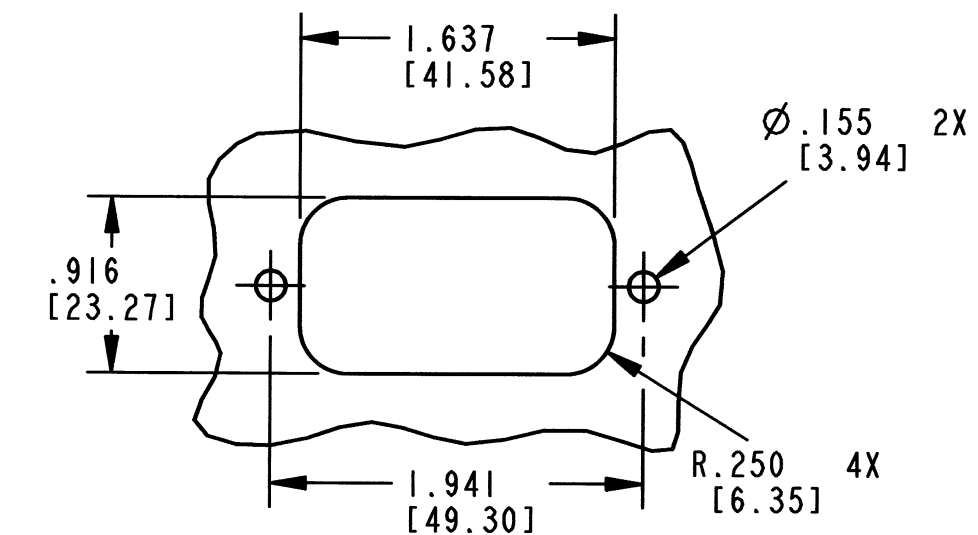
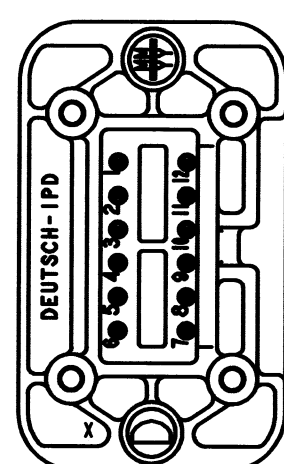
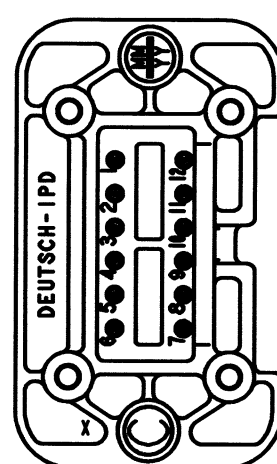
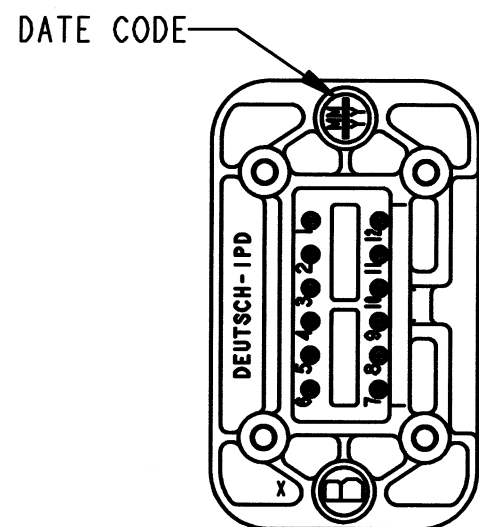
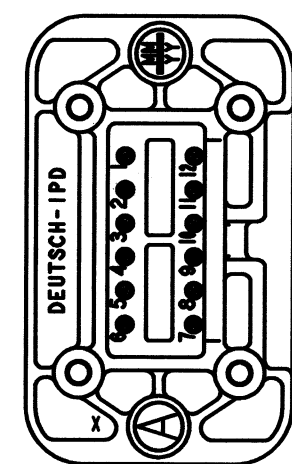
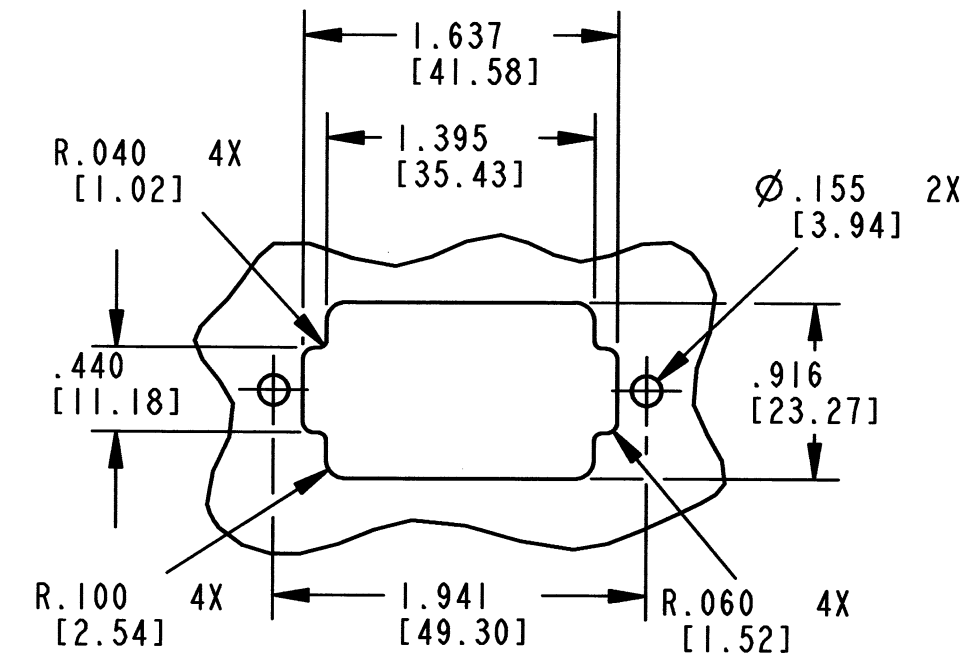
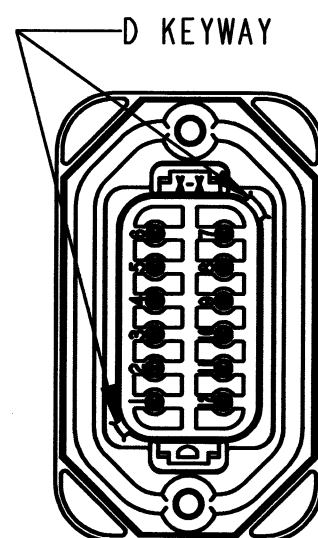
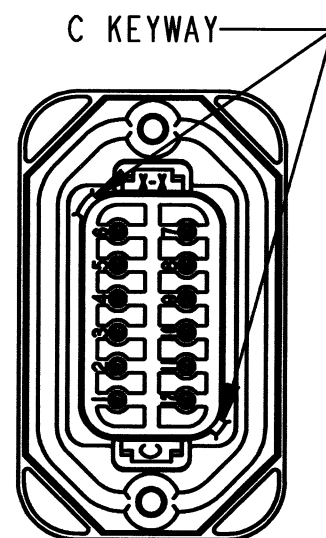
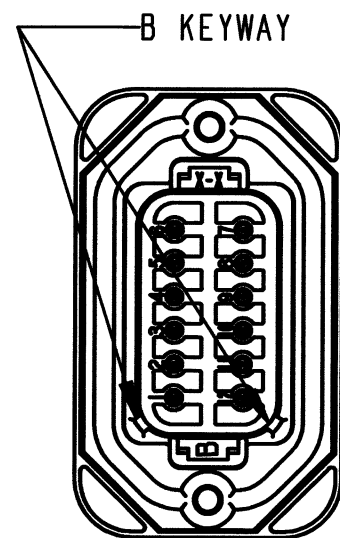
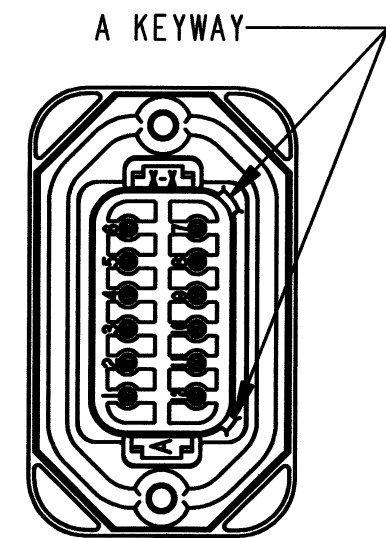

DT15-12PA-G003
COLOR GREY

DT15-12PB-G003
COLOR BLACK

DT15-12PC-G003
COLOR GREEN

DT15-12PD-G003
COLOR BROWN

RECOMMENDED PANEL CUTOUTS

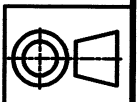

NOTES:

SIGNATURE & DATE	
DR	P. BURKE 6/8/01
CHK	P. Burke 8/26/11
PE	Klicker 4/5/11
APPD	S. Borden 8/25/11
SCALE	NONE WT

PCB MOUNT
RECEPTACLE
12 PINS STRAIGHT
DT SERIES

ENVELOPE

EP	MATL. CODE
3850 INDUSTRIAL AVE. HEMET, CA 92545	
B	DT15-12P*-G003
DWG SIZE	CODE 11139 SHEET 2 OF 2