

REV
B DT06-12S*-CE13

REVISIONS			
SYM	DESCRIPTION	DATE	APPROVED
NC	NEW RELEASE PER E.O. P19336	8/15/06	R.D.R.
A	REVISED PER E.O. P19925	7/30/08	R.D.R.
B	REVISED PER E.O. P20338	11-5-09	ADR

DATE CODE: MONTH REPRESENTED BY SEQUENTIAL ALPHA CHARACTERS.
EX. A = JANUARY
YEAR IS REPRESENTED BY LAST NUMERICAL DIGIT.
EX. 6 = 2006

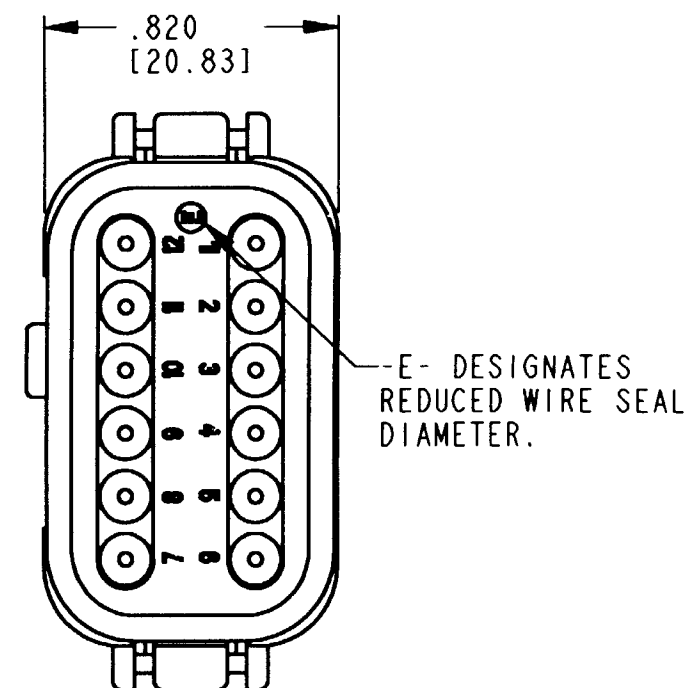
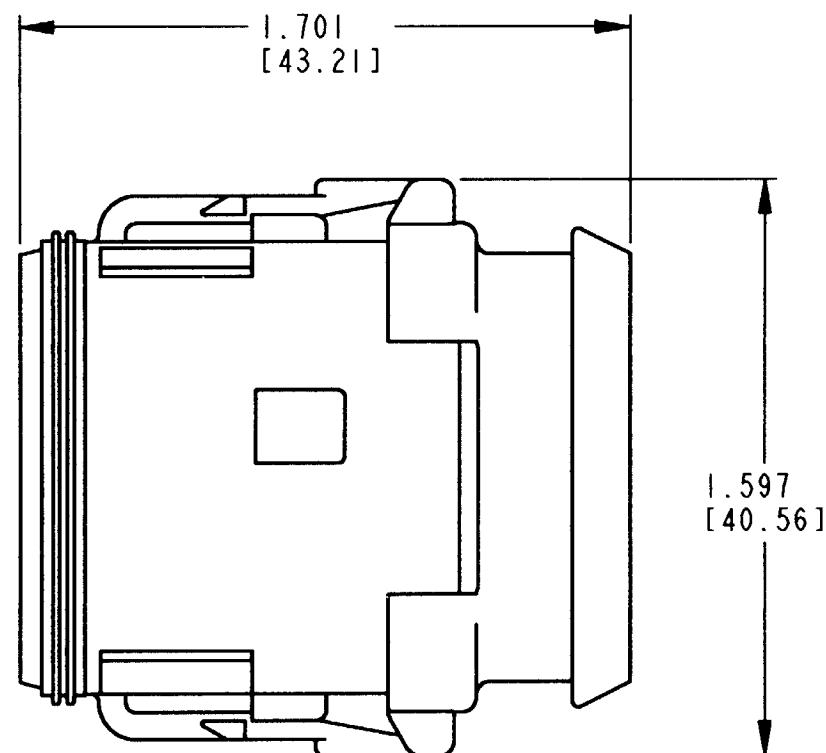
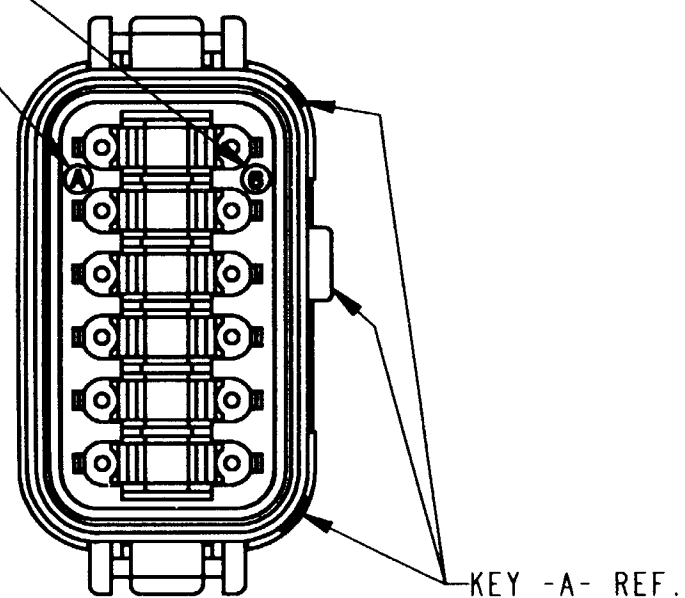

5. MATERIAL: SHELL: PLASTIC; GROMMET: RUBBER.

4. THIS PLUG MATES WITH DT04-12P*-**** RECEPTACLE.
(* = A,B,C,D KEY ARRANGEMENT; **** = ALL MODIFICATIONS).
CONSULT FACTORY FOR ALL MODIFICATIONS.

3. FOR CONTACTS AND WIRE PERFORMANCE AND APPLICATION CHARACTERISTICS,
SEE ENVELOPE DRAWINGS 0425-015-0000 AND 0425-017-0000.

2. DIMENSIONS ARE $\pm .025$ [.64] UNLESS OTHERWISE SPECIFIED.

NOTES: 1. ALL DIMENSIONS ARE INCHES [MILLIMETERS].

CONTACT SIZE	MIN. INSUL O.D.	MAX. INSUL O.D.	WIRE RANGE [mm ²] REF. ONLY
16	.053 [1.35]	.120 [3.05]	14-20 AWG [2.0-0.5]

SIGNATURE & DATE	
DR	A. MALAGON 03AUG06
CHK	[Signature] 11/5/09
PE	R. MESSING 11/21/09
APPD	[Signature] 11-4-09
SCALE	NONE
WT	

12 WAY PLUG
W/ SHRINK BOOT CAP
& REDUCED WIRE SEAL
-CE13 MOD.
DT SERIES

ENVELOPE

EP	MATL. CODE
3850 INDUSTRIAL AVE. HEMET, CA 92545	
DEUTSCH INDUSTRIAL	
B DT06-12S*-CE13	
DWG SIZE	CODE 11139 SHEET 1 OF 2

REV
B DT06-12S*-CE13

REVISIONS			
SYM	DESCRIPTION	DATE	APPROVED
NC	NEW RELEASE PER E.O. P19336	8/15/06	R.D.R.
A	REVISED PER E.O. P19925	7/30/08	R.D.R.
B	REVISED PER E.O. P20338	11-5-09	RDR

PART NO: DT06-12SA-CE13
KEY ARR -A-
COLOR: GRAY

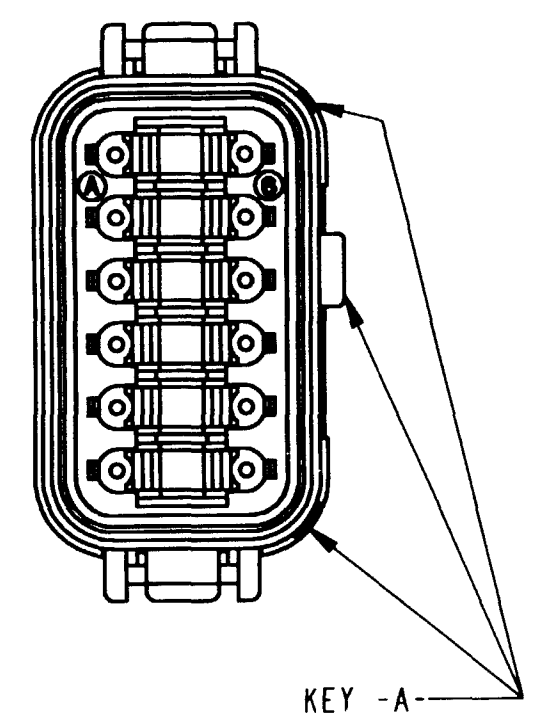

PART NO: DT06-12SB-CE13
KEY ARR -B-
COLOR: BLACK

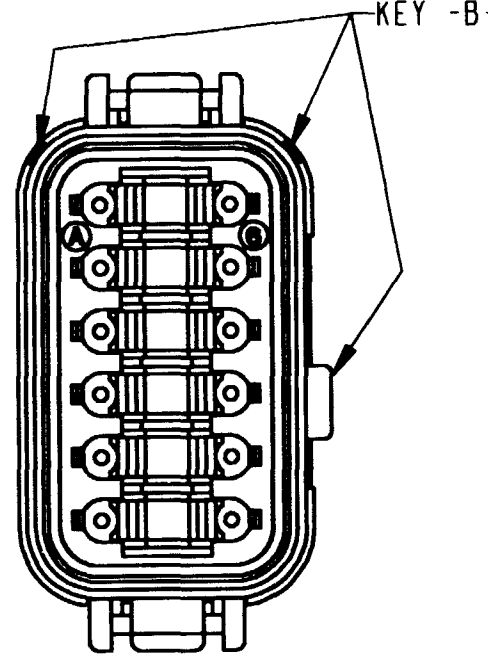

PART NO: DT06-12SC-CE13
KEY ARR -C-
COLOR: GREEN

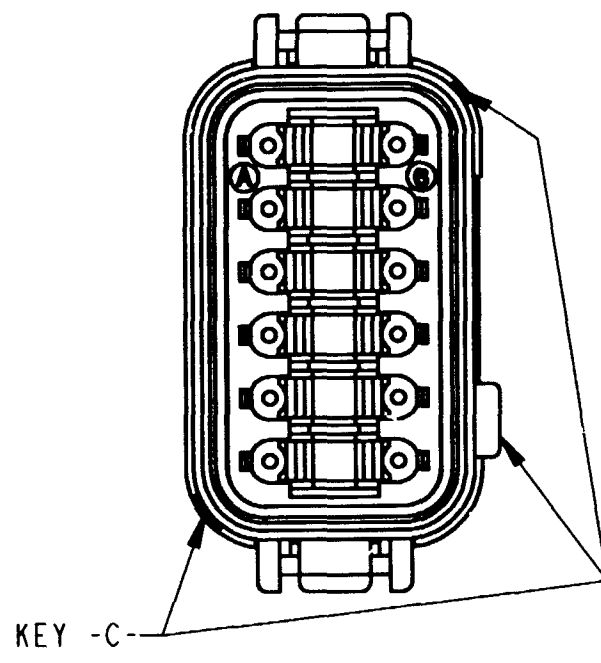

PART NO: DT06-12SD-CE13
KEY ARR -D-
COLOR: BROWN

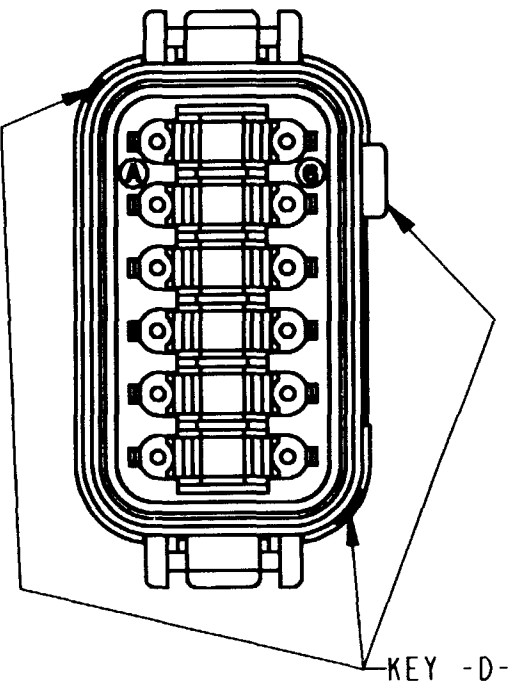

NOTES: SEE SHEET 1.

SIGNATURE & DATE	
DR	A. MALAGON 03AUG06
CHK	S. Brand 11/5/09
PE	H. Wenzel 11/21/09
APPD	S. Brand 11-4-09
SCALE	NONE WT

12 WAY PLUG
W/ SHRINK BOOT CAP
-CE13 MOD.
DT SERIES

ENVELOPE

EP	MATL. CODE
3850 INDUSTRIAL AVE. HEMET, CA 92545	
DEUTSCH INDUSTRIAL	
B	DT06-12S*-CE13
DWG SIZE	CODE 11139 SHEET 2 OF 2