

REVISIONS					
P	LTR	DESCRIPTION	DATE	DWN	APVD
	C1	REVISED PER ECR-10-019377	04OCT2010	HMR	TM
	D	REVISED PER ECR-14-000206	26DEC2013	PV	RB

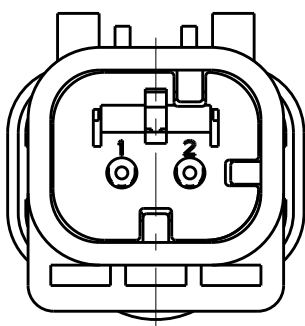

1871412-2
SCALE 2:1

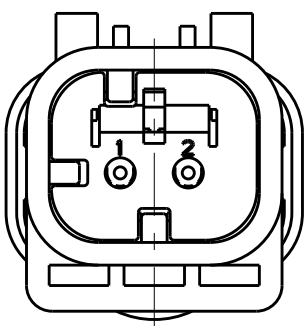

1871412-3
SCALE 2:1

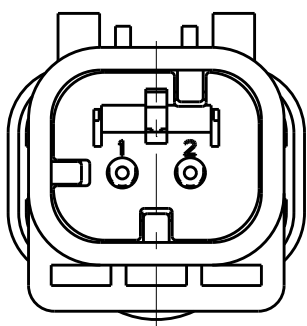

1871412-4
SCALE 2:1

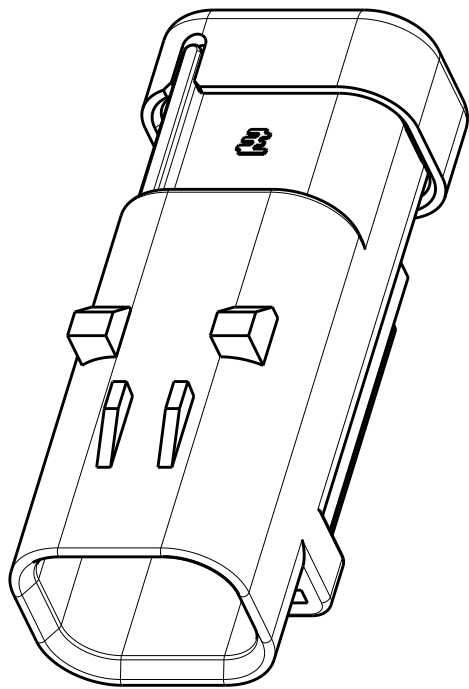

SCALE 2:1

- 1 MATERIAL: 15% GLASS FILLED THERMOPLASTIC
COLOR: BLACK
- 2 MATERIAL: 15% GLASS FILLED THERMOPLASTIC
COLOR: (SEE TABLE)
- 3 MATERIAL: SILICONE
COLOR: LIGHT GRAY
4. WIRE INSULATION RANGE: Ø1.3~Ø2.3

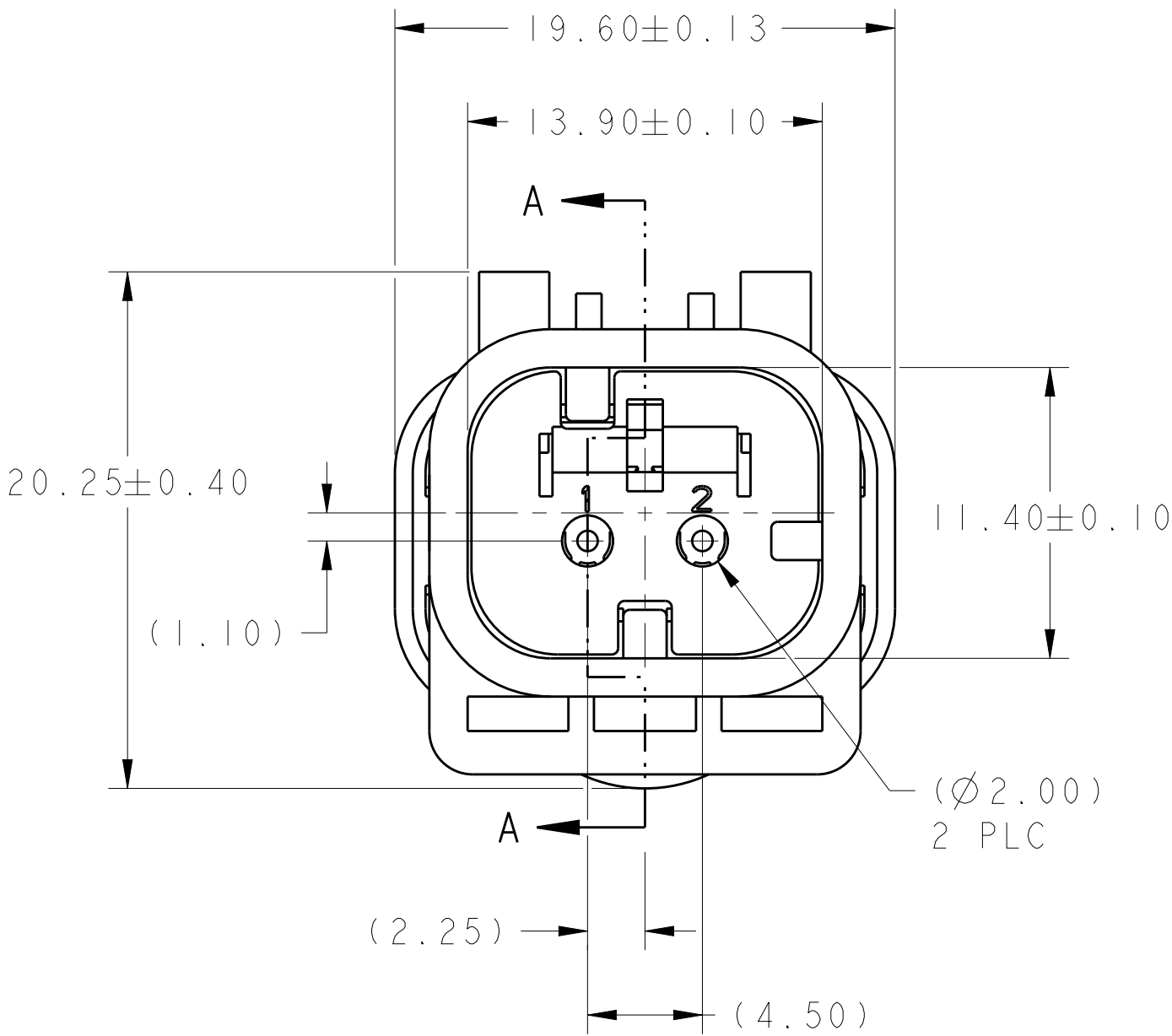

1871412-1 SHOWN

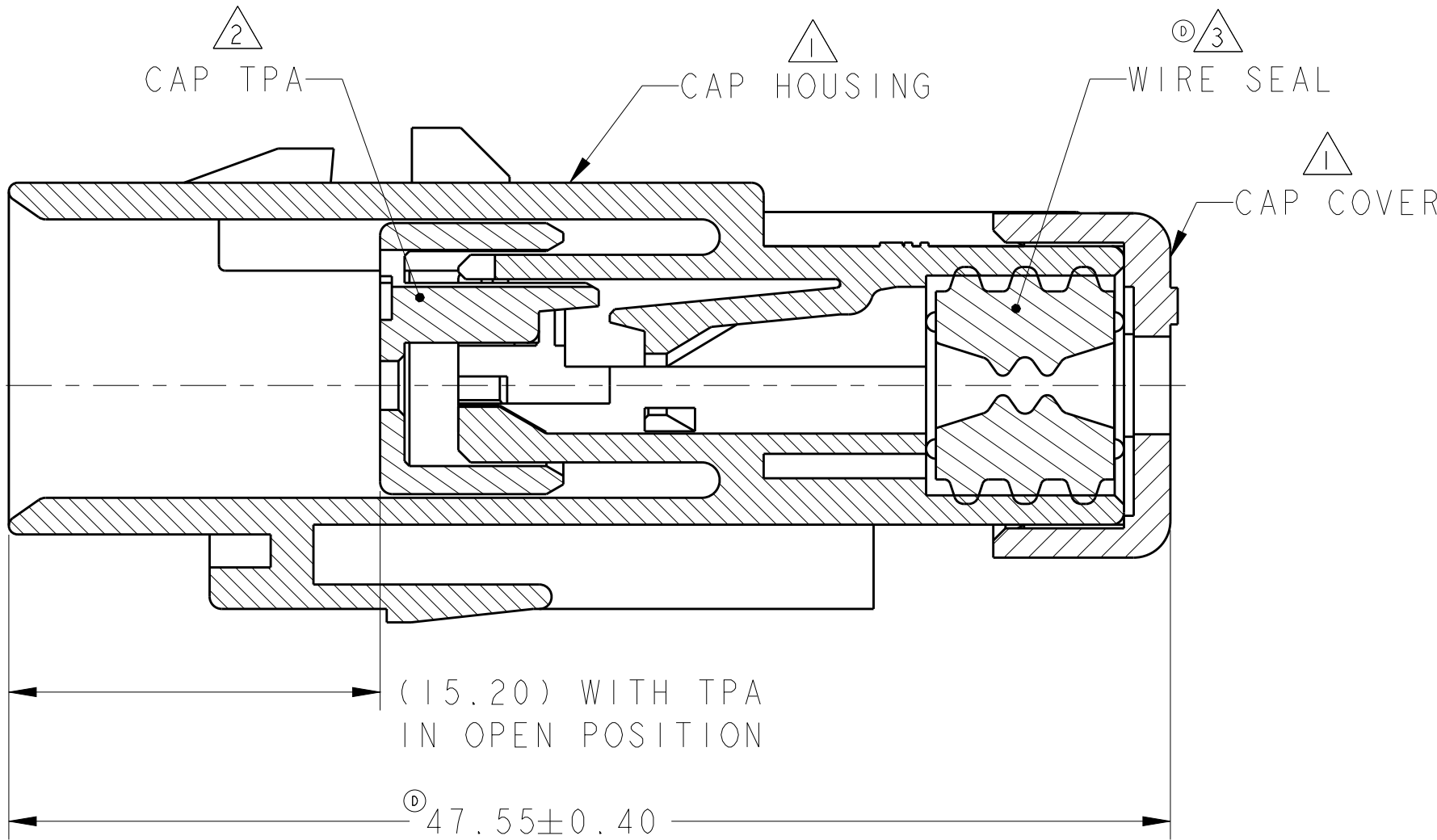

A-A

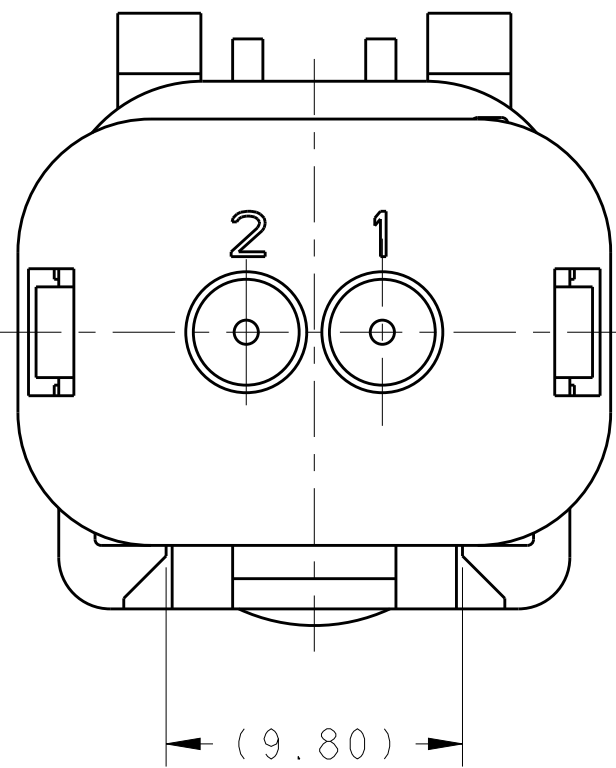

GREEN	1871412-4
YELLOW	1871412-3
GRAY	1871412-2
RED	1871412-1
TPA COLOR	PART NUMBER

THIS DRAWING IS A CONTROLLED DOCUMENT.		DWN S. KUBOTA 02NOV2006	TE Connectivity			
DIMENSIONS:		CHK J. AKASAKA 06NOV2006				
TOLERANCES UNLESS OTHERWISE SPECIFIED:		APVD J. AKASAKA 06NOV2006	NAME CAP ASSY, 2 POS. BRACKET REVERSE TYPE SMALL WIRE SIZE AMPSEAL 16			
mm		PRODUCT SPEC 108-2184	SIZE A2			
0 PLC ± 1 PLC ± 2 PLC ± 3 PLC ± 4 PLC ± ANGLES ± FINISH ±		APPLICATION SPEC 114-13065	CAGE CODE -			
MATERIAL -		WEIGHT -	DRAWING NO C-1871412			
		Customer Drawing	RESTRICTED TO -			
			SCALE 4:1 SHEET 1 OF 1 REV D			