

SECTION A-A
CONDUCTOR WINGS

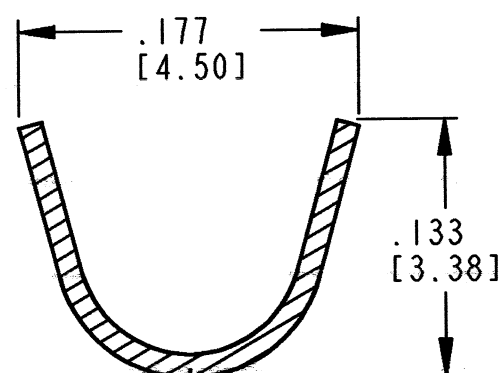

SECTION B-B
INSULATION WINGS

CONTACT ORIENTATION
ON REEL FOR AUTO
CRIMP MACHINE

7. MATERIAL: COPPER ALLOY.
6. WHEN ** = 77 PLATING IS TIN.
** = 88 PLATING IS SELECTIVE GOLD.
5. SEE 0425-015-0000 FOR CONTACT PERFORMANCE AND WIRE APPLICATION CHARACTERISTICS.
4. THIS CONTACT MAY BE CRIMPED WITH DCT16-02-00 AUTOMATIC DIE, DTT-16-00 OR DTT-16-01 HAND TOOLS. SEE DRAWING 0425-203-0000 FOR APPLICABLE WIRE SIZE, INSULATION DIAMETER RANGE, AND CRIMPING INFORMATION.
3. ONE REEL CONTAINS APPROXIMATELY 4000 CONTACTS.
2. DIMENSIONAL TOLERANCE: $\pm .025$ [0.63].
1. DIMENSIONS ARE IN INCHES [mm].

NOTES: UNLESS OTHERWISE SPECIFIED

REV
C 1060-16-09 **

REVISIONS			
SYM	DESCRIPTION	DATE	APPROVED
NC	NEW RELEASE PER E.O. P16164	07-30-99	R.D.R.
A	REVISED PER E.O. P16997	12-08-00	R.D.R.
B	REVISED PER E.O. P19555	7-11-07	R.D.R.
C	REVISED PER E.O. P20396	6-25-10	RDR

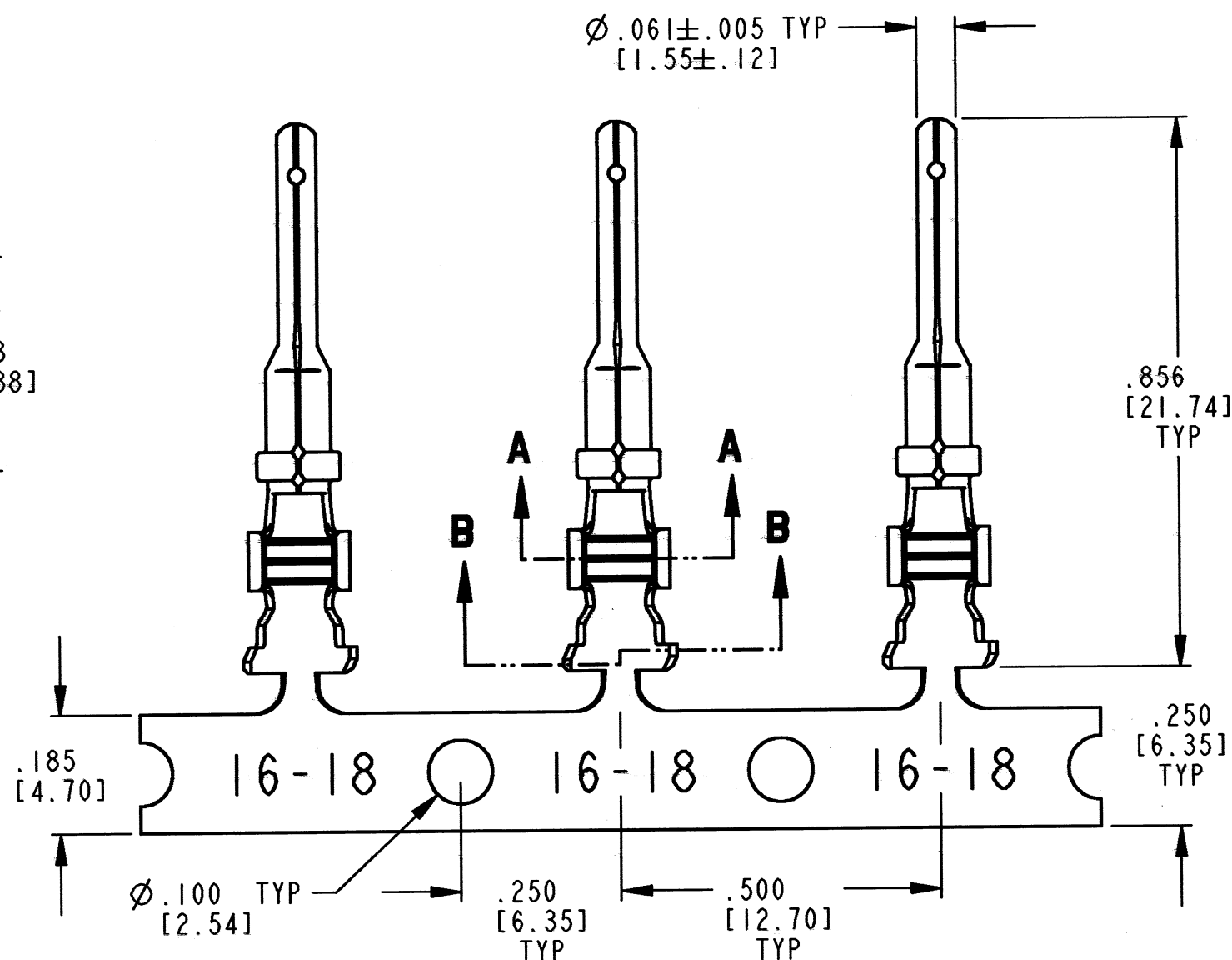

SIGNATURE & DATE	
DR	J. APOSTOL 03DEC2009
CHK	D. Meyer 6/25/10
PE	D. Meyer 6/25/10
APPD	R. Reed 6-25-10
SCALE	NONE
WT	

STAMPED CONTACT
PIN
SIZE 16

ENVELOPE

EP	MATL. CODE
3850 INDUSTRIAL AVE. HEMET, CA 92545	
B	1060-16-09 **
DWG SIZE	CODE 11139 SHEET 1 OF 1