

REVISIONS					
P.	LTR	DESCRIPTION	DATE	DWN	APVD
H3		REVISED PER ECO-12-009257	29MAY2012	DD	DS
H4		REVISED PER ECO-13-019430	10DEC2013	DD	DS
H5		REVISED PER ECO-15-000177	30JAN2015	DD	DS
H6		REVISED PER ECO-15-003872	25MAR2015	DD	DS

- 1 ACCEPTS #4 SELF TAPPING THREAD FORMING SCREW OR METRIC EQUIVALENT TO BE DRIVEN AT 0.6-0.8N-m
- 2 DATE CODE IN THIS LOCATION USING 5 DIGIT CODE
FIRST 2 DIGITS = YEAR, SECOND 2 DIGITS = WEEK
LAST DIGIT = DAY
- 3 HOUSING COLORS ARE MECHANICALLY KEYED TO MATE ONLY WITH IDENTICALLY COLORED PLUG ASSEMBLIES.
- 4 MATERIAL: HEADER HOUSING - GLASS FILLED PBT
PINS - TIN OR GOLD PLATED BRASS
5. HEADER MATES TO PLUG ASSEMBLY 776164 WHICH USES REELED TERMINAL 770520 OR LOOSE PIECE TERMINAL 770854

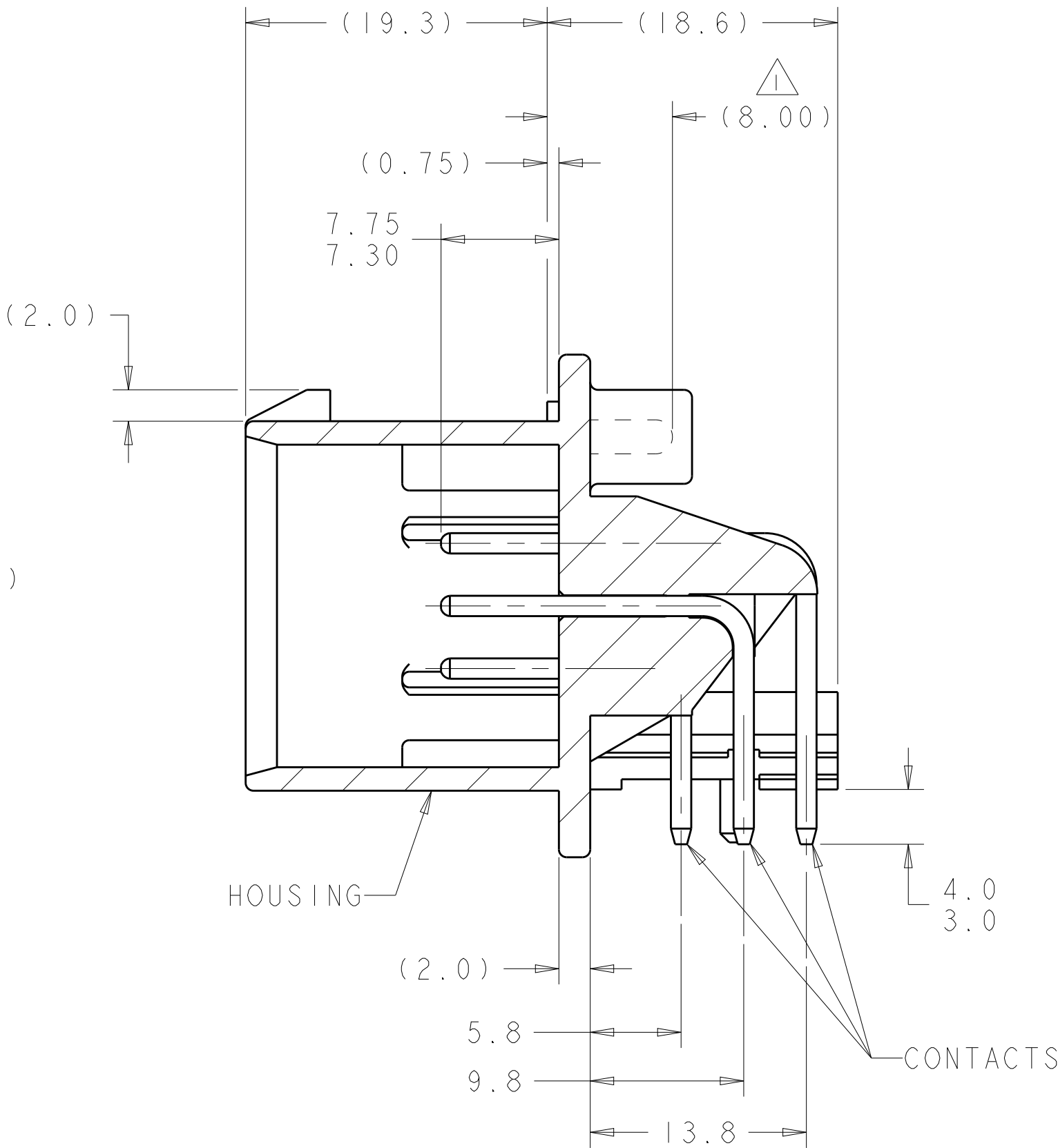

SECTION A-A

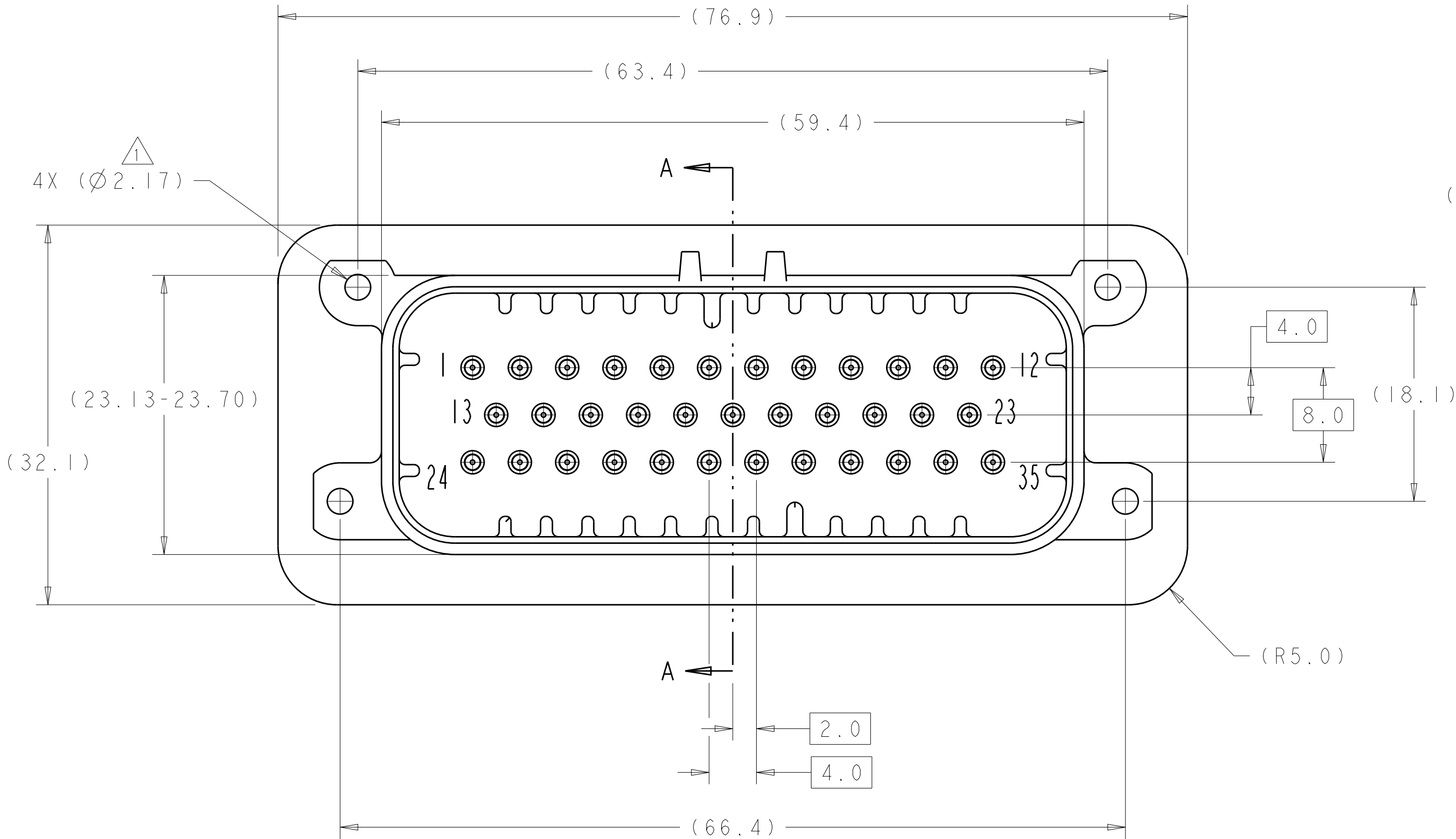
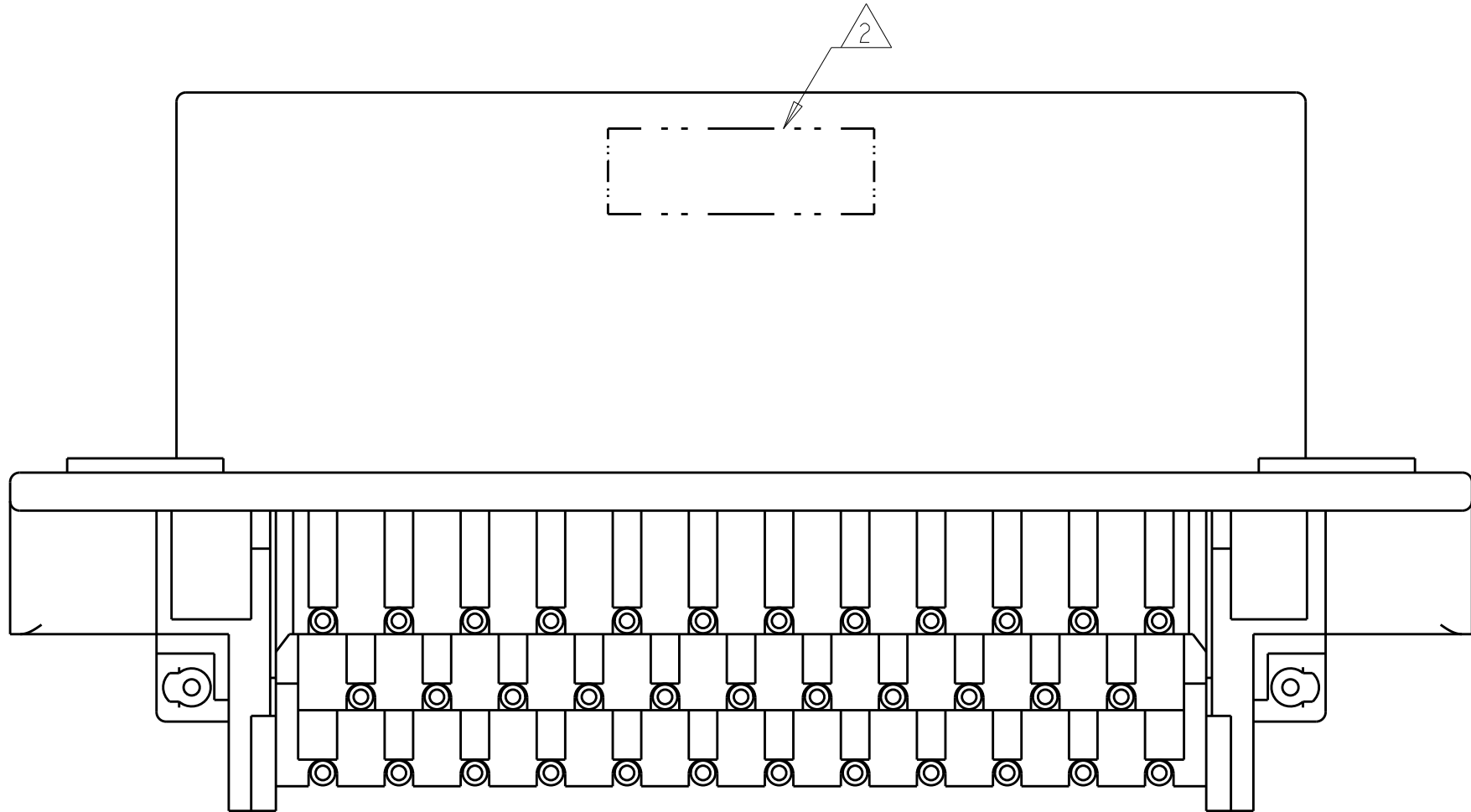

776180-1 & 1-776180-1
KEY LOCATION AS SHOWN

DURAGOLD	ORANGE	1-776180-6
DURAGOLD	BLUE	1-776180-5
DURAGOLD	GRAY	1-776180-4
DURAGOLD	NATURAL (WHITE)	1-776180-2
DURAGOLD	BLACK	1-776180-1
TIN	BLUE	776180-5
TIN	GRAY	776180-4
TIN	NATURAL (WHITE)	776180-2
TIN	BLACK	776180-1
FINISH	HEADER COLOR 3	PART NUMBER

THIS DRAWING IS A CONTROLLED DOCUMENT.			DWN R. VESTAL 31DEC2002	<div><div>TE Connectivity</div><div>NAME HEADER ASSEMBLY, 35 POSITION, RIGHT ANGLE, AMPSEAL</div><div>SIZE A1</div><div>SCALE 4:1</div><div>SHEET 1</div><div>OF 2</div><div>REV H6</div></div>		
DIMENSIONS:			CHK D. CROWE 31DEC2002			
mm			APVD D. CROWE 31DEC2002			
TOLERANCES UNLESS OTHERWISE SPECIFIED:			PRODUCT SPEC 108-1329			
0 PLC ±.2			APPLICATION SPEC 114-16016	RESTRICTED TO		
2 PLC ±.1			WEIGHT	CUSTOMER DRAWING		
3 PLC ±.1						
4 PLC ±.1						
ANGLES ±.1						
FINISH						

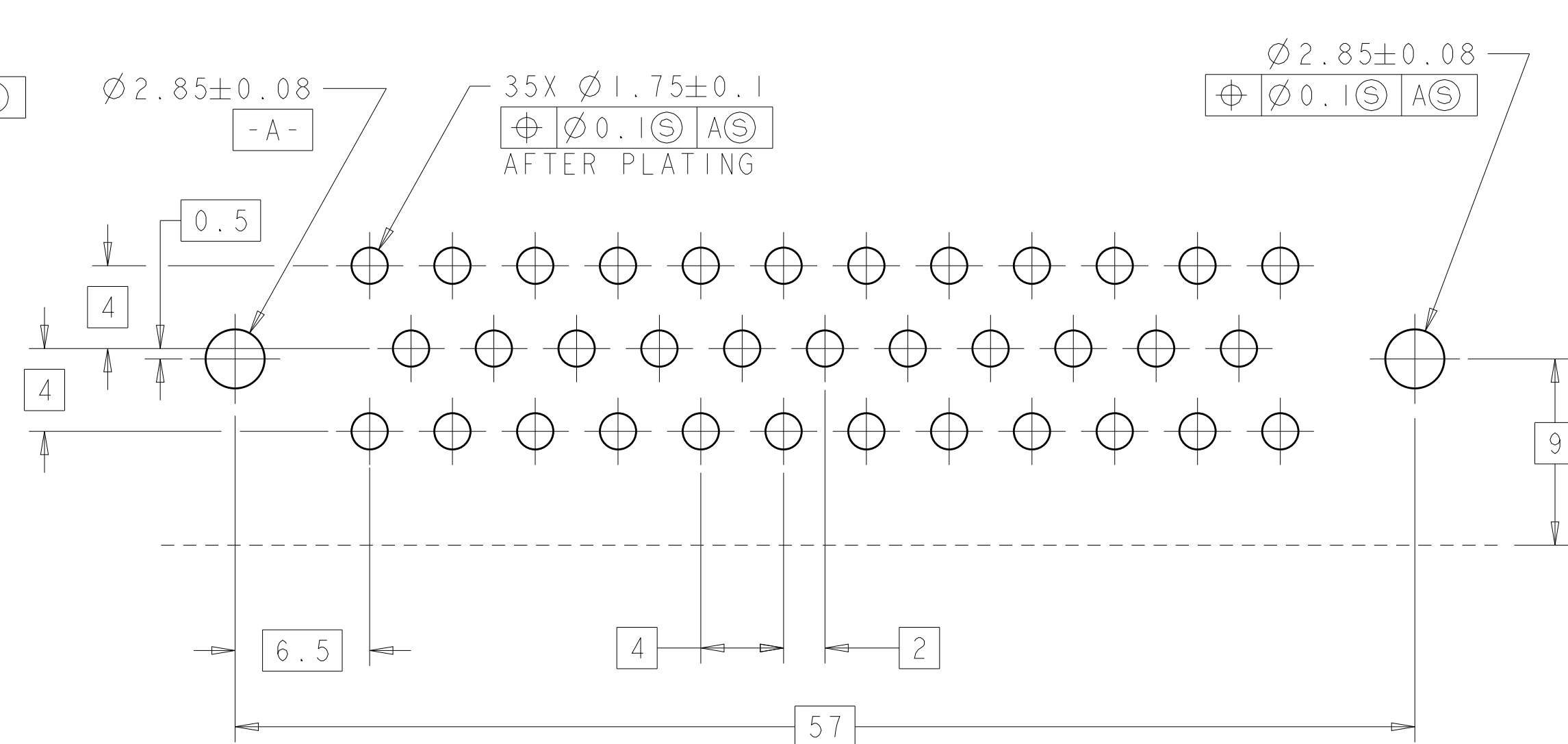

RECOMMENDED P.C. BOARD LAYOUT
FOR 1.57 THICK P.C. BOARD

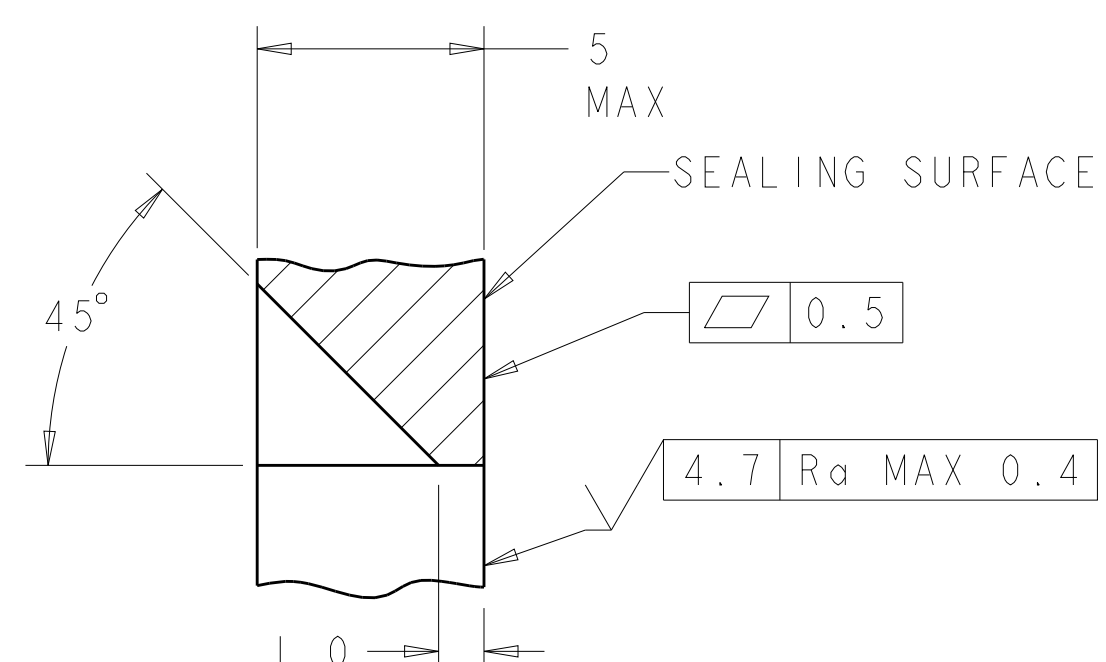

SECTION Z-Z
OPTIONAL CONSTRUCTION IF
THICKNESS IS GREATER THAN 2.0
SCALE 6:1

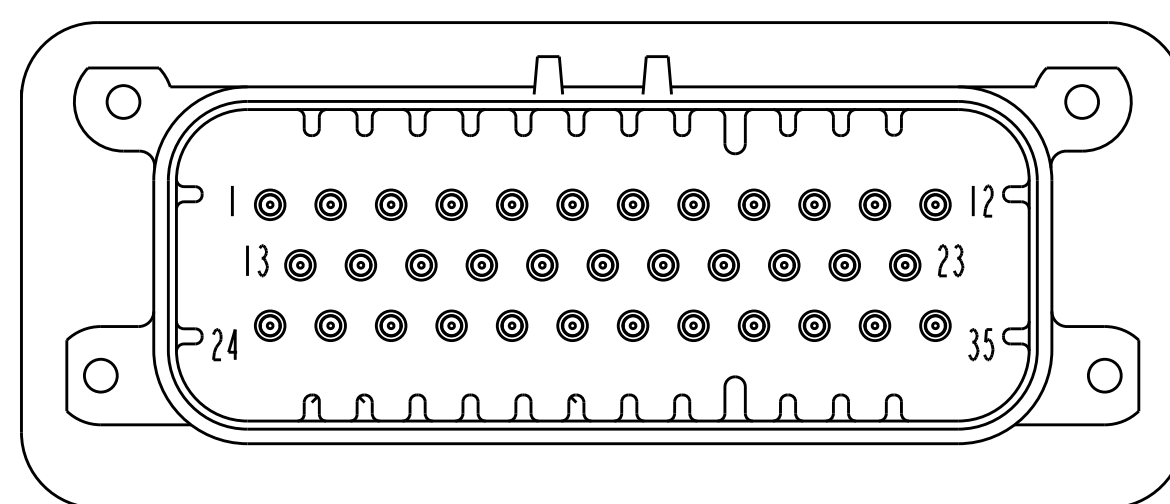

776180-4 & 1-776180-4
KEY LOCATION AS SHOWN
SCALE 2:1

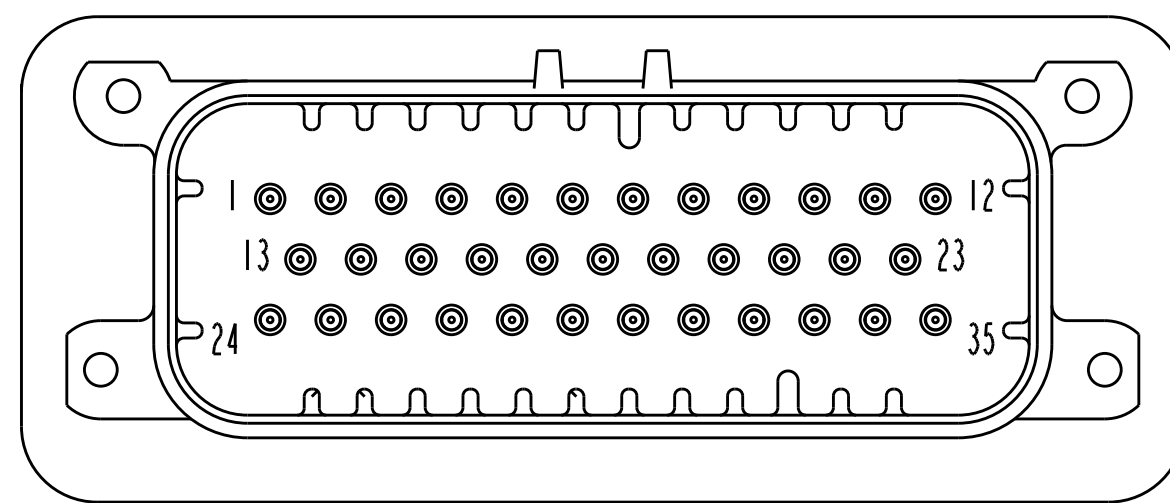

1-776180-6
KEY LOCATION AS SHOWN
SCALE 2:1

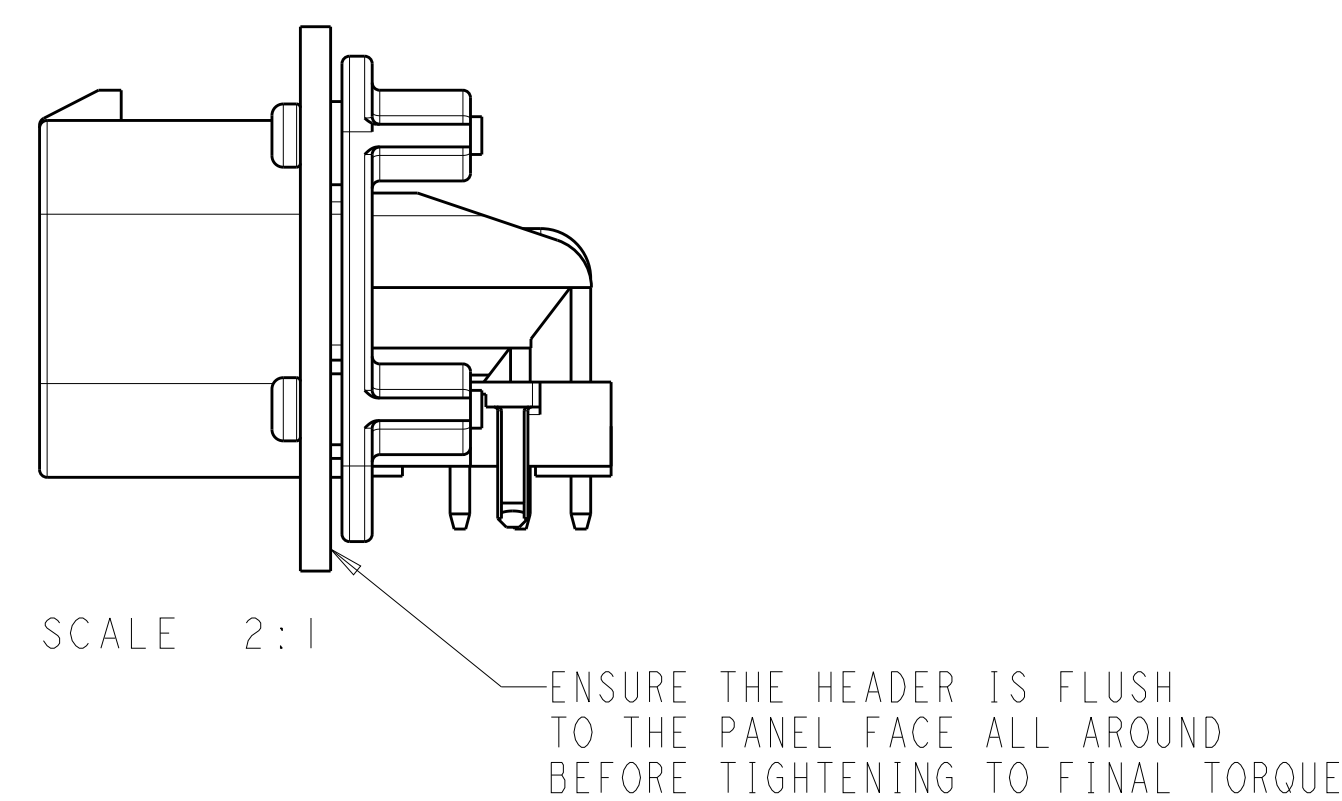
4805 (3/13)