

REV
NC 0513-017-8006

REVISIONS			
SYM	DESCRIPTION	DATE	APPROVED
NC	NEW RELEASE PER E.O. A14816	3-22-85	RDR

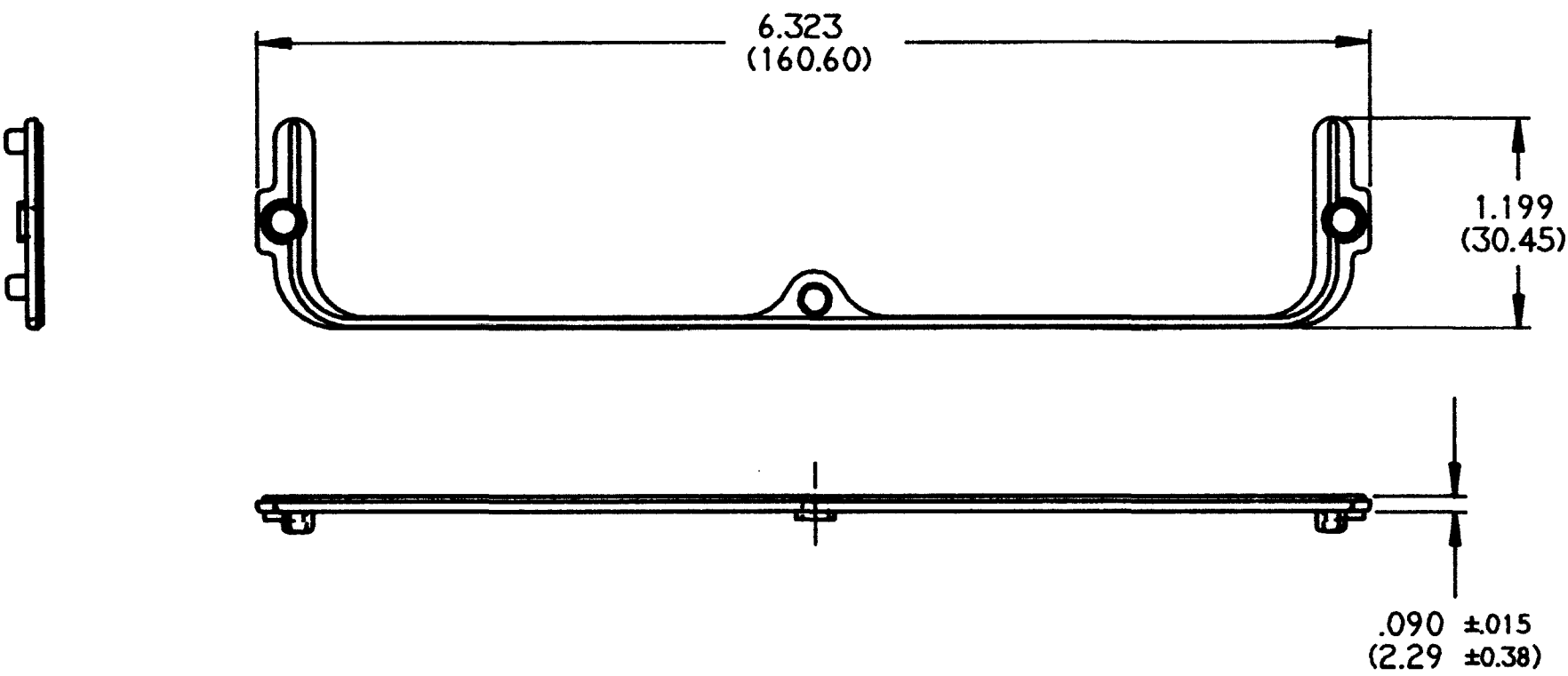

- NOTES:
1. ALL DIMENSIONS ARE INCHES (METRIC).
 2. ALL DIMENSIONS WITHOUT TOLERANCE ARE REFERENCE.
 3. THIS CASTING SEAL IS USED ON DRC23-80P.
 4. MATERIAL : SILICONE RUBBER.

SIGNATURE & DATE	
DR	C. WOODRUFF 27FEB95
CHK	
PE	<i>[Signature]</i>
	3-22-95
APPD	
SCALE	NONE
WT	

SEAL, CASTING
FOR 80 CONT. #20
RECEPTACLE
DRC SERIES.

ENVELOPE

CP	MATL CODE
The Deutsch Company DEUTSCH I.P.D. 37140 INDUSTRIAL AVE. HEMET, CALIF. 92343	
B	0513-017-8006
DWG SIZE	CODE 11139
SHEET 1 OF 1	