

REV	
B	0460-256-12**

REVISIONS			
SYM	DESCRIPTION	DATE	APPROVED
NC	NEW RELEASE PER E.O. A13672	8-27-93	J.A.
A	REVISED PER E.O. A13689	10-29-93	J.A.
B	REVISED & REDRAWN PER E.O. P19437	12-8-06	RDR

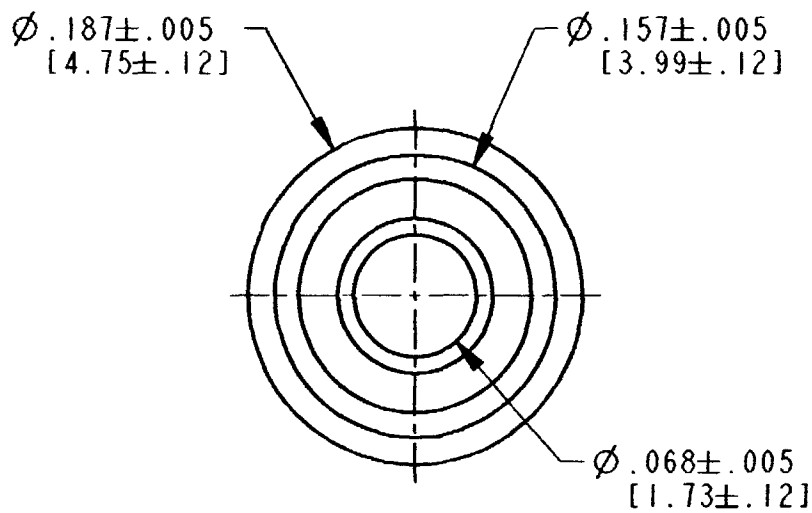
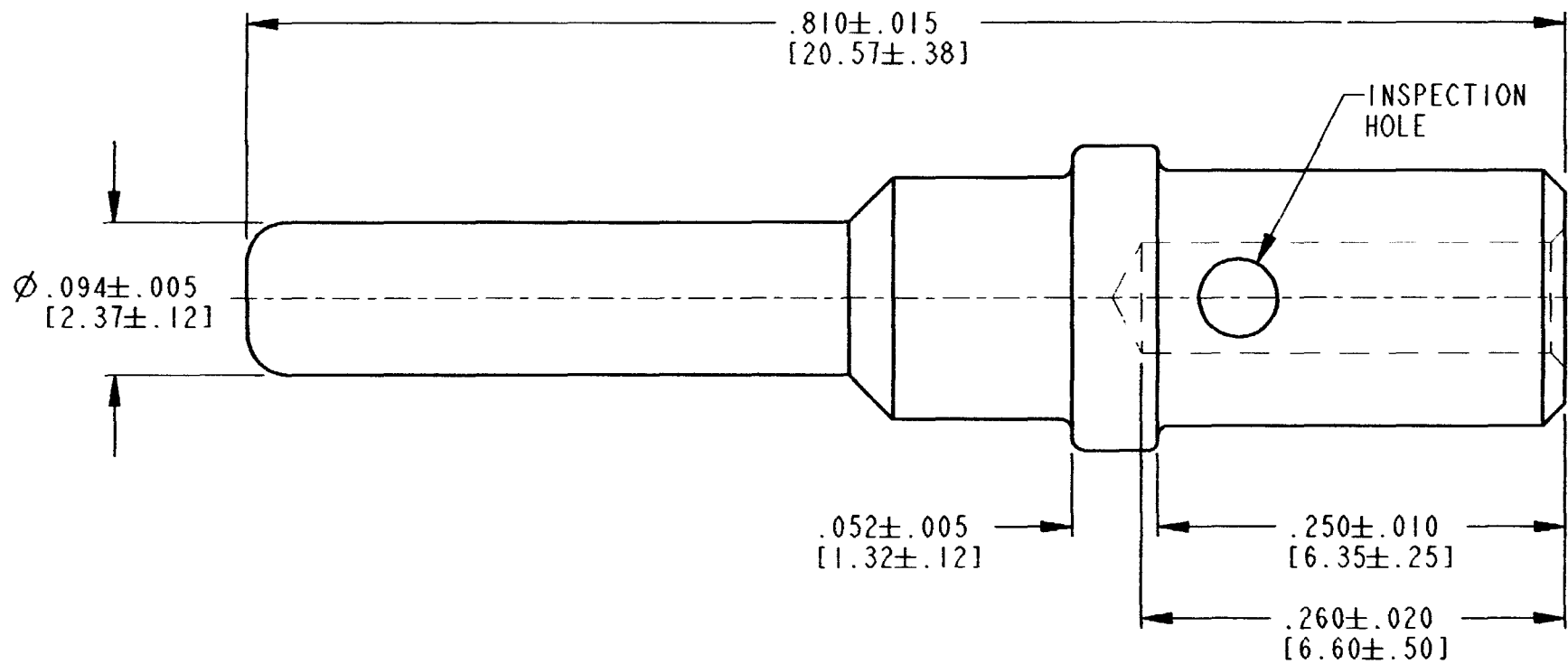

- FOR CONTACT PERFORMANCE AND APPLICATION CHARACTERISTICS SEE DRAWING 0425-015-0000.
- WHEN \*\* = 233: PLATING IS GOLD.
- DIMENSIONS ARE IN INCHES [mm].
- FOR CRIMPING INFORMATION SEE DRAWING 0425-205-0000.

NOTES:

SIGNATURE & DATE	
DR	J. APOSTOL 26 OCT 2006
CHK	R. R. 12/15/06
PE	R. R. 12/15/06
APPD	R. R. 12-18-06
SCALE	NONE
WT	

CONTACT PIN SIZE 12 REDUCED CRIMP BARREL
ENVELOPE

EP	MATL. CODE
The Deutsch Company DEUTSCH I.P.D. 3850 INDUSTRIAL AVE. HEMET, CALIF. 92545	
B	0460-256-12**
DWG SIZE	CODE 11139 SHEET 1 OF 1