

N/C 0421-203-04141

REVISIONS			
SYM	DESCRIPTION	DATE	APPROVED
N/C	NEW RELEASE PER E.O. A 3518.	6/10/85	

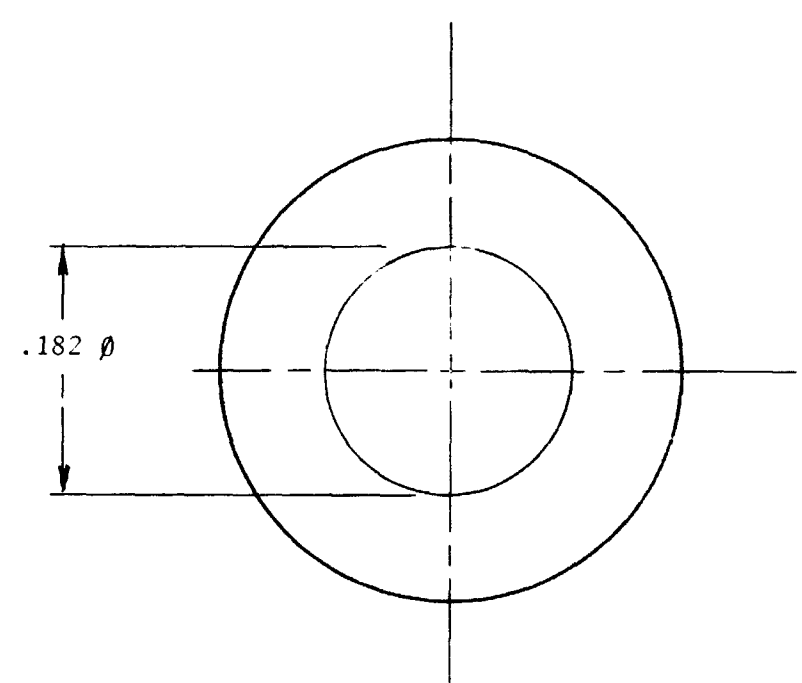
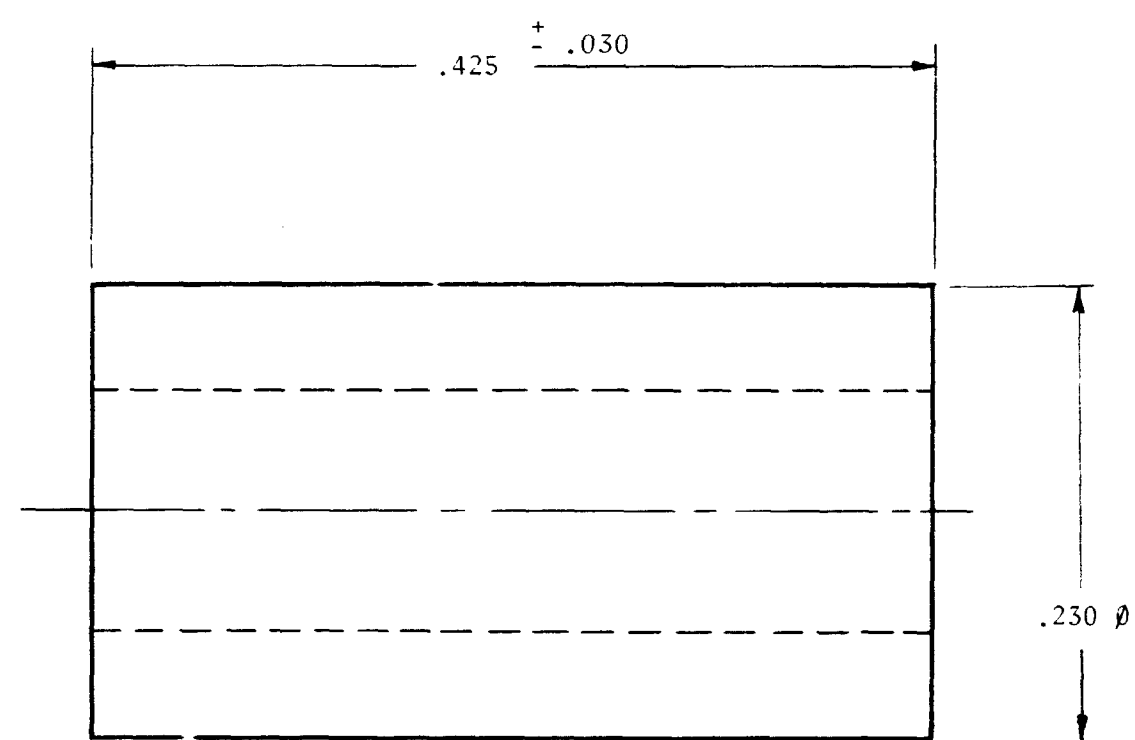

NOTE:

1. MATERIAL: COPPER ALLOY, NICKEL PLATED PER QQ-N-290.
2. CRIMP SLEEVE REDUCER CAN BE USED WITH HD30 AND HD50 SERIES SIZE 4 PIN OR SOCKET CONTACTS.
2. SLEEVE REDUCES CRIMP BARREL TO ACCEPT SIZE 10 OR 8 AWG WIRE.
1. DIMENSIONS ARE IN INCHES UNLESS OTHERWISE SPECIFIED.

SIGNATURE & DATE		REDUCER CRIMP SLEEVE	CP	MATL CODE
DR	J. HOFFMAN 6/7/85.		The Deutsch Company DEUTSCH I.P.O. 37140 INDUSTRIAL AVE HEMET, CALIF 92343	
CHK			B	0421-203-04141
PE	<i>Mehta 6/10/85</i>			
APPD				
SCALE NONE WT		DWG SIZE	CODE 11139	SHEET 1 OF