

Recommended P.C. Board Layout

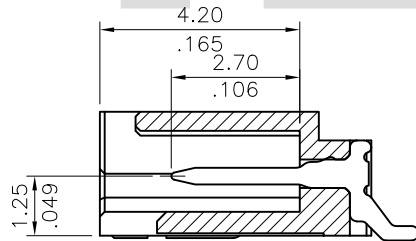
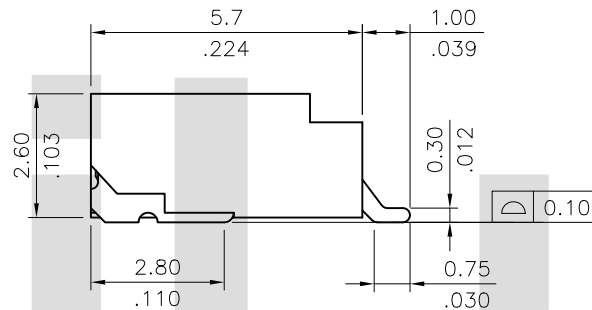
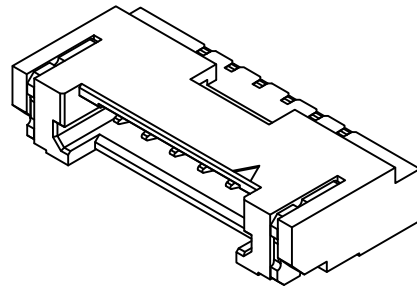

SEC. A-A

NOTE:

Material :

- \* Base : High Temperature plastic UL 94V-0
  - \* Contact : Copper alloy
  - \* Fixed tab : Matte Tin plated over Nickel
- For Lead Free IR Reflow Process

ORDERING CODE

CI46 \*\* M 1 H \* 0 -NH  
 ① ② ③ ④ ⑤ ⑥ ⑦ ⑧

- ① Series No.
- ② Contact: 02 to 20
- ③ M= SMT TYPE HEADER
- ④ Plating :  
1= Matte Tin plated over Nickel
- ⑤ Type : H= Side entry
- ⑥ Packing option:  
R= Tape & Reel Packing
- ⑦ Other option:  
0= Standard
- ⑧ -NH= For Lead Free IR Process and Halogen-Free

DIM. A = 1.25 x NO. OF SPACES  
 DIM. B = DIM. A + 6.20  
 DIM. C = DIM. A + 1.75  
 \* AVAILABLE IN 2 THROUGH 20

Halogen-Free

Lead Free Process

RoHS compliant

④	Enya	10/29-13'	ECNT113100/ECRH113003		DATE	UNIT: mm / inch	TITLE: 1.25mm Pitch WTB SMT R/A TYPE	瀚荃股份有限公司 CviLux Corporation
③	Enya	7/17-13'	ECN13177-0/ECR13013-2	DRAWN BY: Enya	10/30-13'	TOLERANCE UNLESS OTHERWISE SPECIFIED	MATERIAL:	
②	Enya	8/30-12'	ECR12043-2/ECN12209-0	ENGINEER: Sun	11/05-13'	.X ± 0.30/.012 X' ± 1"	FINISH:	DRAWING NO. CI4603SE
①	Hank	5/3-11"	ECN11086	CHECKED BY: Eisley	11/07-13'	.XX ± 0.20/.008 X' ±		PART NO. CI46**M1H*0-NH
SYM	NAME	DATE	REVISIONS	APPROVED BY: Eisley	11/07-13'	.XXX ± 0.10/.004 XX' ±	SCALE 6 / 1	SHEET 1 OF 2



NOTE :

- \* Reel Material : Corrugated Paper
- \* Carrier Material : Black, Polystyrene alloy
- \* Cover Tape Material : Polyester
- \* Cover Tape Peel Strength : 0.1N – 1.3N
- \* Carrier camber is within 1mm in 100mm
- \* All dimensions meet EIA-481-2 & EIA-481-3 requirements.
- \* Quantity : 1700 PCS/Reel

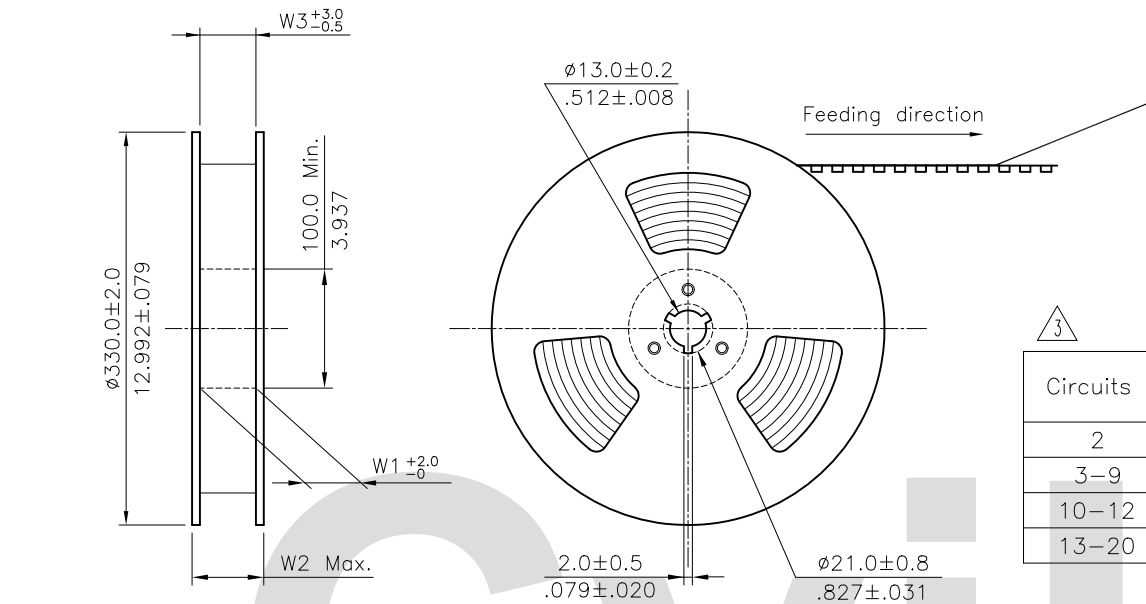

Circuits	Dimension					Packing (Reel/Carton)
	E	F	W1	W2	W3	
2	16.0(.630)	-	16.5(.650)	22.5(.886)	16.5(.650)	11
3-9	24.0(.945)	-	24.5(.965)	30.5(1.201)	24.5(.965)	9
10-12	32.0(1.260)	28.40(1.118)	32.5(1.280)	38.5(1.516)	32.5(1.280)	7
13-20	44.0(1.732)	40.40(1.591)	44.5(1.752)	50.5(1.988)	44.5(1.752)	5

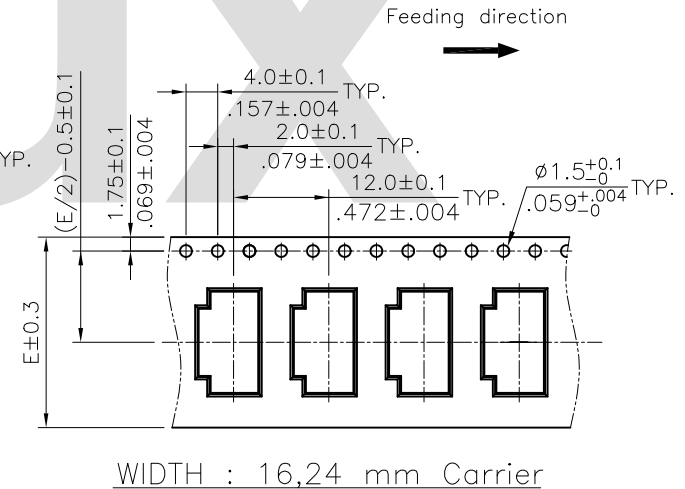
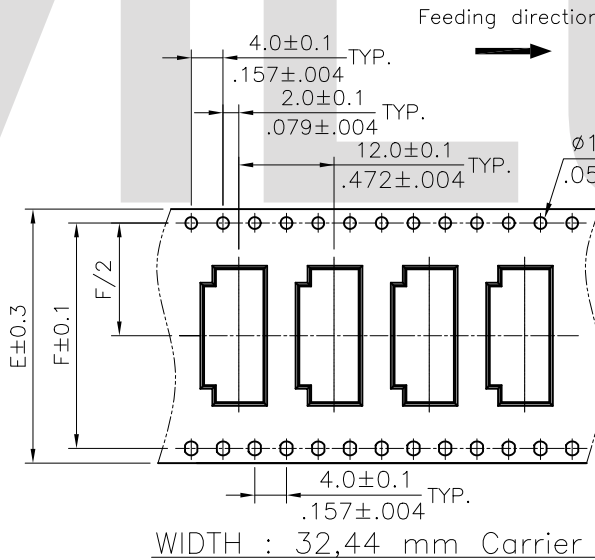
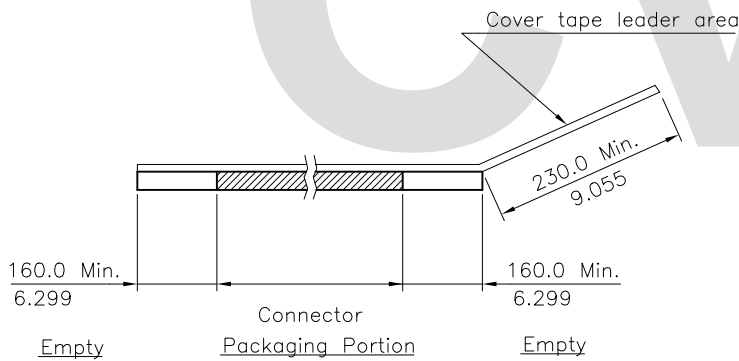

RoHS Compliant

SYM	NAME	DATE	REVISIONS	APPROVED BY:	DATE	UNIT: mm / inch	TITLE: 1.25mm Pitch WTB SMT R/A TYPE	MATERIAL:			FINISH:		
4	Enya	10/29-13'	ECNT113100/ECRH113003					DRAWING NO. <b>CI4603SE</b>			PART NO. <b>CI46**M1H*0-NH</b>		
3	Enya	7/17-13'	ECN13177-0/ECR13013-2	DRAWN BY: Enya	10/30-13'	TOLERANCE UNLESS OTHERWISE SPECIFIED		SCALE			SHEET 2 OF 2		
2	Enya	8/30-12'	ECR12043-2/ECN12209-0	ENGINEER: Sun	11/05-13'	.X ±	X' ± 1'	DRAWING NO. <b>CI4603SE</b>			PART NO. <b>CI46**M1H*0-NH</b>		
1	Hank	5/3-11"	ECN11086	CHECKED BY: Eisley	11/07-13'	.XX ±	.X ±	DRAWING NO. <b>CI4603SE</b>			PART NO. <b>CI46**M1H*0-NH</b>		
				APPROVED BY: Eisley	11/07-13'	.XXX ±	.XX ±	DRAWING NO. <b>CI4603SE</b>			PART NO. <b>CI46**M1H*0-NH</b>		

CVILUX CORP  
2013.11.25  
ISSUED

瀚荃股份有限公司  
CviLux Corporation