

# Ordering Code:

$\frac{CI35}{①} \frac{04}{②} \frac{P}{③} \frac{1}{④} \frac{V}{⑤} \frac{00}{⑥}$

- ① Series No.
- ② No. of Circuits:
- ③ P= Pin header
- ④ Plating: 1= 3.05 $\mu$ m(120 $\mu$ "") Min. Tin over 0.76 $\mu$ m(30 $\mu$ "") Nickel
- ⑤ Type:V= Straight
- ⑥ Other option: 00= Standard

Material:

\* Insulation: Nylon 66 UL 94V-0  
Color Nature

\* Contact: Brass

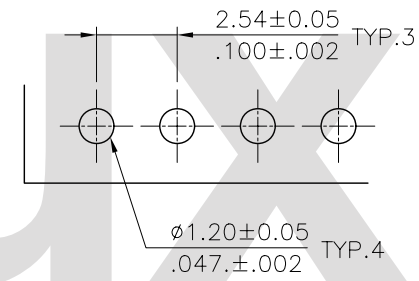
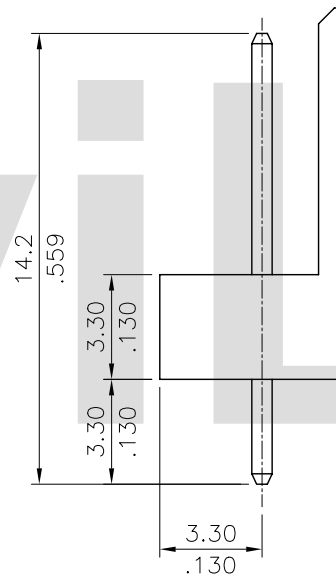
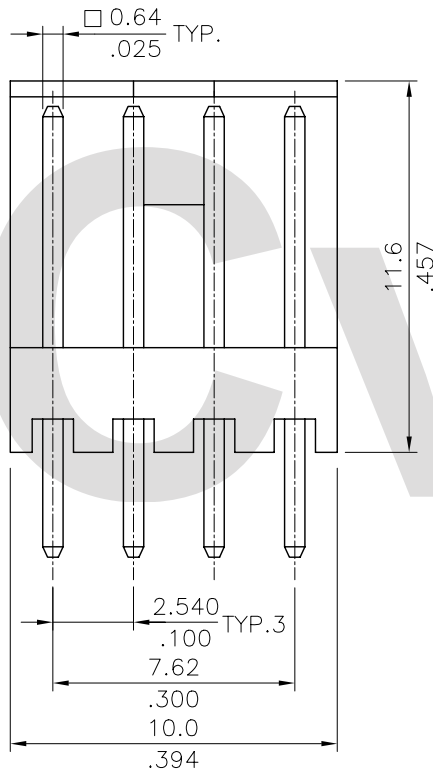
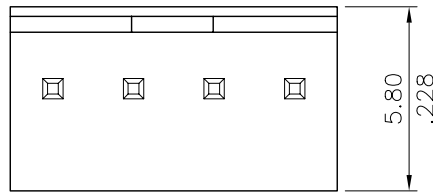

Recommended P.C. Board Layout

RoHS Compliant

④						DATE	UNIT: mm / inch	TITLE: 2.54MM(.100") STRAIGHT PHEADER	 瀚荃股份有限公司 CviLux Corporation			
③			DRAWN BY:		Bill	8/20-07'	TOLERANCE UNLESS OTHERWISE SPECIFIED					
②			ENGINEER:		Eisley	8/20-07'	.X ± 0.30 / .012	.X' ± 1"				
①	Bill	08/16'07	CHECKED BY:		David	8/20-07'	.XX ± 0.20 / .008	.X' ±				
SYM	NAME	DATE	REVISIONS	APPROVED BY:	Alex	8/20-07'	.XXX ± 0.10 / .004	.XX' ±	DRAWING NO.	CI3502SD	PART NO.	CI3504P1V00
								FINISH:	SCALE	4 / 1	SHEET	1 OF 1