

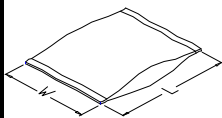

SERIES OR P/N	CIRCUITS	PACKING METHOD CODE	INNER PACKING NO.	INNER PACKING SIZE (CM)			INNER PACKING QTY	INSIDE CARTON NO.	INSIDE CARTON SIZE (CM)			PCS / INSIDE CARTON	CARTON NO.	CARTON SIZE (CM)			PCS / CARTON	G.W REF. (KG)
				L/D	W	H			L	W	H			L	W	H		
CH3101*H***	1	C	PACK-PBC058-C	25.0	16.0	0.012	5000	PACK-PTC069/70-C/H	32.00	25.00	6.00	20000	PACK-CTC002-C/H	34.5	26.0	25.3	80000	
CH3102*H***	2	C	PACK-PBC058-C	25.0	16.0	0.012	2000	PACK-PTC069/70-C/H	32.00	25.00	6.00	8000	PACK-CTC002-C/H	34.5	26.0	25.3	32000	
CH3103*H***	3	C	PACK-PBC058-C	25.0	16.0	0.012	2000	PACK-PTC069/70-C/H	32.00	25.00	6.00	8000	PACK-CTC002-C/H	34.5	26.0	25.3	32000	
CH3104*H***	4	C	PACK-PBC058-C	25.0	16.0	0.012	2000	PACK-PTC069/70-C/H	32.00	25.00	6.00	8000	PACK-CTC002-C/H	34.5	26.0	25.3	32000	
CH3105*H***	5	C	PACK-PBC058-C	25.0	16.0	0.012	1000	PACK-PTC069/70-C/H	32.00	25.00	6.00	2000	PACK-CTC002-C/H	34.5	26.0	25.3	8000	
CH3106*H***	6	C	PACK-PBC058-C	25.0	16.0	0.012	1000	PACK-PTC069/70-C/H	32.00	25.00	6.00	2000	PACK-CTC002-C/H	34.5	26.0	25.3	8000	
CH3107*H***	7	C	PACK-PBC058-C	25.0	16.0	0.012	1000	PACK-PTC069/70-C/H	32.00	25.00	6.00	2000	PACK-CTC002-C/H	34.5	26.0	25.3	8000	
CH3108*H***	8	C	PACK-PBC058-C	25.0	16.0	0.012	1000	PACK-PTC069/70-C/H	32.00	25.00	6.00	2000	PACK-CTC002-C/H	34.5	26.0	25.3	8000	
CH3109*H***	9	C	PACK-PBC058-C	25.0	16.0	0.012	1000	PACK-PTC069/70-C/H	32.00	25.00	6.00	2000	PACK-CTC002-C/H	34.5	26.0	25.3	8000	
CH3110*H***	10	C	PACK-PBC058-C	25.0	16.0	0.012	500	PACK-PTC069/70-C/H	32.00	25.00	6.00	1000	PACK-CTC002-C/H	34.5	26.0	25.3	4000	
CH3111*H***	11	C	PACK-PBC058-C	25.0	16.0	0.012	500	PACK-PTC069/70-C/H	32.00	25.00	6.00	1000	PACK-CTC002-C/H	34.5	26.0	25.3	4000	
CH3112*H***	12	C	PACK-PBC058-C	25.0	16.0	0.012	500	PACK-PTC069/70-C/H	32.00	25.00	6.00	1000	PACK-CTC002-C/H	34.5	26.0	25.3	4000	
CH3113*H***	13	C	PACK-PBC058-C	25.0	16.0	0.012	500	PACK-PTC069/70-C/H	32.00	25.00	6.00	1000	PACK-CTC002-C/H	34.5	26.0	25.3	4000	
CH3114*H***	14	C	PACK-PBC058-C	25.0	16.0	0.012	500	PACK-PTC069/70-C/H	32.00	25.00	6.00	1000	PACK-CTC002-C/H	34.5	26.0	25.3	4000	
CH3115*H***	15	C	PACK-PBC058-C	25.0	16.0	0.012	500	PACK-PTC069/70-C/H	32.00	25.00	6.00	1000	PACK-CTC002-C/H	34.5	26.0	25.3	4000	
CH3116*H***	16	C	PACK-PBC058-C	25.0	16.0	0.012	500	PACK-PTC069/70-C/H	32.00	25.00	6.00	1000	PACK-CTC002-C/H	34.5	26.0	25.3	4000	
CH3117*H***	17	C	PACK-PBC058-C	25.0	16.0	0.012	500	PACK-PTC069/70-C/H	32.00	25.00	6.00	1000	PACK-CTC002-C/H	34.5	26.0	25.3	4000	
CH3118*H***	18	C	PACK-PBC058-C	25.0	16.0	0.012	500	PACK-PTC069/70-C/H	32.00	25.00	6.00	1000	PACK-CTC002-C/H	34.5	26.0	25.3	4000	
CH3119*H***	19	C	PACK-PBC058-C	25.0	16.0	0.012	500	PACK-PTC069/70-C/H	32.00	25.00	6.00	1000	PACK-CTC002-C/H	34.5	26.0	25.3	4000	
CH3120*H***	20	C	PACK-PBC058-C	25.0	16.0	0.012	500	PACK-PTC069/70-C/H	32.00	25.00	6.00	1000	PACK-CTC002-C/H	34.5	26.0	25.3	4000	
CH3122*H***	22	C	PACK-PBC058-C	25.0	16.0	0.012	500	PACK-PTC069/70-C/H	32.00	25.00	6.00	1000	PACK-CTC002-C/H	34.5	26.0	25.3	4000	
CH3123*H***	23	C	PACK-PBC058-C	25.0	16.0	0.012	250	PACK-PTC069/70-C/H	32.00	25.00	6.00	500	PACK-CTC002-C/H	34.5	26.0	25.3	2000	
CH3124*H***	24	C	PACK-PBC058-C	25.0	16.0	0.012	250	PACK-PTC069/70-C/H	32.00	25.00	6.00	500	PACK-CTC002-C/H	34.5	26.0	25.3	2000	
CH3125*H***	25	C	PACK-PBC058-C	25.0	16.0	0.012	250	PACK-PTC069/70-C/H	32.00	25.00	6.00	500	PACK-CTC002-C/H	34.5	26.0	25.3	2000	
CH3126*H***	26	C	PACK-PBC058-C	25.0	16.0	0.012	250	PACK-PTC069/70-C/H	32.00	25.00	6.00	500	PACK-CTC002-C/H	34.5	26.0	25.3	2000	
CH3127*H***	27	C	PACK-PBC058-C	25.0	16.0	0.012	250	PACK-PTC069/70-C/H	32.00	25.00	6.00	500	PACK-CTC002-C/H	34.5	26.0	25.3	2000	
CH3130*H***	30	C	PACK-PBC058-C	25.0	16.0	0.012	250	PACK-PTC069/70-C/H	32.00	25.00	6.00	500	PACK-CTC002-C/H	34.5	26.0	25.3	2000	
CH3132*H***	32	C	PACK-PBC058-C	25.0	16.0	0.012	250	PACK-PTC069/70-C/H	32.00	25.00	6.00	500	PACK-CTC002-C/H	34.5	26.0	25.3	2000	
CH3136*H***	36	C	PACK-PBC058-C	25.0	16.0	0.012	250	PACK-PTC069/70-C/H	32.00	25.00	6.00	500	PACK-CTC002-C/H	34.5	26.0	25.3	2000	

PACKING METHOD (包裝方式) :

1 PVC BAG (塑膠袋)
SIZE = L * W



2 TUBE (塑膠管)
SIZE = L * W * H

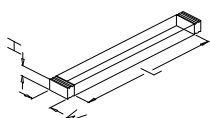

3 PVC TRAY (塑膠盒)
SIZE = L * W * H

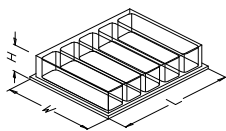

4 REEL (紙盤)
SIZE = D * W

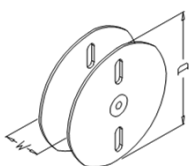

5 BOX (內紙盒)
SIZE = L * W * H

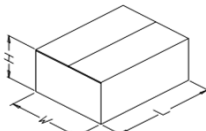

6 INSIDE CARTON (內箱)
SIZE = L * W * H

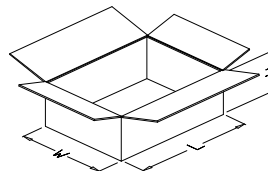

7 OUTSIDE CARTON (外箱)
SIZE = L * W * H

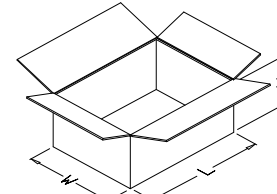

PACKING METHOD CODE (包裝方式代碼) :

- A = 1 → 7
- B = 2 → 7
- C = 1+3 → 7
- D = 4 → 7
- E = 5 → 7
- F = 1 → 6 → 7
- G = 2 → 6 → 7
- H = 3 → 6 → 7



瀚荃股份有限公司
CviLux Corporation
PACKING STANDARD

製訂日期: 2014/11/06

Table with columns: SERIES OR P/N, CIRCUITS, PACKING METHOD CODE, INNER PACKING NO., INNER PACKING SIZE (CM), INNER PACKING Q'TY, INSIDE CARTON NO., INSIDE CARTON SIZE (CM), PCS / INSIDE CARTON, CARTON NO., CARTON SIZE (CM), PCS / CARTON, G.W REF. (KG). Rows include CH3137*H***, CH3138*H***, CH3139*H***, CH3140*H***.

注: 以下為非標準品料號包裝:

CH31***H*PD、CH31***H*KB、CH31***H*A5、CH31***H*15、CH31***H*D2、CH31***H*KE、CH31***H*H0、CH31***H*L0、CH31***H*B8、CH31***H*01、CH31***H*02/03/04、CH31***H*12、CH31***H*35
CH31***H*14、CH31***H*KD、CH31***H*PA、CH31***H*PC、CH31***H*A0、CH31***H*M0、CH31***H*B0、CH31***H*16、CH31***H*GA、CH31***H*A3、CH31***H*27、CH31***H*KA、
CH31***H*A4、CH31***H*15、
CH31***H*LA、CH31***H*P2、CH31***H*G0、CH31***H*PF、CH31***H*F2、CH31***H*FA、CH31***H*B9、CH31***H*13、CH31***H*16、CH31***H*B5、CH31***H*BB、CH31***H*A2、CH31***H*B4。
CH31***H*PE、CH31***H*K0、CH31***H*K1、CH31***H*K2、CH31***H*KC、CH31***H*P8、CH31***H*17、CH31***H*18、CH31***H*19、CH31***H*20、CH31***H*21、CH31***H*22、CH31***H*BA。
CH31***H*24、CH31***H*25、CH31***H*A2、CH31***H*29、CH31***H*BC、CH31***H*31、CH31***H*32、CH31***H*23、CH31***H*D0、CH31***H*A1、CH31***H*AA、CH31***H*AB、CH31***H*B2。
CH31***H*A4、CH31***H*M1、CH31***H*M2、CH31H31***H*V3、CH31***H*KF、CH31***H*58、CH31***H*44、CH31***H*45、CH31***H*40、CH31***H*41、CH31***H*RA、CH31***H*RB、CH31***H*ZA、
CH31***H*J6、CH31***H*KH、CH31***H*RD、CH31***H*ZA、CH31***H*95、CH31***H*07、CH31***H*30、CH31***H*80、CH31***H*10、CH31***H*42、CH31***H*64、CH31***H*R6/R5、CH31***H*R2、CH31***H*33
CH31***H*46/47/48、CH31***H*PM、CH31***H*36、CH31***H*FB、CH31***H*WB、CH31***H*JC/JD、CH31***H*P3、CH31***H*BD、CH31***H*PG、CH31***H*WA-NH-LF、CH31***H*16-NH

依以上相同PIN數包裝量包裝。(包裝時,先放海綿墊→放產品→再放海綿墊)

Large empty table grid for additional product specifications.

PACKING METHOD (包裝方式):

1 PVC BAG (塑膠袋) SIZE = L * W

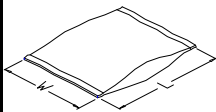

2 TUBE (塑膠管) SIZE = L * W * H

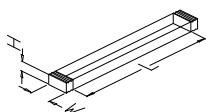

3 PVC TRAY (塑膠盒) SIZE = L * W * H

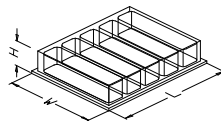

4 REEL (紙盤) SIZE = D * W

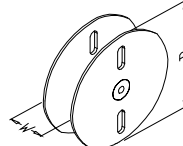

5 BOX (內紙盒) SIZE = L * W * H

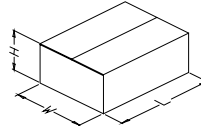

6 INSIDE CARTON (內箱) SIZE = L * W * H

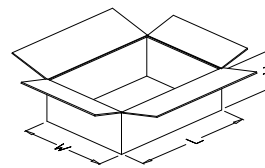

7 OUTSIDE CARTON (外箱) SIZE = L * W * H

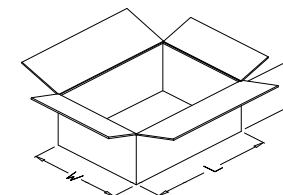

PACKING METHOD CODE (包裝方式代碼):

- A = 1 → 7
□ B = 2 → 7
■ C = 1 + 3 → 7
□ D = 4 → 7
□ E = 5 → 7
■ F = 1 → 6 → 7
□ G = 2 → 6 → 7
□ H = 3 → 6 → 7

文件履歷表

文件編號	CI15H317				
文件名稱	PACKING STANDARD				
內容變更敘述					
版本	因內包裝增加海棉墊,變更包裝數量				發行日期
34	簽呈編號 : XQMS021400103				2014.11.11
核准	Jackal	審核	Mavis	製表	伍曉紅
版本					發行日期
核准		審核		製表	
版本					發行日期
核准		審核		製表	
版本					發行日期
核准		審核		製表	
版本					發行日期
核准		審核		製表	
版本					發行日期
核准		審核		製表	
版本					發行日期
核准		審核		製表	
版本					發行日期
核准		審核		製表	