

瀚荃股份有限公司
CviLux Corporation
PACKING STANDARD

SERIES OR P/N	CIRCUITS	PACKING METHOD CODE	INNER PACKING NO.	INNER PACKING SIZE (CM)			INNER PACKING QTY	INSIDE CARTON NO.	INSIDE CARTON SIZE (CM)			PCS / INSIDE CARTON	CARTON NO.	CARTON SIZE (CM)			PCS / CARTON	G.W REF. (KG)
				L/D	W	H			L	W	H			L	W	H		
CH0104*M*00-0P	4	D	PACK-CRCA138-C	-	1.60	-	800	PACK-RLCA01-C	-	1.75	-	800	PACK-CTC034-C	35.0	35.0	32.0	8800	0.00
CH0110*M*00-0P	10	D	PACK-CRCB**C	-	2.40	-	800	PACK-RLCB01-C	-	2.55	-	800	PACK-CTC034-C	35.0	35.0	32.0	7200	5.98
CH0111*M*00-0P	11	D	PACK-CRCB**C	-	2.40	-	800	PACK-RLCB01-C	-	2.55	-	800	PACK-CTC034-C	35.0	35.0	32.0	7200	5.99
CH0112*M*00-0P	12	D	PACK-CRCB115-C	-	2.40	-	800	PACK-RLCB01-C	-	2.55	-	800	PACK-CTC034-C	35.0	35.0	32.0	7200	6.01
CH0113*M*00-0P	13	D	PACK-CRCC**C	-	3.20	-	800	PACK-RLCC01-C	-	3.35	-	800	PACK-CTC034-C	35.0	35.0	32.0	5600	5.66
CH0114*M*00-0P	14	D	PACK-CRCC**C	-	3.20	-	800	PACK-RLCC01-C	-	3.35	-	800	PACK-CTC034-C	35.0	35.0	32.0	5600	3.71
CH0115*M*00-0P	15	D	PACK-CRCC70-C	-	3.20	-	800	PACK-RLCC01-C	-	3.35	-	800	PACK-CTC034-C	35.0	35.0	32.0	5600	5.80
CH0116*M*00-0P	16	D	PACK-CRCD**C	-	4.40	-	800	PACK-RLCD01-C	-	5.55	-	800	PACK-CTC034-C	35.0	35.0	32.0	4000	4.82
CH0117*M*00-0P	17	D	PACK-CRCD**C	-	4.40	-	800	PACK-RLCD01-C	-	5.55	-	800	PACK-CTC034-C	35.0	35.0	32.0	4000	4.86
CH0118*M*00-0P	18	D	PACK-CRCD**C	-	4.40	-	800	PACK-RLCD01-C	-	5.55	-	800	PACK-CTC034-C	35.0	35.0	32.0	4000	4.91
CH0119*M*00-0P	19	D	PACK-CRCD**C	-	4.40	-	800	PACK-RLCD01-C	-	5.55	-	800	PACK-CTC034-C	35.0	35.0	32.0	4000	4.95
CH0120*M*00-0P	20	D	PACK-CRCD**C	-	4.40	-	800	PACK-RLCD01-C	-	5.55	-	800	PACK-CTC034-C	35.0	35.0	32.0	4000	5.00
CH0121*M*00-0P	21	D	PACK-CRCD**C	-	4.40	-	800	PACK-RLCD01-C	-	5.55	-	800	PACK-CTC034-C	35.0	35.0	32.0	4000	5.05
CH0122*M*00-0P	22	D	PACK-CRCD**C	-	4.40	-	800	PACK-RLCD01-C	-	5.55	-	800	PACK-CTC034-C	35.0	35.0	32.0	4000	5.09
CH0123*M*00-0P	23	D	PACK-CRCD**C	-	4.40	-	800	PACK-RLCD01-C	-	5.55	-	800	PACK-CTC034-C	35.0	35.0	32.0	4000	5.13
CH0124*M*00-0P	24	D	PACK-CRCD**C	-	4.40	-	800	PACK-RLCD01-C	-	5.55	-	800	PACK-CTC034-C	35.0	35.0	32.0	4000	5.19
CH0125*M*00-0P	25	D	PACK-CRCD**C	-	4.40	-	800	PACK-RLCD01-C	-	5.55	-	800	PACK-CTC034-C	35.0	35.0	32.0	4000	5.23
CH0126*M*00-0P	26	D	PACK-CRCE**C	-	5.60	-	800	PACK-RLCE01-C	-	5.75	-	800	PACK-CTC034-C	35.0	35.0	32.0	3200	4.55
CH0127*M*00-0P	27	D	PACK-CRCE**C	-	5.60	-	800	PACK-RLCE01-C	-	5.75	-	800	PACK-CTC034-C	35.0	35.0	32.0	3200	4.59
CH0128*M*00-0P	28	D	PACK-CRCE64-C	-	5.60	-	800	PACK-RLCE01-C	-	5.75	-	800	PACK-CTC034-C	35.0	35.0	32.0	3200	4.63
CH0129*M*00-0P	29	D	PACK-CRCE**C	-	5.60	-	800	PACK-RLCE01-C	-	5.75	-	800	PACK-CTC034-C	35.0	35.0	32.0	3200	4.66
CH0130*M*00-0P	30	D	PACK-CRCE**C	-	5.60	-	800	PACK-RLCE01-C	-	5.75	-	800	PACK-CTC034-C	35.0	35.0	32.0	3200	4.70
CH0131*M*00-0P	31	D	PACK-CRCE**C	-	5.60	-	800	PACK-RLCE01-C	-	5.75	-	800	PACK-CTC034-C	35.0	35.0	32.0	3200	4.74
CH0132*M*00-0P	32	D	PACK-CRCE**C	-	5.60	-	800	PACK-RLCE01-C	-	5.75	-	800	PACK-CTC034-C	35.0	35.0	32.0	3200	4.78
CH0133*M*00-0P	33	D	PACK-CRCE**C	-	5.60	-	800	PACK-RLCE01-C	-	5.75	-	800	PACK-CTC034-C	35.0	35.0	32.0	3200	4.82
CH0134*M*00-0P	34	D	PACK-CRCE**C	-	5.60	-	800	PACK-RLCE01-C	-	5.75	-	800	PACK-CTC034-C	35.0	35.0	32.0	3200	4.86
CH0135*M*00-0P	35	D	PACK-CRCF**C	-	7.20	-	800	PACK-RLCF01-C	-	7.35	-	800	PACK-CTC034-C	35.0	35.0	32.0	2400	4.24
CH0136*M*00-0P	36	D	PACK-CRCF**C	-	7.20	-	800	PACK-RLCF01-C	-	7.35	-	800	PACK-CTC034-C	35.0	35.0	32.0	2400	4.26

PACKING METHOD (包裝方式) :

1 PVC BAG (塑膠袋)
SIZE = L * W

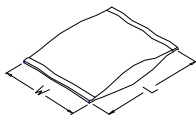

2 TUBE (塑膠管)
SIZE = L * W * H

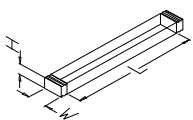

3 PVC TRAY (塑膠盒)
SIZE = L * W * H

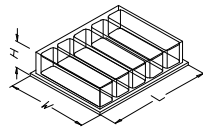

4 REEL (紙盤)
SIZE = D * W

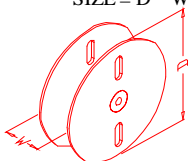

5 BOX (內紙盒)
SIZE = L * W * H

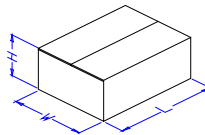

6 INSIDE CARTON (內箱)
SIZE = L * W * H

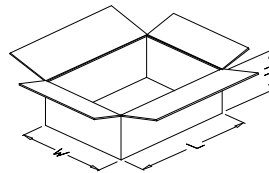

7 OUTSIDE CARTON (外箱)
SIZE = L * W * H

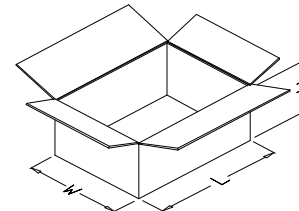

PACKING METHOD CODE (包裝方式代碼) :

- A = 1 → 7
- B = 2 → 7
- C = 3 → 7
- D = (4+1) → 7
- E = 5 → 7
- F = 1 → 6 → 7
- G = 2 → 6 → 7
- H = 3 → 6 → 7

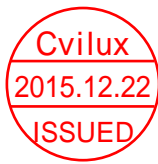

瀚荃股份有限公司
CviLux Corporation
PACKING STANDARD

SERIES OR P/N	CIRCUITS	PACKING METHOD CODE	INNER PACKING NO.	INNER PACKING SIZE (CM)			INNER PACKING QTY	INSIDE CARTON NO.	INSIDE CARTON SIZE (CM)			PCS / INSIDE CARTON	CARTON NO.	CARTON SIZE (CM)			PCS / CARTON	G.W REF. (KG)
				L/D	W	H			L	W	H			L	W	H		
CH0137*M*00-0P	37	D	PACK-CRCF**C	-	7.20	-	800	PACK-RLCF01-C	-	7.35	-	800	PACK-CTC034-C	35.0	35.0	32.0	2400	4.29
CH0138*M*00-0P	38	D	PACK-CRCF**C	-	7.20	-	800	PACK-RLCF01-C	-	7.35	-	800	PACK-CTC034-C	35.0	35.0	32.0	2400	4.32
CH0139*M*00-0P	39	D	PACK-CRCF**C	-	7.20	-	800	PACK-RLCF01-C	-	7.35	-	800	PACK-CTC034-C	35.0	35.0	32.0	2400	4.35
CH0140*M*00-0P	40	D	PACK-CRCF**C	-	7.20	-	800	PACK-RLCF01-C	-	7.35	-	800	PACK-CTC034-C	35.0	35.0	32.0	2400	4.38
CH0141*M*00-0P	41	D	PACK-CRCF**C	-	7.20	-	800	PACK-RLCF01-C	-	7.35	-	800	PACK-CTC034-C	35.0	35.0	32.0	2400	4.41
CH0142*M*00-0P	42	D	PACK-CRCF**C	-	7.20	-	800	PACK-RLCF01-C	-	7.35	-	800	PACK-CTC034-C	35.0	35.0	32.0	2400	4.44
CH0143*M*00-0P	43	D	PACK-CRCF**C	-	7.20	-	800	PACK-RLCF01-C	-	7.35	-	800	PACK-CTC034-C	35.0	35.0	32.0	2400	4.46
CH0144*M*00-0P	44	D	PACK-CRCF02-C	-	7.20	-	800	PACK-RLCF01-C	-	7.35	-	800	PACK-CTC034-C	35.0	35.0	32.0	2400	4.47
CH0145*M*00-0P	45	D	PACK-CRCF**C	-	7.20	-	800	PACK-RLCF01-C	-	7.35	-	800	PACK-CTC034-C	35.0	35.0	32.0	2400	4.52
CH0146*M*00-0P	46	D	PACK-CRCF**C	-	7.20	-	800	PACK-RLCF01-C	-	7.35	-	800	PACK-CTC034-C	35.0	35.0	32.0	2400	4.55
CH0147*M*00-0P	47	D	PACK-CRCG**C	-	8.80	-	800	PACK-RLCG01-C	-	8.95	-	800	PACK-CTC034-C	35.0	35.0	32.0	2400	4.67
CH0148*M*00-0P	48	D	PACK-CRCG**C	-	8.80	-	800	PACK-RLCG01-C	-	8.95	-	800	PACK-CTC034-C	35.0	35.0	32.0	2400	4.70
CH0149*M*00-0P	49	D	PACK-CRCG**C	-	8.80	-	800	PACK-RLCG01-C	-	8.95	-	800	PACK-CTC034-C	35.0	35.0	32.0	2400	4.72
CH0150*M*00-0P	50	D	PACK-CRCG**C	-	8.80	-	800	PACK-RLCG01-C	-	8.95	-	800	PACK-CTC034-C	35.0	35.0	32.0	2400	4.75
注：塑膠盤先用塑膠袋 (PACK-PBC0**C不穿孔) 裝好后再裝入外箱。 外箱中有紙板(PACK-STC016-C)兩塊、隔板(PACK-STC001-C)四個。																		
CH01042M100-RP	4	D	PACK-CRCA83-C	-	16.00	-	800	PACK-RLCA01-C	-	1.75	-	800	PACK-CTC034-C	35.0	35.0	32.0	8800	

PACKING METHOD (包裝方式) :

1 PVC BAG (塑膠袋)
SIZE = L * W

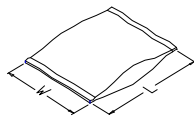

2 TUBE (塑膠管)
SIZE = L * W * H

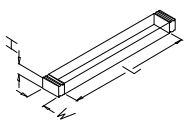

3 PVC TRAY (塑膠盒)
SIZE = L * W * H

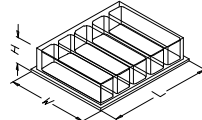

4 REEL (紙盤)
SIZE = D * W

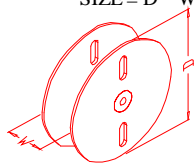

5 BOX (內紙盒)
SIZE = L * W * H

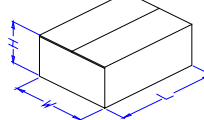

6 INSIDE CARTON (內箱)
SIZE = L * W * H

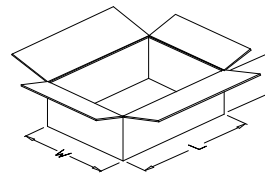

7 OUTSIDE CARTON (外箱)
SIZE = L * W * H

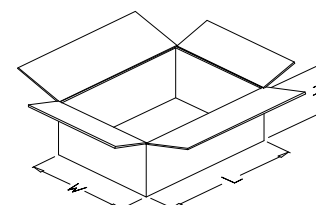

PACKING METHOD CODE (包裝方式代碼) :

- A = 1 → 7
- B = 2 → 7
- C = 3 → 7
- D = (4+1) → 7
- E = 5 → 7
- F = 1 → 6 → 7
- G = 2 → 6 → 7
- H = 3 → 6 → 7

文件履歷表

文件編號	CI15H014				
文件名稱	PACKING STANDARD				
內容變更敘述					
版本	新增 CH0104*M*00-0P 包規				發行日期
7	簽呈編號：ISOXR0181512031				2015.12.22
核准	Jackal	審核	Mavis	製表	周燕妮
版本					發行日期
核准		審核		製表	
版本					發行日期
核准		審核		製表	
版本					發行日期
核准		審核		製表	
版本					發行日期
核准		審核		製表	
版本					發行日期
核准		審核		製表	
版本					發行日期
核准		審核		製表	
版本					發行日期
核准		審核		製表	