

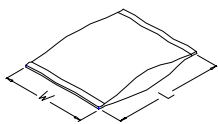

SERIES OR P/N	CIRCUITS	PACKING METHOD CODE	INNER PACKING NO.	INNER PACKING SIZE (CM)			INNER PACKING Q'TY	INSIDE CARTON NO.	INSIDE CARTON SIZE (CM)			PCS / INSIDE CARTON	CARTON NO.	CARTON SIZE (CM)			PCS / CARTON	G.W REF. (KG)
				L/D	W	H			L	W	H			L	W	H		
CH0104*M*00.*0	4	G	PACK-TBC013-C	60.00	0.78	0.96	114	PACK-IBC014-C	60.70	6.00	10.20	6270	PACK-CTC011-C	63.0	15.0	23.0	25080	
CH0105*M*00.*0	5	G	PACK-TBC013-C	60.00	0.78	0.96	91	PACK-IBC014-C	60.70	6.00	10.20	5005	PACK-CTC011-C	63.0	15.0	23.0	20020	
CH0106*M*00.*0	6	G	PACK-TBC013-C	60.00	0.78	0.96	76	PACK-IBC014-C	60.70	6.00	10.20	4180	PACK-CTC011-C	63.0	15.0	23.0	16720	
CH0107*M*00.*0	7	G	PACK-TBC013-C	60.00	0.78	0.96	65	PACK-IBC014-C	60.70	6.00	10.20	3575	PACK-CTC011-C	63.0	15.0	23.0	14300	
CH0108*M*00.*0	8	G	PACK-TBC013-C	60.00	0.78	0.96	57	PACK-IBC014-C	60.70	6.00	10.20	3135	PACK-CTC011-C	63.0	15.0	23.0	12540	
CH0109*M*00.*0	9	G	PACK-TBC013-C	60.00	0.78	0.96	51	PACK-IBC014-C	60.70	6.00	10.20	2805	PACK-CTC011-C	63.0	15.0	23.0	11220	
CH0110*M*00.*0	10	G	PACK-TBC013-C	60.00	0.78	0.96	45	PACK-IBC014-C	60.70	6.00	10.20	2475	PACK-CTC011-C	63.0	15.0	23.0	9900	
CH0111*M*00.*0	11	G	PACK-TBC013-C	60.00	0.78	0.96	41	PACK-IBC014-C	60.70	6.00	10.20	2255	PACK-CTC011-C	63.0	15.0	23.0	9020	
CH0112*M*00.*0	12	G	PACK-TBC013-C	60.00	0.78	0.96	38	PACK-IBC014-C	60.70	6.00	10.20	2090	PACK-CTC011-C	63.0	15.0	23.0	8360	
CH0113*M*00.*0	13	G	PACK-TBC013-C	60.00	0.78	0.96	35	PACK-IBC014-C	60.70	6.00	10.20	1925	PACK-CTC011-C	63.0	15.0	23.0	7700	
CH0114*M*00.*0	14	G	PACK-TBC013-C	60.00	0.78	0.96	32	PACK-IBC014-C	60.70	6.00	10.20	1760	PACK-CTC011-C	63.0	15.0	23.0	7040	
CH0115*M*00.*0	15	G	PACK-TBC013-C	60.00	0.78	0.96	30	PACK-IBC014-C	60.70	6.00	10.20	1650	PACK-CTC011-C	63.0	15.0	23.0	6600	
CH0116*M*00.*0	16	G	PACK-TBC013-C	60.00	0.78	0.96	28	PACK-IBC014-C	60.70	6.00	10.20	1540	PACK-CTC011-C	63.0	15.0	23.0	6160	
CH0117*M*00.*0	17	G	PACK-TBC013-C	60.00	0.78	0.96	27	PACK-IBC014-C	60.70	6.00	10.20	1485	PACK-CTC011-C	63.0	15.0	23.0	5940	
CH0118*M*00.*0	18	G	PACK-TBC013-C	60.00	0.78	0.96	25	PACK-IBC014-C	60.70	6.00	10.20	1375	PACK-CTC011-C	63.0	15.0	23.0	5500	
CH0119*M*00.*0	19	G	PACK-TBC013-C	60.00	0.78	0.96	24	PACK-IBC014-C	60.70	6.00	10.20	1320	PACK-CTC011-C	63.0	15.0	23.0	5280	
CH0120*M*00.*0	20	G	PACK-TBC013-C	60.00	0.78	0.96	22	PACK-IBC014-C	60.70	6.00	10.20	1210	PACK-CTC011-C	63.0	15.0	23.0	4840	
CH0121*M*00.*0	21	G	PACK-TBC013-C	60.00	0.78	0.96	21	PACK-IBC014-C	60.70	6.00	10.20	1155	PACK-CTC011-C	63.0	15.0	23.0	4620	
CH0122*M*00.*0	22	G	PACK-TBC013-C	60.00	0.78	0.96	20	PACK-IBC014-C	60.70	6.00	10.20	1100	PACK-CTC011-C	63.0	15.0	23.0	4400	
CH0123*M*00.*0	23	G	PACK-TBC013-C	60.00	0.78	0.96	19	PACK-IBC014-C	60.70	6.00	10.20	1045	PACK-CTC011-C	63.0	15.0	23.0	4180	
CH0124*M*00.*0	24	G	PACK-TBC013-C	60.00	0.78	0.96	19	PACK-IBC014-C	60.70	6.00	10.20	1045	PACK-CTC011-C	63.0	15.0	23.0	4180	
CH0125*M*00.*0	25	G	PACK-TBC013-C	60.00	0.78	0.96	18	PACK-IBC014-C	60.70	6.00	10.20	990	PACK-CTC011-C	63.0	15.0	23.0	3960	
CH0126*M*00.*0	26	G	PACK-TBC013-C	60.00	0.78	0.96	17	PACK-IBC014-C	60.70	6.00	10.20	935	PACK-CTC011-C	63.0	15.0	23.0	3740	
CH0127*M*00.*0	27	G	PACK-TBC013-C	60.00	0.78	0.96	17	PACK-IBC014-C	60.70	6.00	10.20	935	PACK-CTC011-C	63.0	15.0	23.0	3740	
CH0128*M*00.*0	28	G	PACK-TBC013-C	60.00	0.78	0.96	16	PACK-IBC014-C	60.70	6.00	10.20	880	PACK-CTC011-C	63.0	15.0	23.0	3520	
CH0129*M*00.*0	29	G	PACK-TBC013-C	60.00	0.78	0.96	15	PACK-IBC014-C	60.70	6.00	10.20	825	PACK-CTC011-C	63.0	15.0	23.0	3300	
CH0130*M*00.*0	30	G	PACK-TBC013-C	60.00	0.78	0.96	15	PACK-IBC014-C	60.70	6.00	10.20	825	PACK-CTC011-C	63.0	15.0	23.0	3300	

PACKING METHOD (包裝方式) :

1 PVC BAG (塑膠袋)  
SIZE = L \* W



2 TUBE (塑膠管)  
SIZE = L \* W \* H

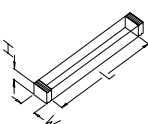

3 PVC TRAY (塑膠盒)  
SIZE = L \* W \* H

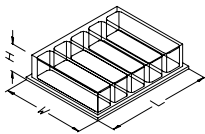

4 REEL (紙盤)  
SIZE = D \* W

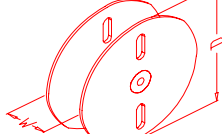

5 BOX (內紙盒)  
SIZE = L \* W \* H

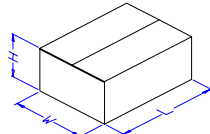

6 INSIDE CARTON (內箱)

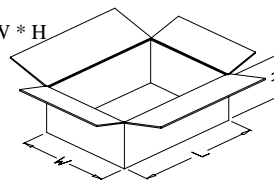

7 OUTSIDE CARTON (外箱)  
SIZE = L \* W \* H

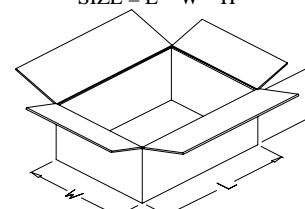

PACKING METHOD CODE (包裝方式代碼) :

- A = 1 → 7
- B = 2 → 7
- C = 3 → 7
- D = 4 → 7
- E = 5 → 7
- F = 6 → 7
- G = (2+1) → 6 → 7
- H = 1 → 3 → 7



文件編號：CI15H011 (2 of 2)

版 別： 3



瀚荃股份有限公司  
CviLux Corporation  
PACKING STANDARD

製訂日期：2009/3/25

SERIES OR P/N	CIRCUITS	PACKING METHOD CODE	INNER PACKING NO.	INNER PACKING SIZE (CM)			INNER PACKING Q'TY	INSIDE CARTON NO.	INSIDE CARTON SIZE (CM)			PCS / INSIDE CARTON	CARTON NO.	CARTON SIZE (CM)			PCS / CARTON	G.W REF. (KG)
				L/D	W	H			L	W	H			L	W	H		
CH0131*M*00-*0	31	G	PACK-TBC013-C	60.00	0.78	0.96	14	PACK-IBC014-C	60.70	6.00	10.20	770	PACK-CTC011-C	63.0	15.0	23.0	3080	
CH0132*M*00-*0	32	G	PACK-TBC013-C	60.00	0.78	0.96	14	PACK-IBC014-C	60.70	6.00	10.20	770	PACK-CTC011-C	63.0	15.0	23.0	3080	
CH0133*M*00-*0	33	G	PACK-TBC013-C	60.00	0.78	0.96	13	PACK-IBC014-C	60.70	6.00	10.20	715	PACK-CTC011-C	63.0	15.0	23.0	2860	
CH0134*M*00-*0	34	G	PACK-TBC013-C	60.00	0.78	0.96	13	PACK-IBC014-C	60.70	6.00	10.20	715	PACK-CTC011-C	63.0	15.0	23.0	2860	
CH0135*M*00-*0	35	G	PACK-TBC013-C	60.00	0.78	0.96	13	PACK-IBC014-C	60.70	6.00	10.20	715	PACK-CTC011-C	63.0	15.0	23.0	2860	
CH0136*M*00-*0	36	G	PACK-TBC013-C	60.00	0.78	0.96	12	PACK-IBC014-C	60.70	6.00	10.20	660	PACK-CTC011-C	63.0	15.0	23.0	2640	
CH0137*M*00-*0	37	G	PACK-TBC013-C	60.00	0.78	0.96	12	PACK-IBC014-C	60.70	6.00	10.20	660	PACK-CTC011-C	63.0	15.0	23.0	2640	
CH0138*M*00-*0	38	G	PACK-TBC013-C	60.00	0.78	0.96	12	PACK-IBC014-C	60.70	6.00	10.20	660	PACK-CTC011-C	63.0	15.0	23.0	2640	
CH0139*M*00-*0	39	G	PACK-TBC013-C	60.00	0.78	0.96	11	PACK-IBC014-C	60.70	6.00	10.20	605	PACK-CTC011-C	63.0	15.0	23.0	2420	
CH0140*M*00-*0	40	G	PACK-TBC013-C	60.00	0.78	0.96	11	PACK-IBC014-C	60.70	6.00	10.20	605	PACK-CTC011-C	63.0	15.0	23.0	2420	
CH0141*M*00-*0	41	G	PACK-TBC013-C	60.00	0.78	0.96	11	PACK-IBC014-C	60.70	6.00	10.20	605	PACK-CTC011-C	63.0	15.0	23.0	2420	
CH0142*M*00-*0	42	G	PACK-TBC013-C	60.00	0.78	0.96	10	PACK-IBC014-C	60.70	6.00	10.20	550	PACK-CTC011-C	63.0	15.0	23.0	2200	
CH0143*M*00-*0	43	G	PACK-TBC013-C	60.00	0.78	0.96	10	PACK-IBC014-C	60.70	6.00	10.20	550	PACK-CTC011-C	63.0	15.0	23.0	2200	
CH0144*M*00-*0	44	G	PACK-TBC013-C	60.00	0.78	0.96	10	PACK-IBC014-C	60.70	6.00	10.20	550	PACK-CTC011-C	63.0	15.0	23.0	2200	
CH0145*M*00-*0	45	G	PACK-TBC013-C	60.00	0.78	0.96	10	PACK-IBC014-C	60.70	6.00	10.20	550	PACK-CTC011-C	63.0	15.0	23.0	2200	
CH0146*M*00-*0	46	G	PACK-TBC013-C	60.00	0.78	0.96	10	PACK-IBC014-C	60.70	6.00	10.20	550	PACK-CTC011-C	63.0	15.0	23.0	2200	
CH0147*M*00-*0	47	G	PACK-TBC013-C	60.00	0.78	0.96	9	PACK-IBC014-C	60.70	6.00	10.20	495	PACK-CTC011-C	63.0	15.0	23.0	1980	
CH0148*M*00-*0	48	G	PACK-TBC013-C	60.00	0.78	0.96	9	PACK-IBC014-C	60.70	6.00	10.20	495	PACK-CTC011-C	63.0	15.0	23.0	1980	
CH0149*M*00-*0	49	G	PACK-TBC013-C	60.00	0.78	0.96	9	PACK-IBC014-C	60.70	6.00	10.20	495	PACK-CTC011-C	63.0	15.0	23.0	1980	
CH0150*M*00-*0	50	G	PACK-TBC013-C	60.00	0.78	0.96	9	PACK-IBC014-C	60.70	6.00	10.20	495	PACK-CTC011-C	63.0	15.0	23.0	1980	

PACKING METHOD (包裝方式) :

1 PVC BAG (塑膠袋)  
SIZE = L \* W

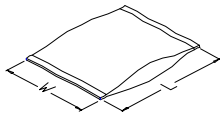

2 TUBE (塑膠管)  
SIZE = L \* W \* H

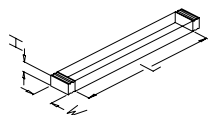

3 PVC TRAY (塑膠盒)  
SIZE = L \* W \* H

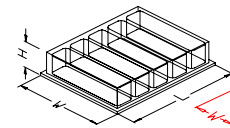

4 REEL (紙盤)  
SIZE = D \* W

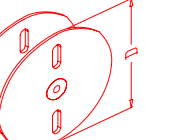

5 BOX (內紙盒)  
SIZE = L \* W \* H

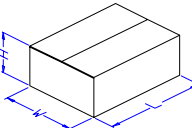

6 INSIDE CARTON (內箱)  
SIZE = L \* W \* H

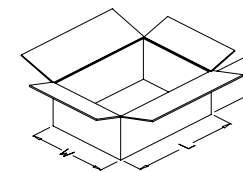

7 OUTSIDE CARTON (外箱)  
SIZE = L \* W \* H

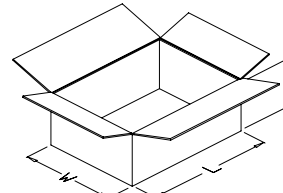

PACKING METHOD CODE (包裝方式代碼) :

- A = 1 → 7
- B = 2 → 7
- C = 3 → 7
- D = 4 → 7
- E = 5 → 7
- E = 5 → 7
- G = (2+1) → 6 → 7
- H = 1 → 3 → 7

核准：SMITH

審核：PETER

製訂：ANSON