

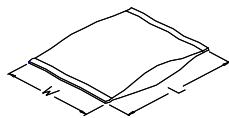

SERIES OR P/N	CIRCUITS	PACKING METHOD CODE	INNER PACKING NO.	INNER PACKING SIZE (CM)			INNER PACKING QTY	INSIDE CARTON NO.	INSIDE CARTON SIZE (CM)			PCS / INSIDE CARTON	CARTON NO.	CARTON SIZE (CM)			PCS / CARTON	G.W REF. (KG)
				D	W	H			L	W	H			L	W	H		
CF1603*V*T*/-/LF	3	G	PACK-TBC013-C/014-H	60.0	0.95	0.60	72	PACK-IBC014-C/001-H	61.7	6.0	10.2	6480	PACK-CTC011/-C	63.0	15.0	23.0	25920	9.75
CF1604*V*T*/-/LF	4	G	PACK-TBC013-C/014-H	60.0	0.95	0.60	64	PACK-IBC014-C/001-H	61.7	6.0	10.2	5760	PACK-CTC011/-C	63.0	15.0	23.0	23040	10.13
CF1605*V*T*/-/LF	5	G	PACK-TBC013-C/014-H	60.0	0.95	0.60	58	PACK-IBC014-C/001-H	61.7	6.0	10.2	5220	PACK-CTC011/-C	63.0	15.0	23.0	20880	10.47
CF1606*V*T*/-/LF	6	G	PACK-TBC013-C/014-H	60.0	0.95	0.60	52	PACK-IBC014-C/001-H	61.7	6.0	10.2	4680	PACK-CTC011/-C	63.0	15.0	23.0	18720	10.76
CF1607*V*T*/-/LF	7	G	PACK-TBC013-C/014-H	60.0	0.95	0.60	48	PACK-IBC014-C/001-H	61.7	6.0	10.2	4320	PACK-CTC011/-C	63.0	15.0	23.0	17280	10.39
CF1608*V*T*/-/LF	8	G	PACK-TBC013-C/014-H	60.0	0.95	0.60	44	PACK-IBC014-C/001-H	61.7	6.0	10.2	3960	PACK-CTC011/-C	63.0	15.0	23.0	15840	10.61
CF1609*V*T*/-/LF	9	G	PACK-TBC013-C/014-H	60.0	0.95	0.60	41	PACK-IBC014-C/001-H	61.7	6.0	10.2	3690	PACK-CTC011/-C	63.0	15.0	23.0	14760	11.17
CF1610*V*T*/-/LF	10	G	PACK-TBC013-C/014-H	60.0	0.95	0.60	38	PACK-IBC014-C/001-H	61.7	6.0	10.2	3420	PACK-CTC011/-C	S	15.0	23.0	13680	10.24
CF1611*V*T*/-/LF	11	G	PACK-TBC013-C/014-H	60.0	0.95	0.60	36	PACK-IBC014-C/001-H	61.7	6.0	10.2	3240	PACK-CTC011/-C	63.0	15.0	23.0	12960	10.47
CF1612*V*T*/-/LF	12	G	PACK-TBC013-C/014-H	60.0	0.95	0.60	34	PACK-IBC014-C/001-H	61.7	6.0	10.2	3060	PACK-CTC011/-C	63.0	15.0	23.0	12240	10.39
CF1613*V*T*/-/LF	13	G	PACK-TBC013-C/014-H	60.0	0.95	0.60	32	PACK-IBC014-C/001-H	61.7	6.0	10.2	2880	PACK-CTC011/-C	63.0	15.0	23.0	11520	10.61
CF1614*V*T*/-/LF	14	G	PACK-TBC013-C/014-H	60.0	0.95	0.60	30	PACK-IBC014-C/001-H	61.7	6.0	10.2	2700	PACK-CTC011/-C	63.0	15.0	23.0	10800	10.46
CF1615*V*T*/-/LF	15	G	PACK-TBC013-C/014-H	60.0	0.95	0.60	29	PACK-IBC014-C/001-H	61.7	6.0	10.2	2610	PACK-CTC011/-C	63.0	15.0	23.0	10440	11.09
CF1616*V*T*/-/LF	16	G	PACK-TBC013-C/014-H	60.0	0.95	0.60	27	PACK-IBC014-C/001-H	61.7	6.0	10.2	2430	PACK-CTC011/-C	63.0	15.0	23.0	9720	10.49
CF1617*V*T*/-/LF	17	G	PACK-TBC013-C/014-H	60.0	0.95	0.60	26	PACK-IBC014-C/001-H	61.7	6.0	10.2	2340	PACK-CTC011/-C	63.0	15.0	23.0	9360	11.10
CF1618*V*T*/-/LF	18	G	PACK-TBC013-C/014-H	60.0	0.95	0.60	25	PACK-IBC014-C/001-H	61.7	6.0	10.2	2250	PACK-CTC011/-C	63.0	15.0	23.0	9000	10.50
CF1619*V*T*/-/LF	19	G	PACK-TBC013-C/014-H	60.0	0.95	0.60	24	PACK-IBC014-C/001-H	61.7	6.0	10.2	2160	PACK-CTC011/-C	63.0	15.0	23.0	8640	10.96
CF1620*V*T*/-/LF	20	G	PACK-TBC013-C/014-H	60.0	0.95	0.60	23	PACK-IBC014-C/001-H	61.7	6.0	10.2	2070	PACK-CTC011/-C	63.0	15.0	23.0	8280	10.47
CF1621*V*T*/-/LF	21	G	PACK-TBC013-C/014-H	60.0	0.95	0.60	22	PACK-IBC014-C/001-H	61.7	6.0	10.2	1980	PACK-CTC011/-C	63.0	15.0	23.0	7920	10.47
CF1622*V*T*/-/LF	22	G	PACK-TBC013-C/014-H	60.0	0.95	0.60	21	PACK-IBC014-C/001-H	61.7	6.0	10.2	1890	PACK-CTC011/-C	63.0	15.0	23.0	7560	10.60
CF1623*V*T*/-/LF	23	G	PACK-TBC013-C/014-H	60.0	0.95	0.60	20	PACK-IBC014-C/001-H	61.7	6.0	10.2	1800	PACK-CTC011/-C	63.0	15.0	23.0	7200	10.82
CF1624*V*T*/-/LF	24	G	PACK-TBC013-C/014-H	60.0	0.95	0.60	20	PACK-IBC014-C/001-H	61.7	6.0	10.2	1800	PACK-CTC011/-C	63.0	15.0	23.0	7200	10.62
CF1625*V*T*/-/LF	25	G	PACK-TBC013-C/014-H	60.0	0.95	0.60	19	PACK-IBC014-C/001-H	61.7	6.0	10.2	1710	PACK-CTC011/-C	63.0	15.0	23.0	6840	11.12
CF1626*V*T*/-/LF	26	G	PACK-TBC013-C/014-H	60.0	0.95	0.60	18	PACK-IBC014-C/001-H	61.7	6.0	10.2	1620	PACK-CTC011/-C	63.0	15.0	23.0	6480	10.34
CF1627*V*T*/-/LF	27	G	PACK-TBC013-C/014-H	60.0	0.95	0.60	18	PACK-IBC014-C/001-H	61.7	6.0	10.2	1620	PACK-CTC011/-C	63.0	15.0	23.0	6480	10.37
CF1628*V*T*/-/LF	28	G	PACK-TBC013-C/014-H	60.0	0.95	0.60	17	PACK-IBC014-C/001-H	61.7	6.0	10.2	1530	PACK-CTC011/-C	63.0	15.0	23.0	6120	10.49
CF1629*V*T*/-/LF	29	G	PACK-TBC013-C/014-H	60.0	0.95	0.60	17	PACK-IBC014-C/001-H	61.7	6.0	10.2	1530	PACK-CTC011/-C	63.0	15.0	23.0	6120	10.52
CF1630*V*T*/-/LF	30	G	PACK-TBC013-C/014-H	60.0	0.95	0.60	16	PACK-IBC014-C/001-H	61.7	6.0	10.2	1440	PACK-CTC011/-C	63.0	15.0	23.0	5760	10.99
CF1631*V*T*/-/LF	31	G	PACK-TBC013-C/014-H	60.0	0.95	0.60	16	PACK-IBC014-C/001-H	61.7	6.0	10.2	1440	PACK-CTC011/-C	63.0	15.0	23.0	5760	11.10

PACKING METHOD (包裝方式) :

1 PVC BAG (塑膠袋)
SIZE = L * W



2 TUBE (塑膠管)
SIZE = L * W * H

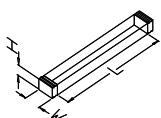

3 PVC TRAY (塑膠盒)
SIZE = L * W * H

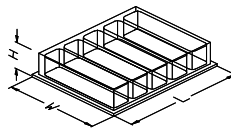

4 REEL (紙盤)
SIZE = D * W

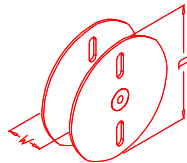

5 BOX (內紙盒)
SIZE = L * W * H

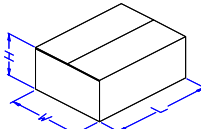

6 INSIDE CARTON (內箱)
SIZE = L * W * H

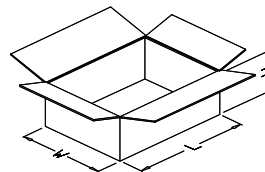

7 OUTSIDE CARTON (外箱)
SIZE = L * W * H

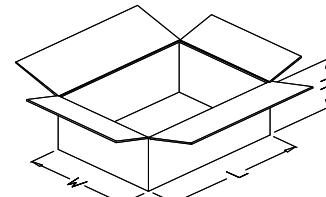

PACKING METHOD CODE (包裝方式代碼) :

- A = 1 → 7
- B = 2 → 7
- C = 3 → 7
- D = 4 → 7
- E = 5 → 7
- F = 1 → 6 → 7
- G = (2+1) → 6 → 7
- H = 3 → 6 → 7

