



瀚荃股份有限公司
CviLux Corporation
PACKING STANDARD

SERIES OR P/N	CIRCUITS	PACKING METHOD CODE	INNER PACKING NO.	INNER PACKING SIZE (CM)			INNER PACKING QTY	INSIDE CARTON NO.	INSIDE CARTON SIZE (CM)			PCS / INSIDE CARTON	CARTON NO.	CARTON SIZE (CM)			PCS / CARTON	G.W REF. (KG)
				L/D	W	H			L	W	H			L	W	H		
CF1004*M0R*/-LF	4	D	PACK-CRCB101-C	-	2.40	-	800	PACK-RLCB00	-	2.45	-	800	PACK-CTC034-C	35.0	35.0	29.0	7200	9.50
CF1005*M0R*/-LF	5	D	PACK-CRCB102-C	-	2.40	-	800	PACK-RLCB00	-	2.45	-	800	PACK-CTC034-C	35.0	35.0	29.0	7200	9.79
CF1006*M0R*/-LF	6	D	PACK-CRCB18-C	-	2.40	-	800	PACK-RLCB00	-	2.45	-	800	PACK-CTC034-C	35.0	35.0	29.0	7200	10.03
CF1007*M0R*/-LF	7	D	PACK-CRCB19-C	-	2.40	-	800	PACK-RLCB00	-	2.45	-	800	PACK-CTC034-C	35.0	35.0	29.0	7200	10.22
CF1008*M0R*/-LF	8	D	PACK-CRCB33-C	-	2.40	-	800	PACK-RLCB00	-	2.45	-	800	PACK-CTC034-C	35.0	35.0	29.0	7200	10.41
CF1009*M0R*/-LF	9	D	PACK-CRCB69-C	-	2.40	-	800	PACK-RLCB00	-	2.45	-	800	PACK-CTC034-C	35.0	35.0	29.0	7200	10.50
CF1010*M0R*/-LF	10	D	PACK-CRCB20-C	-	2.40	-	800	PACK-RLCB00	-	2.45	-	800	PACK-CTC034-C	35.0	35.0	29.0	7200	10.59
CF1011*M0R*/-LF	11	D	PACK-CRCC83-C	-	3.20	-	800	PACK-RLCC00	-	3.25	-	800	PACK-CTC034-C	35.0	35.0	29.0	5600	8.79
CF1012*M0R*/-LF	12	D	PACK-CRCC32-C	-	3.20	-	800	PACK-RLCC00	-	3.25	-	800	PACK-CTC034-C	35.0	35.0	29.0	5600	8.86
CF1013*M0R*/-LF	13	D	PACK-CRCC80-C	-	3.20	-	800	PACK-RLCC00	-	3.25	-	800	PACK-CTC034-C	35.0	35.0	29.0	5600	9.08
CF1014*M0R*/-LF	14	D	PACK-CRCC02-C	-	3.20	-	800	PACK-RLCC00	-	3.25	-	800	PACK-CTC034-C	35.0	35.0	29.0	5600	9.35
CF1015*M0R*/-LF	15	D	PACK-CRCC09-C	-	3.20	-	800	PACK-RLCC00	-	3.25	-	800	PACK-CTC034-C	35.0	35.0	29.0	5600	9.49
CF1016*M0R*/-LF	16	D	PACK-CRCD153-C	-	4.40	-	800	PACK-RLCD00	-	4.45	-	800	PACK-CTC034-C	35.0	35.0	29.0	4000	8.13
CF1017*M0R*/-LF	17	D	PACK-CRCD**C	-	4.40	-	800	PACK-RLCD00	-	4.45	-	800	PACK-CTC034-C	35.0	35.0	29.0	4000	7.52
CF1018*M0R*/-LF	18	D	PACK-CRCD62-C	-	4.40	-	800	PACK-RLCD00	-	4.45	-	800	PACK-CTC034-C	35.0	35.0	29.0	4000	7.62
CF1019*M0R*/-LF	19	D	PACK-CRCD**C	-	4.40	-	800	PACK-RLCD00	-	4.45	-	800	PACK-CTC034-C	35.0	35.0	29.0	4000	7.72
CF1020*M0R*/-LF	20	D	PACK-CRCD58-C	-	4.40	-	800	PACK-RLCD00	-	4.45	-	800	PACK-CTC034-C	35.0	35.0	29.0	4000	7.82
CF1021*M0R*/-LF	21	D	PACK-CRCD**C	-	4.40	-	800	PACK-RLCD00	-	4.45	-	800	PACK-CTC034-C	35.0	35.0	29.0	4000	7.93
CF1022*M0R*/-LF	22	D	PACK-CRCD05-C	-	4.40	-	800	PACK-RLCD00	-	4.45	-	800	PACK-CTC034-C	35.0	35.0	29.0	4000	8.10
CF1023*M0R*/-LF	23	D	PACK-CRCD84-C	-	4.40	-	800	PACK-RLCD00	-	4.45	-	800	PACK-CTC034-C	35.0	35.0	29.0	4000	8.18
CF1024*M0R*/-LF	24	D	PACK-CRCD10-C	-	4.40	-	800	PACK-RLCD00	-	4.45	-	800	PACK-CTC034-C	35.0	35.0	29.0	4000	8.27
CF1025*M0R*/-LF	25	D	PACK-CRCD**C	-	4.40	-	800	PACK-RLCD00	-	4.45	-	800	PACK-CTC034-C	35.0	35.0	29.0	4000	8.35
CF1026*M0R*/-LF	26	D	PACK-CRCD01-C	-	4.40	-	800	PACK-RLCD00	-	4.45	-	800	PACK-CTC034-C	35.0	35.0	29.0	4000	8.44
CF1027*M0R*/-LF	27	D	PACK-CRCD59-C	-	4.40	-	800	PACK-RLCD00	-	4.45	-	800	PACK-CTC034-C	35.0	35.0	29.0	4000	8.52
CF1028*M0R*/-LF	28	D	PACK-CRCE16-C	-	5.60	-	800	PACK-RLCE00	-	5.65	-	800	PACK-CTC034-C	35.0	35.0	29.0	3200	7.44
CF1029*M0R*/-LF	29	D	PACK-CRCE**C	-	5.60	-	800	PACK-RLCE00	-	5.65	-	800	PACK-CTC034-C	35.0	35.0	29.0	3200	7.62
CF1030*M0R*/-LF	30	D	PACK-CRCE15-C	-	5.60	-	800	PACK-RLCE00	-	5.65	-	800	PACK-CTC034-C	35.0	35.0	29.0	3200	4.86
CF1031*M0R*/-LF	31	D	PACK-CRCE**C	-	5.60	-	800	PACK-RLCE00	-	5.65	-	800	PACK-CTC034-C	35.0	35.0	29.0	3200	7.86

PACKING METHOD (包裝方式)：

1 PVC BAG (塑膠袋)
SIZE = L * W

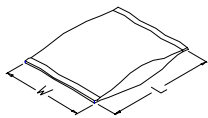

2 TUBE (塑膠管)
SIZE = L * W * H

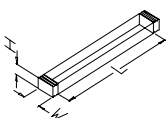

3 PVC TRAY (塑膠盒)
SIZE = L * W * H

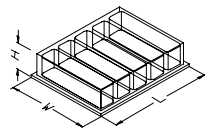

4 REEL (紙盤)
SIZE = D * W

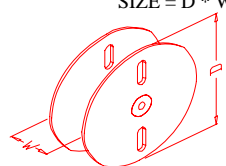

5 BOX (內紙盒)
SIZE = L * W * H

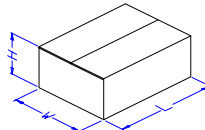

6 INSIDE CARTON (內箱)
SIZE = L * W * H

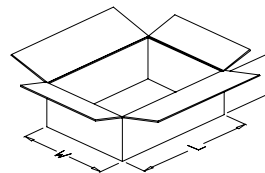

7 OUTSIDE CARTON (外箱)
SIZE = L * W * H

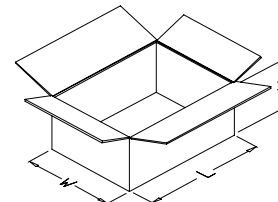

PACKING METHOD CODE (包裝方式代碼)：

- A = 1 → 7
- B = 2 → 7
- C = 3 → 7
- D = (4+1) → 7
- E = 5 → 7
- F = 1 → 6 → 7
- G = 2 → 6 → 7
- H = 3 → 6 → 7

