



PACKING STANDARD

SERIES OR P/N	CIRCUITS	PACKING METHOD CODE	INNER PACKING NO.	INNER PACKING SIZE (CM)			INNER PACKING QTY	INSIDE CARTON NO.	INSIDE CARTON SIZE (CM)			PCS / INSIDE CARTON	CARTON NO.	CARTON SIZE (CM)			PCS / CARTON	G.W REF. (KG)
				L/D	W	H			L	W	H			L	W	H		
CBRB010PC*FP*R0-NH	D	10	PACK-CRCA119-C	-	1.6	-	1000	PACK-RLCA01-C		1.75		1000	PACK-CTC034-C	35	35	32	11000	
CBRB016PC*FP*R0-NH	D	16	PACK-CRCA112-C	-	1.6	-	1000	PACK-RLCA01-C		1.75		1000	PACK-CTC034-C	35	35	32	11000	
CBRB020PC*FP*R0-NH	D	20	PACK-CRCA120-C	-	1.6	-	1000	PACK-RLCA01-C		1.75		1000	PACK-CTC034-C	35	35	32	11000	
CBRB024PC*FP*R0-NH	D	28	PACK-CRCB370-C	-	2.4	-	1000	PACK-RLCB01-C		2.55		1000	PACK-CTC034-C	35	35	32	9000	
CBRB028PC*FP*R0-NH	D	28	PACK-CRCB318-C	-	2.4	-	1000	PACK-RLCB01-C		2.55		1000	PACK-CTC034-C	35	35	32	9000	
CBRB030PC*FP*R0-NH	D	30	PACK-CRCB345-C	-	2.4	-	1000	PACK-RLCB01-C		2.55		1000	PACK-CTC034-C	35	35	32	9000	
CBRB040PC*FP*R0-NH	D	40	PACK-CRCB300-C	-	2.4	-	1000	PACK-RLCB01-C		2.55		1000	PACK-CTC034-C	35	35	32	9000	
CBRB048PC*FP*R0-NH	D	48	PACK-CRCB338-C	-	2.4	-	1000	PACK-RLCB01-C		2.55		1000	PACK-CTC034-C	35	35	32	9000	
CBRB050PC*FP*R0-NH	D	50	PACK-CRCB273-C	-	2.4	-	1000	PACK-RLCB01-C		2.55		1000	PACK-CTC034-C	35	35	32	9000	
CBRB060PC*FP*R0-NH	D	60	PACK-CRCC176-C	-	3.2	-	1000	PACK-RLCC01-C		3.35		1000	PACK-CTC034-C	35	35	32	7000	
CBRB080PC*FP*R0-NH	D	80	PACK-CRCD276-C	-	4.4	-	1000	PACK-RLCD01-C		4.55		1000	PACK-CTC034-C	35	35	32	5000	

PACKING METHOD (包裝方式) :

1 PVC BAG (塑膠袋)
SIZE = L * W

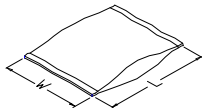

2 TUBE (塑膠管)
SIZE = L * W * H

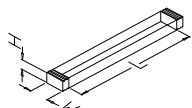

3 PVC TRAY (塑膠盒)
SIZE = L * W * H

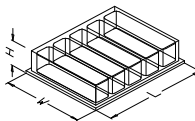

4 REEL (盤)
SIZE = D * W

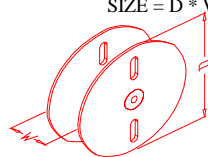

5 BOX (內紙盒)
SIZE = L * W * H

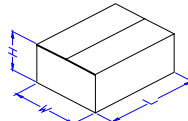

6 INSIDE CARTON (內箱)
SIZE = L * W * H

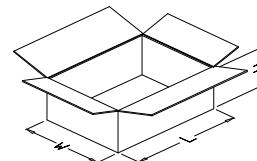

7 OUTSIDE CARTON (外箱)
SIZE = L * W * H

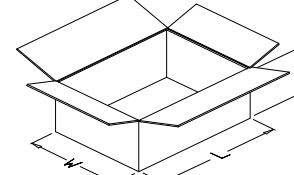

PACKING METHOD CODE (包裝方式代碼) :

- A = 1 → 7
- B = 2 → 7
- C = 3 → 7
- D = 4 → 7
- E = 5 → 7
- F = 1 → 6 → 7
- G = 2 → 6 → 7
- H = 3 → 6 → 7