

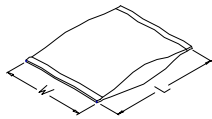

SERIES OR P/N	CIRCUITS	PACKING METHOD CODE	INNER PACKING NO.	INNER PACKING SIZE (CM)			INNER PACKING QTY	INSIDE CARTON NO.	INSIDE CARTON SIZE (CM)			PCS / INSIDE CARTON	CARTON NO.	CARTON SIZE (CM)			PCS / CARTON	G.W REF. (KG)
				L/D	W	H			L	W	H			L	W	H		
CB50062*0T0	6	G	PACK-TBC052-C	60	0.74	0.5	137	PACK-IBC014-C	61.7	6.0	10.2	17262	PACK-CTC011-C	63	15	23	69048	9.48
CB50082*0T0	8	G	PACK-TBC052-C	60	0.74	0.5	106	PACK-IBC014-C	61.7	6.0	10.2	13356	PACK-CTC011-C	63	15	23	53424	9.38
CB50102*0T0	10	G	PACK-TBC052-C	60	0.74	0.5	86	PACK-IBC014-C	61.7	6.0	10.2	10836	PACK-CTC011-C	63	15	23	43344	8.96
CB50122*0T0	12	G	PACK-TBC052-C	60	0.74	0.5	72	PACK-IBC014-C	61.7	6.0	10.2	9072	PACK-CTC011-C	63	15	23	36288	8.99
CB50142*0T0	14	G	PACK-TBC052-C	60	0.74	0.5	62	PACK-IBC014-C	61.7	6.0	10.2	7812	PACK-CTC011-C	63	15	23	31248	8.98
CB50162*0T0	16	G	PACK-TBC052-C	60	0.74	0.5	55	PACK-IBC014-C	61.7	6.0	10.2	6930	PACK-CTC011-C	63	15	23	27720	9.03
CB50182*0T0	18	G	PACK-TBC052-C	60	0.74	0.5	49	PACK-IBC014-C	61.7	6.0	10.2	6174	PACK-CTC011-C	63	15	23	24696	9.02
CB50202*0T0	20	G	PACK-TBC052-C	60	0.74	0.5	44	PACK-IBC014-C	61.7	6.0	10.2	5544	PACK-CTC011-C	63	15	23	22176	9.03
CB50222*0T0	22	G	PACK-TBC052-C	60	0.74	0.5	40	PACK-IBC014-C	61.7	6.0	10.2	5040	PACK-CTC011-C	63	15	23	20160	9.03
CB50242*0T0	24	G	PACK-TBC052-C	60	0.74	0.5	37	PACK-IBC014-C	61.7	6.0	10.2	4662	PACK-CTC011-C	63	15	23	18648	9.05
CB50262*0T0	26	G	PACK-TBC052-C	60	0.74	0.5	34	PACK-IBC014-C	61.7	6.0	10.2	4284	PACK-CTC011-C	63	15	23	17136	9.02
CB50282*0T0	28	G	PACK-TBC052-C	60	0.74	0.5	32	PACK-IBC014-C	61.7	6.0	10.2	4032	PACK-CTC011-C	63	15	23	16128	9.07
CB50302*0T0	30	G	PACK-TBC052-C	60	0.74	0.5	30	PACK-IBC014-C	61.7	6.0	10.2	3780	PACK-CTC011-C	63	15	23	15120	9.09
CB50322*0T0	32	G	PACK-TBC052-C	60	0.74	0.5	28	PACK-IBC014-C	61.7	6.0	10.2	3528	PACK-CTC011-C	63	15	23	14112	9.08
CB50342*0T0	34	G	PACK-TBC052-C	60	0.74	0.5	26	PACK-IBC014-C	61.7	6.0	10.2	3276	PACK-CTC011-C	63	15	23	13104	9.04
CB50362*0T0	36	G	PACK-TBC052-C	60	0.74	0.5	25	PACK-IBC014-C	61.7	6.0	10.2	3150	PACK-CTC011-C	63	15	23	12600	9.09
CB50382*0T0	38	G	PACK-TBC052-C	60	0.74	0.5	23	PACK-IBC014-C	61.7	6.0	10.2	2898	PACK-CTC011-C	63	15	23	11592	9.00
CB50402*0T0	40	G	PACK-TBC052-C	60	0.74	0.5	22	PACK-IBC014-C	61.7	6.0	10.2	2772	PACK-CTC011-C	63	15	23	11088	9.03
CB50422*0T0	42	G	PACK-TBC052-C	60	0.74	0.5	21	PACK-IBC014-C	61.7	6.0	10.2	2646	PACK-CTC011-C	63	15	23	10584	9.04
CB50442*0T0	44	G	PACK-TBC052-C	60	0.74	0.5	20	PACK-IBC014-C	61.7	6.0	10.2	2520	PACK-CTC011-C	63	15	23	10080	9.02
CB50462*0T0	46	G	PACK-TBC052-C	60	0.74	0.5	19	PACK-IBC014-C	61.7	6.0	10.2	2394	PACK-CTC011-C	63	15	23	9576	9.01
CB50482*0T0	48	G	PACK-TBC052-C	60	0.74	0.5	18	PACK-IBC014-C	61.7	6.0	10.2	2268	PACK-CTC011-C	63	15	23	9072	8.98
CB50502*0T0	50	G	PACK-TBC052-C	60	0.74	0.5	18	PACK-IBC014-C	61.7	6.0	10.2	2268	PACK-CTC011-C	63	15	23	9072	9.09
CB50522*0T0	52	G	PACK-TBC052-C	60	0.74	0.5	17	PACK-IBC014-C	61.7	6.0	10.2	2142	PACK-CTC011-C	63	15	23	8568	9.04
CB50542*0T0	54	G	PACK-TBC052-C	60	0.74	0.5	16	PACK-IBC014-C	61.7	6.0	10.2	2016	PACK-CTC011-C	63	15	23	8064	8.98
CB50562*0T0	56	G	PACK-TBC052-C	60	0.74	0.5	16	PACK-IBC014-C	61.7	6.0	10.2	2016	PACK-CTC011-C	63	15	23	8064	9.08
CB50582*0T0	58	G	PACK-TBC052-C	60	0.74	0.5	15	PACK-IBC014-C	61.7	6.0	10.2	1890	PACK-CTC011-C	63	15	23	7560	9.00

PACKING METHOD (包裝方式) :

1 PVC BAG  
(塑膠袋)  
SIZE = L \* W



2 TUBE  
(塑膠管)  
SIZE = L \* W \* H

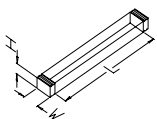

3 PVC TRAY  
(塑膠盒)  
SIZE = L \* W \* H

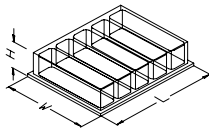

4 REEL  
(紙盤)  
SIZE = D \* W

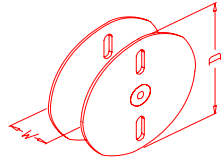

5 BOX  
(內紙盒)  
SIZE = L \* W \* H

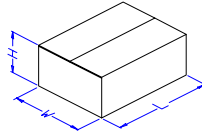

6 INSIDE CARTON  
(內箱)  
SIZE = L \* W \* H

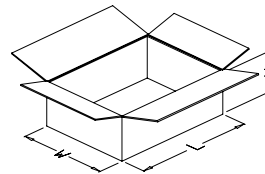

7 OUTSIDE CARTON  
(外箱)  
SIZE = L \* W \* H

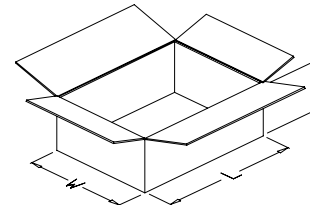

PACKING METHOD CODE (包裝方式代碼) :

- A = 1 → 7
- B = 2 → 7
- C = 3 → 7
- D = 4 → 7
- E = 5 → 7
- G = 2 → 6 → 7
- H = 3 → 6 → 7



瀚荃股份有限公司  
CviLux Corporation  
**PACKING STANDARD**

製訂日期：2009/8/25

SERIES OR P/N	CIRCUITS	PACKING METHOD CODE	INNER PACKING NO.	INNER PACKING SIZE (CM)			INNER PACKING Q'TY	INSIDE CARTON NO.	INSIDE CARTON SIZE (CM)			PCS / INSIDE CARTON	CARTON NO.	CARTON SIZE (CM)			PCS / CARTON	G.W REF. (KG)
				L/D	W	H			L	W	H			L	W	H		
CB50602*0T0	60	G	PACK-TBC052-C	60.0	0.74	0.5	15	PACK-IBC014-C	61.7	6.0	10.2	1890	PACK-CTC011-C	63	15	23	7560	9.14
CB50622*0T0	62	G	PACK-TBC052-C	60.0	0.74	0.5	14	PACK-IBC014-C	61.7	6.0	10.2	1764	PACK-CTC011-C	63	15	23	7056	8.99
CB50642*0T0	64	G	PACK-TBC052-C	60.0	0.74	0.5	14	PACK-IBC014-C	61.7	6.0	10.2	1764	PACK-CTC011-C	63	15	23	7056	9.08
CB50662*0T0	66	G	PACK-TBC052-C	60.0	0.74	0.5	13	PACK-IBC014-C	61.7	6.0	10.2	1638	PACK-CTC011-C	63	15	23	6552	8.96
CB50682*0T0	68	G	PACK-TBC052-C	60.0	0.74	0.5	13	PACK-IBC014-C	61.7	6.0	10.2	1638	PACK-CTC011-C	63	15	23	6552	9.04
CB50702*0T0	70	G	PACK-TBC052-C	60.0	0.74	0.5	13	PACK-IBC014-C	61.7	6.0	10.2	1638	PACK-CTC011-C	63	15	23	6552	9.51
CB50722*0T0	72	G	PACK-TBC052-C	60.0	0.74	0.5	12	PACK-IBC014-C	61.7	6.0	10.2	1512	PACK-CTC011-C	63	15	23	6048	9.35
CB50742*0T0	74	G	PACK-TBC052-C	60.0	0.74	0.5	12	PACK-IBC014-C	61.7	6.0	10.2	1512	PACK-CTC011-C	63	15	23	6048	9.43
CB50762*0T0	76	G	PACK-TBC052-C	60.0	0.74	0.5	12	PACK-IBC014-C	61.7	6.0	10.2	1512	PACK-CTC011-C	63	15	23	6048	9.52
CB50782*0T0	78	G	PACK-TBC052-C	60.0	0.74	0.5	11	PACK-IBC014-C	61.7	6.0	10.2	1386	PACK-CTC011-C	63	15	23	5544	9.32
CB50802*0T0	80	G	PACK-TBC052-C	60.0	0.74	0.5	11	PACK-IBC014-C	61.7	6.0	10.2	1386	PACK-CTC011-C	63	15	23	5544	9.40
CB50822*0T0	82	G	PACK-TBC052-C	60.0	0.74	0.5	11	PACK-IBC014-C	61.7	6.0	10.2	1386	PACK-CTC011-C	63	15	23	5544	9.48
CB50842*0T0	84	G	PACK-TBC052-C	60.0	0.74	0.5	10	PACK-IBC014-C	61.7	6.0	10.2	1260	PACK-CTC011-C	63	15	23	5040	9.26
CB50862*0T0	86	G	PACK-TBC052-C	60.0	0.74	0.5	10	PACK-IBC014-C	61.7	6.0	10.2	1260	PACK-CTC011-C	63	15	23	5040	9.33
CB50882*0T0	88	G	PACK-TBC052-C	60.0	0.74	0.5	10	PACK-IBC014-C	61.7	6.0	10.2	1260	PACK-CTC011-C	63	15	23	5040	9.40
CB50902*0T0	90	G	PACK-TBC052-C	60.0	0.74	0.5	10	PACK-IBC014-C	61.7	6.0	10.2	1260	PACK-CTC011-C	63	15	23	5040	9.47
CB50922*0T0	92	G	PACK-TBC052-C	60.0	0.74	0.5	9	PACK-IBC014-C	61.7	6.0	10.2	1134	PACK-CTC011-C	63	15	23	4536	9.21
CB50942*0T0	94	G	PACK-TBC052-C	60.0	0.74	0.5	9	PACK-IBC014-C	61.7	6.0	10.2	1134	PACK-CTC011-C	63	15	23	4536	9.27
CB50962*0T0	96	G	PACK-TBC052-C	60.0	0.74	0.5	9	PACK-IBC014-C	61.7	6.0	10.2	1134	PACK-CTC011-C	63	15	23	4536	9.33
CB50982*0T0	98	G	PACK-TBC052-C	60.0	0.74	0.5	9	PACK-IBC014-C	61.7	6.0	10.2	1134	PACK-CTC011-C	63	15	23	4536	9.40
CB50X12*0T0	100	G	PACK-TBC052-C	60.0	0.74	0.5	9	PACK-IBC014-C	61.7	6.0	10.2	1134	PACK-CTC011-C	63	15	23	4536	9.46

以上最後兩碼\*\*表示適用於如下產品料號：

CB50\*\*200T0、CB50\*\*2A0T0.

**PACKING METHOD (包裝方式) :**

1 PVC BAG  
(塑膠袋)  
SIZE = L \* W

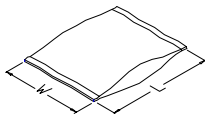

2 UBE  
(塑膠管)  
SIZE = L \* W \* H

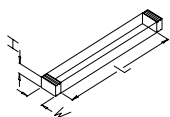

3 PVC TRAY  
(塑膠盒)  
SIZE = L \* W \* H

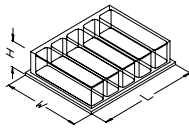

4 REEL  
(紙盤)  
SIZE = D \* W

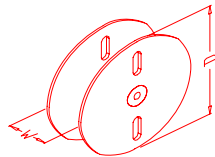

5 BOX  
(內紙盒)  
SIZE = L \* W \* H

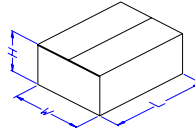

6 INSIDE CARTON  
(內箱)  
SIZE = L \* W \* H

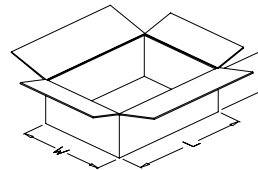

7 OUTSIDE CARTON  
(外箱)  
SIZE = L \* W \* H

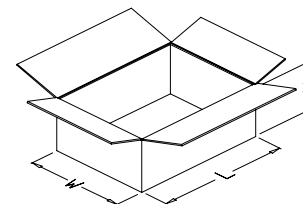

**PACKING METHOD CODE (包裝方式代碼) :**

- A = 1 → 7
- B = 2 → 7
- C = 3 → 7
- D = 4 → 7
- E = 5 → 7
- F = 1 → 6 → 7
- G = 2 → 6 → 7
- H = 3 → 6 → 7

核准：SMITH

審核：PETER

製訂：ANSON