

Note:

- \* MAT'L: Glass Filled Polyester UL 94V-0
- △ \* Mate with CI11 terminal (P/N:CI11T011PPH)

DIM. A = 1.00 × NO. OF SPACES

DIM. B = DIM. A + 4.0

DIM. C = DIM. A + 2.2

△\* AVAILABLE IN 16,20,30,40,50 CIRCUITS

### Ordering Code

CI11    \*\*    S    D    000  
 ①    ②    ③    ④    ⑤

- ① Series No.
- ② No. of Circuits:
- ③ S= Connector housing
- ④ D= Dual Row
- △ ⑤ Color option: 000= Nature (Standard)  
 010= Black  
 070= Blue

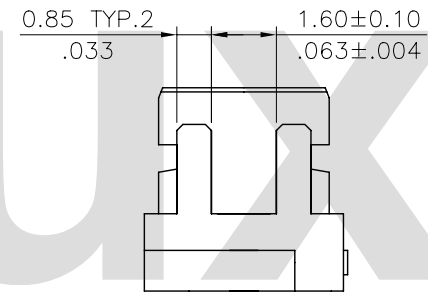
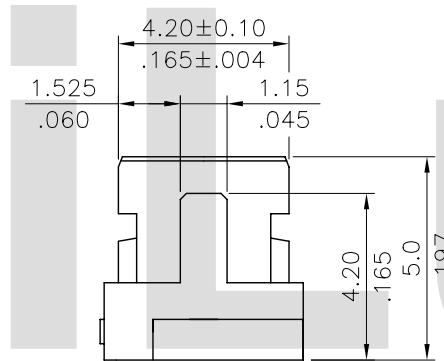
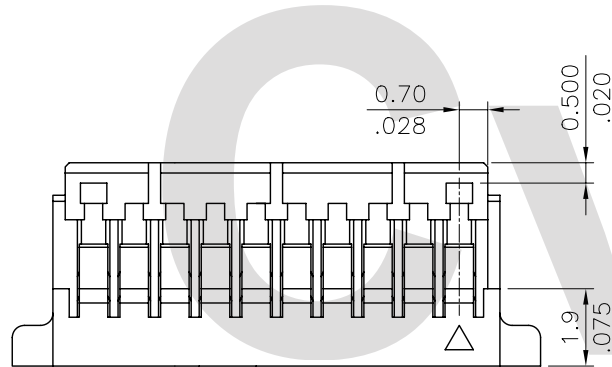

LEFT VIEW

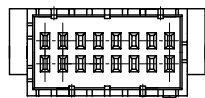

FOR 16PIN

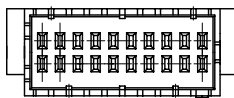

FOR 20PIN

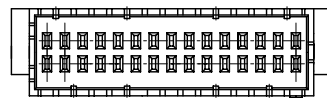

FOR 30PIN

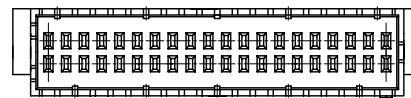

FOR 40PIN

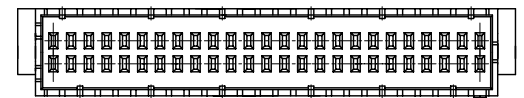

FOR 50PIN

RoHS Compliant

|     |       |           |                     |  |                   |          |                                      |   |                                |                      |
|-----|-------|-----------|---------------------|--|-------------------|----------|--------------------------------------|---|--------------------------------|----------------------|
| △4  | Sandy | 3/14-07'  | ECN07044/ECR07013-0 |  |                   | DATE     | UNIT: mm / inch                      | TITLE: 1.00MM(.079") DUAL ROW WIRE TO BOARD CONNECTOR | 瀚荃股份有限公司<br>CviLux Corporation |                      |
| △3  | Clark | 10/02/06' | ECN06302            |  | DRAWN BY: Sandy   | 3/16-07' | TOLERANCE UNLESS OTHERWISE SPECIFIED |   |                                | MATERIAL:            |
| △2  | Sabdy | 6/16/06'  | ECN06192            |  | ENGINEER: Eisley  | 3/22-07' | .X ± 0.30/.012                       | X' ± 1"   |                                | FINISH:              |
| △1  | Sabdy | 5/26/06'  | ECN06166            |  | CHECKED BY: David | 3/30-07' | .XX ± 0.20/.008                      | .X' ±   | DRAWING NO. CI1109SE           | PART NO. CI11**SD0*0 |
| SYM | NAME  | DATE      | REVISIONS           |  | APPROVED BY: Alex | 3/30-07' | .XXX ± 0.10/.004                     | .XX' ±  | SCALE 4 / 1                    | SHEET 1 OF 1         |