

Wire Range	Insulation Diameter	Reel Q'ty
AWG #22~#26	0.95~1.30mm	10,000 PCS.
AWG #28~#30	0.88~0.95mm	

Ordering Code:

CI07 T0* 1 P E 0
 ① ② ③ ④ ⑤ ⑥

- ① Series No.
- ② Type: T01= AWG #28~ #30
T02= AWG #22~ #26
- ③ Plating: 1= 30μ" Min. Tin Plated (Reflow Plated)
- ④ Material: P= Phosphor Bronze
- ⑤ Plating method: E= Pre-tinned
- ⑥ Option: 0= Standard

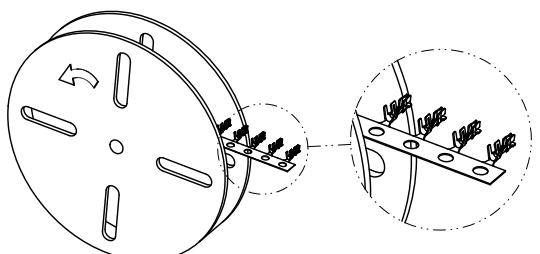

電鍍後捲料方向

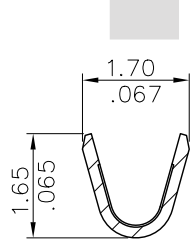

SEC. A-A

P/N: CI07T021PE0

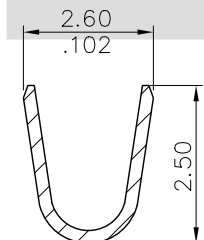

SEC. B-B

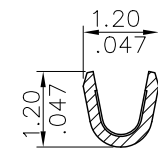

SEC. A-A

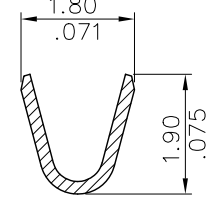

SEC. B-B

P/N: CI07T011PE0

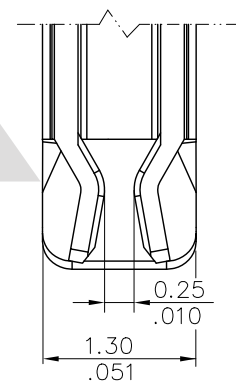

DETAIL C

SCALE: 15/1

RoHS Compliant

④	Steven	4/16-13'	ECN13084-0		DATE	UNIT: mm / inch	TITLE: FOR CI07 SERIES CRIMP TERMINAL	 瀚荃股份有限公司 CviLux Corporation	
③	Steven	8/9-11'	ECN11180		DRAWN BY: Steven	4/16-13'	TOLERANCE UNLESS OTHERWISE SPECIFIED		MATERIAL:
②	Tim	4/26-11'	ECR11026-0/ECN11076		ENGINEER: Eisley	4/17-13'	.X ± 0.25/.010 X: ± "		FINISH:
①	Tim	9/24-10'	ECN10316		CHECKED BY: Eisley	4/17-13'	.XX ± 0.15/.006 X: ±	DRAWING NO. CI0703SD PART NO. CI07T011PE0 CI07T021PE0	
SYM	NAME	DATE	REVISIONS		APPROVED BY: David	4/17-13'	.XXX ± 0.08/.003 .XX ±	SCALE 8 / 1 SHEET 1 OF 1	