

Material:

Insulator: Glass filled Polyester UL 94V-0  
Color Black or White

Contact: Brass

Shell: Steel, Tin plated as standard

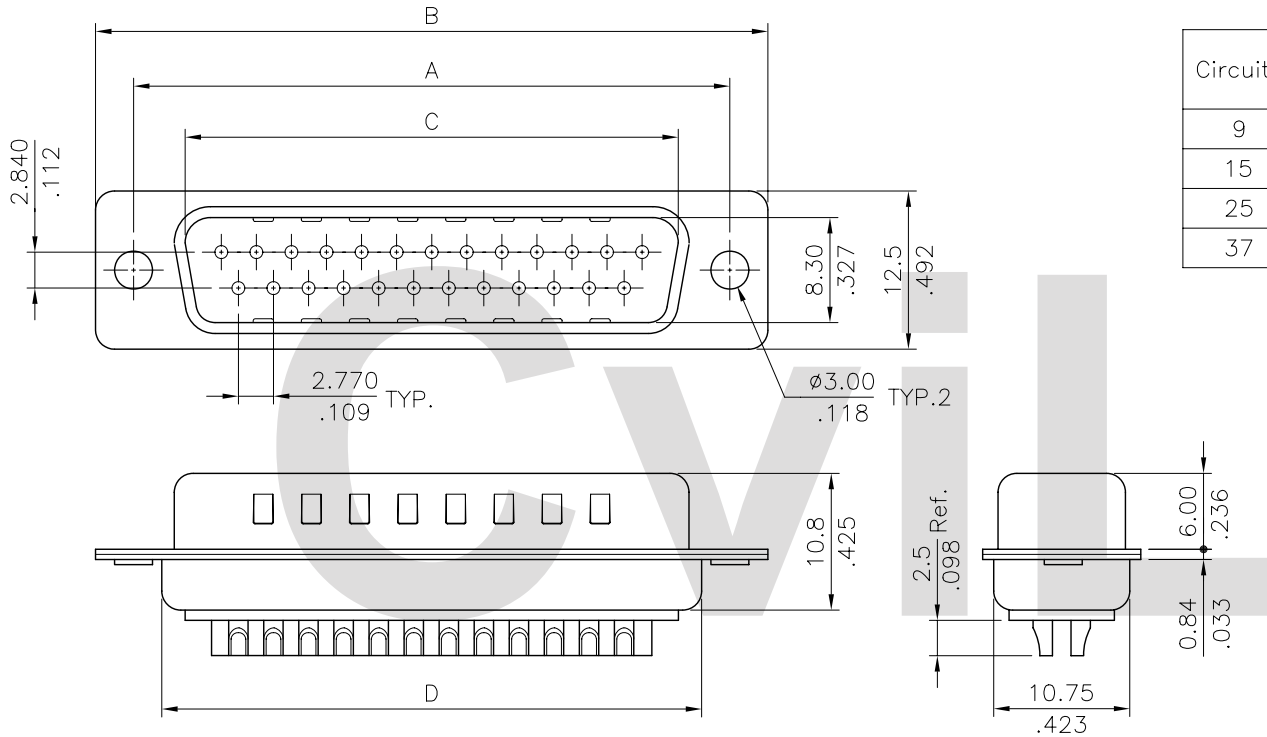

Circuits	Dimension			
	A	B	C	D
9	25.00(.984)	30.8(1.213)	16.92(.666)	19.2(.756)
15	33.32(1.312)	39.2(1.543)	25.25(.994)	27.6(1.087)
25	47.04(1.852)	53.1(2.091)	38.96(1.534)	41.1(1.618)
37	63.50(2.500)	69.4(2.732)	55.42(2.182)	57.3(2.256)

Ordering Code :

**CD71 25 P \* \* 00**

①    ②    ③    ④    ⑤    ⑥

- Series No.
- Contacts: 9,15,25,37
- Contact type : P=plug , S=Receptacle
- Contact Plating :
  - 2 = Gold flash plated over 1.27 $\mu$ m(50 $\mu$ " Nickel (Standard)
  - 3 = 0.38 $\mu$ m(15 $\mu$ " Gold plated over 1.27 $\mu$ m(50 $\mu$ " Nickel
  - 4 = 0.76 $\mu$ m(30 $\mu$ " Gold plated over 1.27 $\mu$ m(50 $\mu$ " Nickel
  - 5 = 1.27 $\mu$ m(50 $\mu$ " Gold plated over 1.27 $\mu$ m(50 $\mu$ " Nickel
- Insulator Color :
  - 1=Black , 0=White
- Other option :
  - 00 = With  $\phi 3.00$ mm holes on shell

RoHS Compliant

SYM	NAME	DATE	REVISIONS	APPROVED BY:	DATE	UNIT: mm / inch	TITLE: D-SUB SOLDER CUP MALE CONNECTOR (MACHINED CONTACT)	MATERIAL:	FINISH:	DRAWING NO.	PART NO.	SHEET	OF
4													
3													
2													
1													



瀚荃股份有限公司  
CviLux Corporation

DRAWING NO. CD7101SB PART NO. CD71\*\*P\*\*00  
SCALE 2 / 1 SHEET 1 OF 1