

Material:

* Insulation: PBT. +30%G.F. UL 94V-0

* Contact: Phosphor Bronze

Ordering Code:

CBWG ** A V 1 00
 ① ② ③ ④ ⑤ ⑥

① Series No.

② NO. of Circuits:

③ Plating code:

A= Selective Gold flash plated
 over 1.27 μ m(50 μ "") Nickel

④ Tail Style: V= Straight

⑤ Color: 1= Black

⑥ Other options: 00= Standard

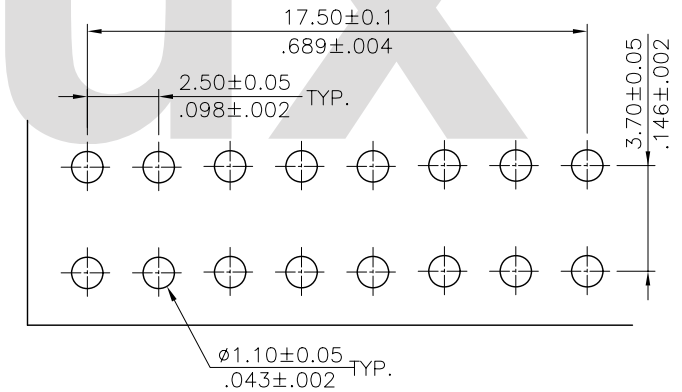
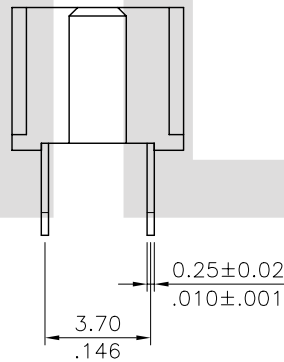
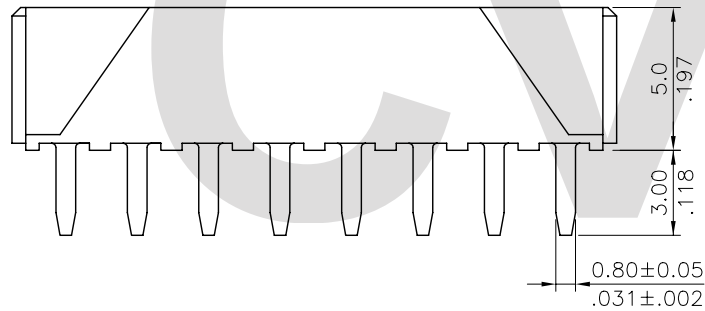
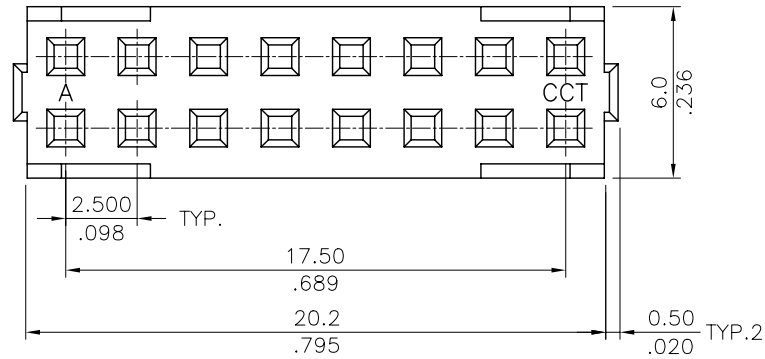

Recommended P.C. Board Layout

4					DATE	UNIT: mm / inch	TITLE: 2.50MM(.098") DUAL ROW BOARD MOUNT CONNECTOR		
3				DRAWN BY: Rita	11/22 01'	TOLERANCE UNLESS OTHERWISE SPECIFIED	MATERIAL:		
2				ENGINEER: David	11/28 01'	.X ± 0.30/.012 X' ± 1'	FINISH:		
1				CHECKED BY: David	11/28 01'	.XX ± 0.20/.008 X' ±			
SYM	NAME	DATE	REVISIONS	APPROVED BY: Alex	11/28 01'	.XXX ± 0.10/.004 XX' ±	DRAWING NO. CBWG01SD	PART NO. CBWG16AV100	
								SCALE 4 / 1	SHEET 1 OF 1