

Ordering Code:

$\frac{CB76}{①}$ $\frac{**}{②}$ $\frac{*}{③}$ $\frac{M}{④}$ $\frac{1}{⑤}$ $\frac{*}{⑥}$ $\frac{*}{⑦}$

- ① Series No.
- ② NO. of Circuits: 04 To 80
- ③ Plating code:
2= Gold flash plated over 50μ" Nickel
- ④ Tail Style: M= SMT Type
- ⑤ Color: 1= Black
- ⑥ Option: 0= With Peg
1= Without Peg
- ⑦ Other Options: 0= Standard(Tube Packing)
R= Tape & Reel
(WITH PAD:CH01000E022)

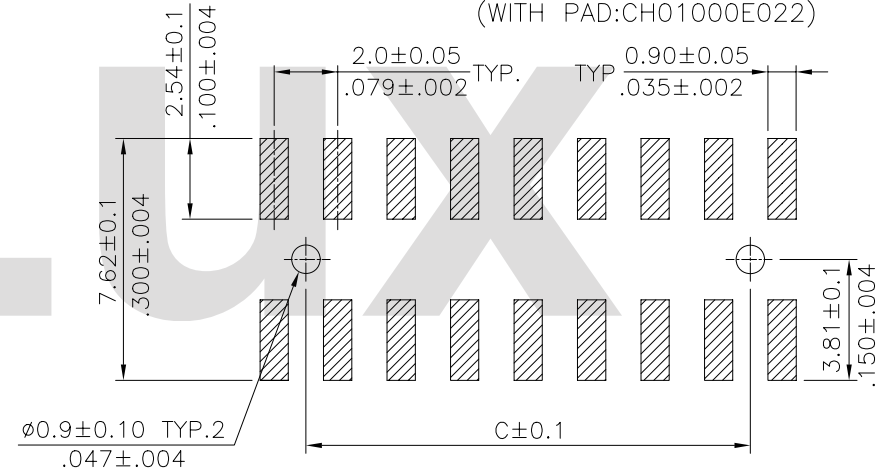
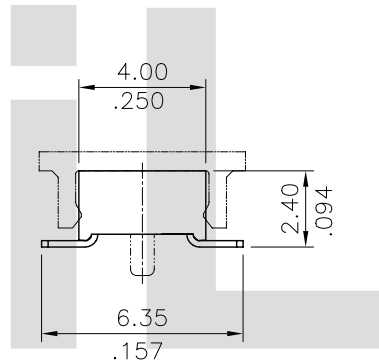
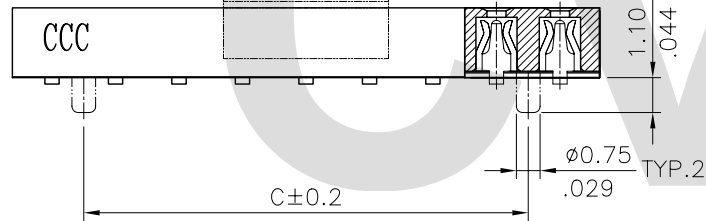
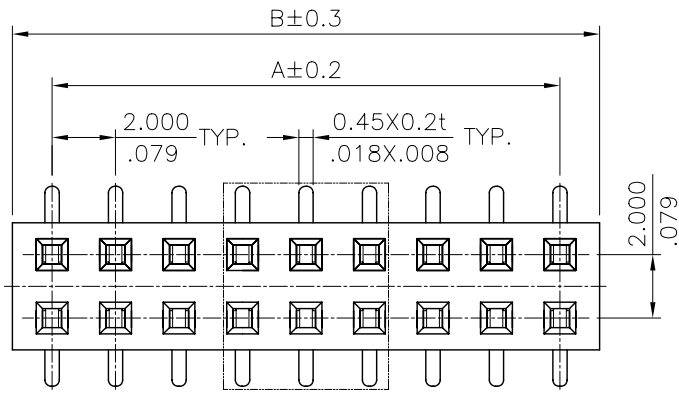

Recommended P.C. Board Layout

A = 2.00 * No. of Spaces
 B = A + 2.5
 C = A - 2.0

Lead Free Process

RoHS Compliant

④					DATE	UNIT: mm / inch	TITLE: 2.00MM(.079") DUAL ROW BOARD MOUNT CONNECTOR	瀚荃股份有限公司 CviLux Corporation	DRAWING NO. CB7601SA	PART NO. CB76**2M1**
③		DRAWN BY: Clark		5/2/07'	TOLERANCE UNLESS OTHERWISE SPECIFIED	MATERIAL:				
②		ENGINEER: Eisley		5/2/07'	.X ± 0.30 / .012 X' ± 1'					
①		CHECKED BY: David		5/2/07'	.XX ± 0.20 / .008 X' ±	FINISH:	SCALE 4 / 1	SHEET 1 OF 1		
SYM	NAME	DATE		REVISIONS	APPROVED BY: Alex		5/2/07'	.XXX ± 0.10 / .004 XX' ±		