

Material: Glass filled polyester UL 94V-0

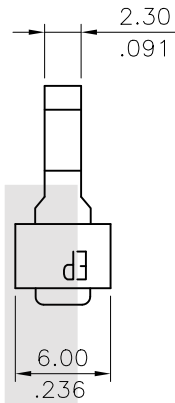
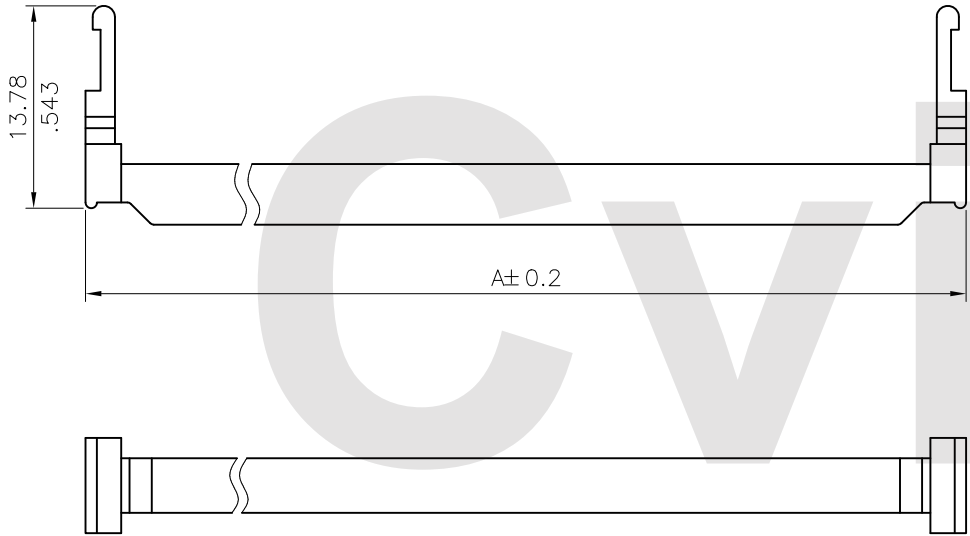

Circuits	Dimension
	A
6	12.30(.484)
8	14.84(.584)
10	17.38(.684)
12	19.92(.784)
14	22.46(.884)
16	25.00(.984)
18	27.54(1.084)
20	30.08(1.184)
22	32.62(1.284)
24	35.16(1.384)
26	37.70(1.484)
28	40.24(1.584)
30	42.78(1.684)
32	45.32(1.784)
34	47.86(1.884)
36	50.40(1.984)
40	55.48(2.184)
44	60.56(2.384)
48	65.64(2.584)
50	68.18(2.684)
60	80.88(3.184)
64	85.96(3.384)

Ordering Code:

CA21 \*\* SR 100  
 ① ② ③ ④

- ① Series No.
- ② No. of Circuits
- ③ SR= Strain-Relief
- ④ Color: 100= Black

RoHS Compliant

4						DATE	UNIT: mm / inch	TITLE:	
3	Ken	3/29-17	ECRB116097/ECNT117076		DRAWN BY:	Ken	4/10-17'	2.54MM(.100") STRAIN RELIEF	
2	Sandy	5/03/05'	ECN05147/ECR05039-0		ENGINEER:	Sun	4/11-17'	TOLERANCE UNLESS OTHERWISE SPECIFIED	MATERIAL:
1	JASON	07/29-04	ECN04292		CHECKED BY:	Eisley	5/02-17'	.X ± 0.35/.014 X' ± .1'	FINISH:
SYM	NAME	DATE	REVISIONS		APPROVED BY:	Eisley	5/02-17'	.XX ± 0.25/.010 X' ±	
							.XXX ± 0.10/.004 XX' ±		

瀚荃股份有限公司  
CviLux Corporation

DRAWING NO.	CA2102SG	PART NO.	CA21**SR100
SCALE	3 / 1	SHEET	1 OF 1