

CI52 Series 3.96mm(.156") Wire to Board Connectors

- With locking latch
- Mate with CI52 header
- Can be used CI52 crimp clip terminal
- Insulator: Nylon 66 UL 94V-0 , Color Nature
- Terminal: Tin plated Brass or Phosphor Borzne

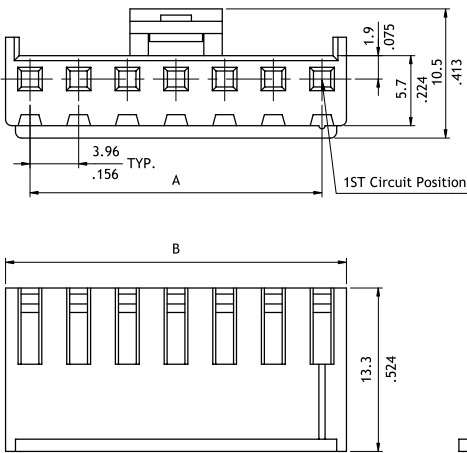

Circuits	Dimension	
	A	B
2	3.96(.156)	7.9(.311)
3	7.92(.312)	11.9(.469)
4	11.88(.468)	15.8(.622)
5	15.84(.624)	19.8(.780)
6	19.80(.780)	23.8(.937)
7	23.76(.935)	27.7(1.091)
8	27.72(1.091)	31.7(1.248)
9	31.68(1.247)	35.6(1.402)
10	35.64(1.403)	39.6(1.559)
11	39.60(1.559)	43.6(1.717)
12	43.56(1.715)	47.5(1.870)

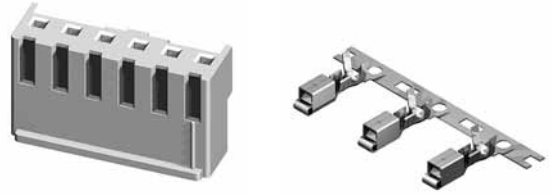
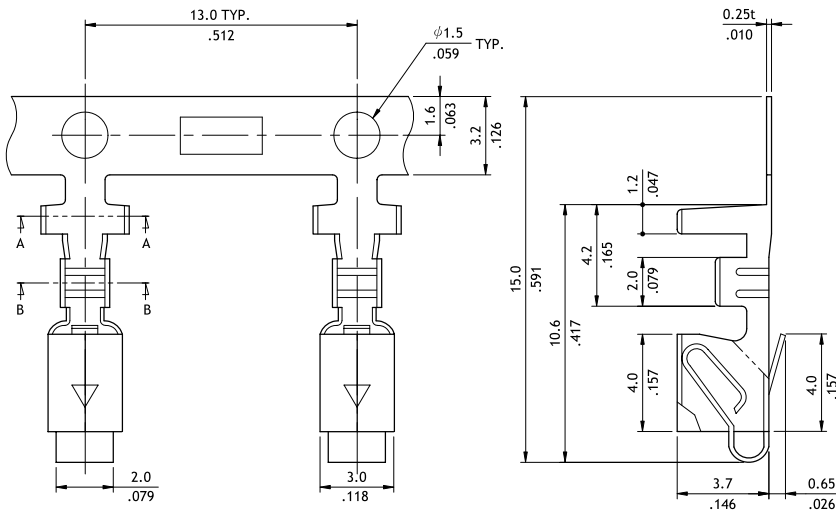
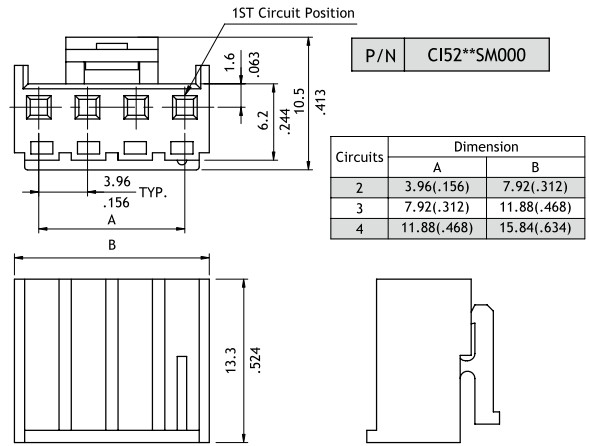

Part No.	Wire Range	Insulation Diameter	Reel Qty
CI52T021*E0	AWG #22-#28	1.90 (.075) MAX.	3,500 PCS
CI52T031*E0	AWG #18-#22	2.70 (.106) MAX.	3,500 PCS

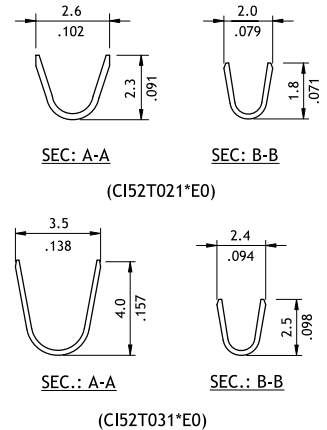

Ordering Code

1 **2** **3** **4**
CI52 12 S 0000

- 1** Series No.
- 2** No. of Circuits: 02 to 12
S = Connector housing
- 3** Other Options:
- 4** 0000 = Standard ; M000 = Special Type
*Special options consult manufacturer

1 **2** **3** **4** **5** **6**
CI52 T03 1 B E 0

- 1** Series No.
- 2** Type: T02 = AWG #22~#28
T03 = AWG #18~#22
- 3** Plating: 1 = Tin over Nickel
- 4** Material: B = Brass , P = Phosphor Bronze
- 5** Plating method: E = Pre-tinned
- 6** Other Options: 0 = Standard