

Typical 24,28,32,40 Circuits

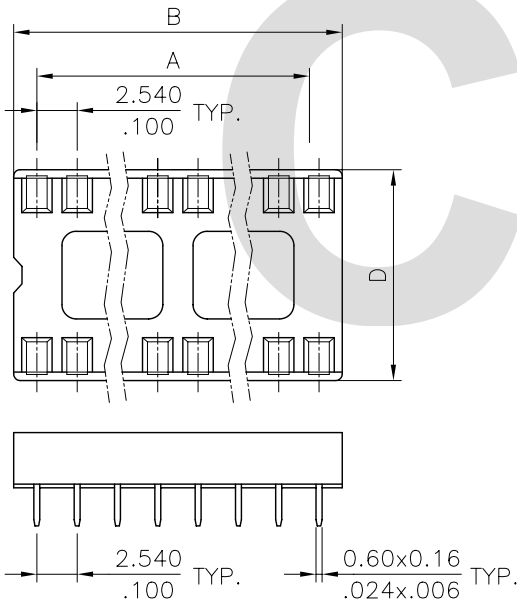

Typical 24,28,32,40,42,48 Circuits

Materials:

- * Insulator: Glass filled Polyester UL 94V-0, Color Black
- * Contact: Phosphor Bronze

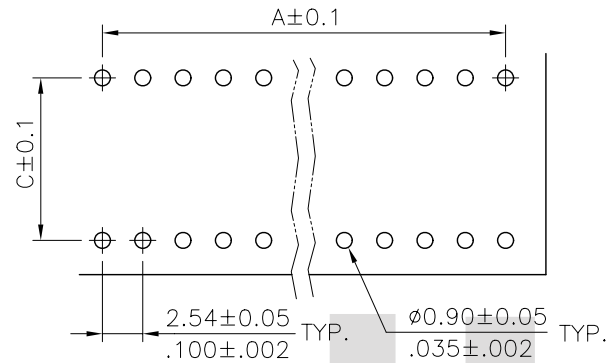

Recommended PC Board Layout

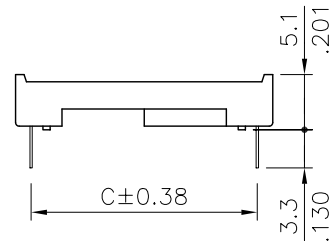

Ordering Code

CS05 ** 1 1 A 0*
 ① ② ③ ④ ⑤ ⑥

- ① Series No.
- ② No. of Circuits
- ③ Plating code:
 1 = 2.54μm(100μ") Min. Tin
 over 1.27μm(50μ") Nickel
- ④ Color: 1 = Black
- ⑤ Option:
 Please check details in Table
- ⑥ Other option: 00 = Standard
 0A = With Bracket

Circuits	CviLux P/N	Dimension			
		A	B	C	D
24	CS052411A00	27.94(1.100)	30.48(1.200)	15.24(.600)	17.5(.689)
	CS052411A0A				
28	CS052811A00	33.02(1.300)	35.56(1.400)	15.24(.600)	17.5(.689)
	CS052811A0A				
32	CS053211A00	38.10(1.500)	40.64(1.600)	15.24(.600)	17.5(.689)
	CS053211A0A				
40	CS054011A00	48.26(1.900)	50.80(2.000)	15.24(.600)	17.5(.689)
	CS054011A0A				
42	CS054211A0A	50.80(2.000)	53.34(2.200)	15.24(.600)	17.5(.689)
48	CS054811A0A	58.42(2.300)	60.96(2.400)	15.24(.600)	17.5(.689)

RoHS Compliant



4					DATE	UNIT: mm / inch	TITLE: 2.54MM(.100") DUAL IN LINE IC SOCKET	瀚荃股份有限公司 CviLux Corporation	
3				DRAWN BY: Karen	6/25-09'	TOLERANCE UNLESS OTHERWISE SPECIFIED	MATERIAL:		
2				ENGINEER: Eisley	6/30-09'	.X ± 0.30/.012 X' ± 1'	FINISH:	DRAWING NO. CS0504SA	PART NO. CS05**11A0*
1				CHECKED BY: David	6/30-09'	.XX ± 0.20/.008 X' ±		SCALE 2 / 1	SHEET 1 OF 1
SYM	NAME	DATE	REVISIONS	APPROVED BY: Alex	6/30-09'	.XXX ± 0.10/.004 X' ±			