

NOTE:

Material :

- \* Base : PPA With 33% GF.  
UL 94V-0
- \* Contact : Brass
- \* Tab: Copper alloy
- \* For Lead Free IR Reflow Process

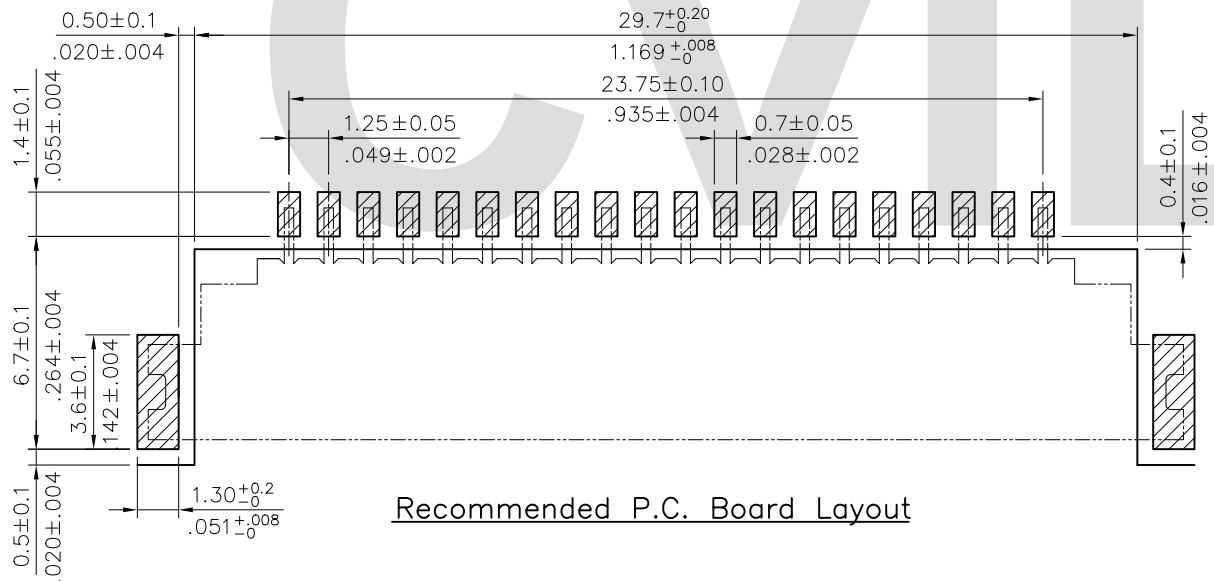
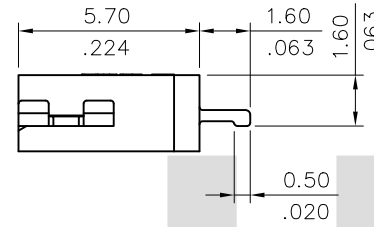
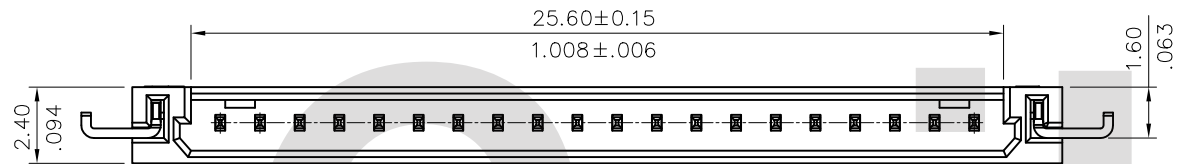
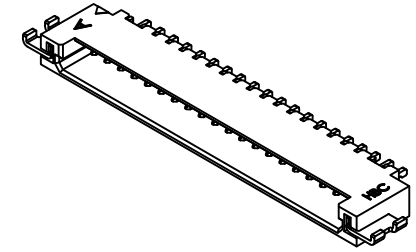

ORDERING CODE

CID5 20 D \* H R0 -NH

① ② ③ ④ ⑤ ⑥ ⑦

- ① Series No.
- ② Contact: 20
- ③ D= Offset Mid Mount Type
- ④ Plating :  
1= 3.05μm(120μ") Min. Matte Tin  
Plated over 1.27um(50u") Nickel
- ⑤ Type : H= Side entry
- ⑥ Packing option:  
R0= Tape & Reel Packing
- ⑦ -NH= For Lead Free IR Processes  
and Halogen-Free

Lead Free Process

Halogen-Free

RoHS compliant

CIVILUX CORP  
 2014.11.07  
 ISSUED

④					DATE	UNIT: mm / inch	TITLE: 1.25mm Side entry SMT Type Connector	 瀚荃股份有限公司 CviLux Corporation
③			DRAWN BY: Hank	10/15-14'	TOLERANCE UNLESS OTHERWISE SPECIFIED	.X ± 0.25/.010 X: ± 1'	MATERIAL:	
②			ENGINEER: Hank	10/15-14'				
①			CHECKED BY: Easley	11/17-14'	.XXX ± 0.10/.004 .XX ±	FINISH:	DRAWING NO. CID501SA PART NO. CID520D*HRO-NH	
SYM	NAME	DATE	REVISIONS	APPROVED BY: Easley	11/17-14'		SCALE 4 / 1	SHEET 1 OF 2

