

NOTE:

Material :

- * Base : High Temperature plastic UL 94V-0
- * Contact : Copper alloy
- * Fixed tab : Matte Tin plated over Nickel

ORDERING CODE

CI46 ** M 1 V * 0 -NH

① ② ③ ④ ⑤ ⑥ ⑦ ⑧

- ① Series No.
- ② Contact: 02 to 20
- ③ M= SMT TYPE HEADER
- ④ Plating :
1= Matte Tin plated over Nickel
2= Gold flash over 50u" Nickel
- ⑤ Type : V= Top entry
- ⑥ Packing option:
R= Tape & Reel Packing
- ⑦ Other option:
0= Standard
- ⑧ -NH= For Lead Free IR Processes and Halogen-Free

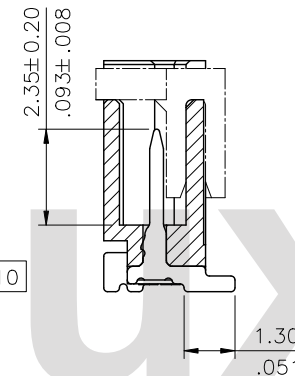
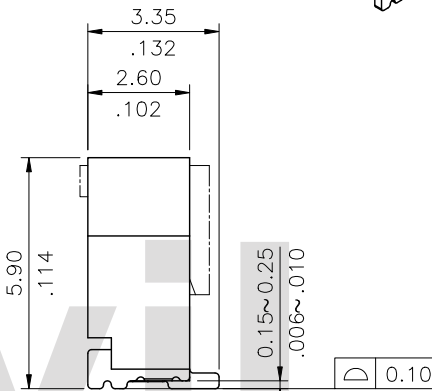
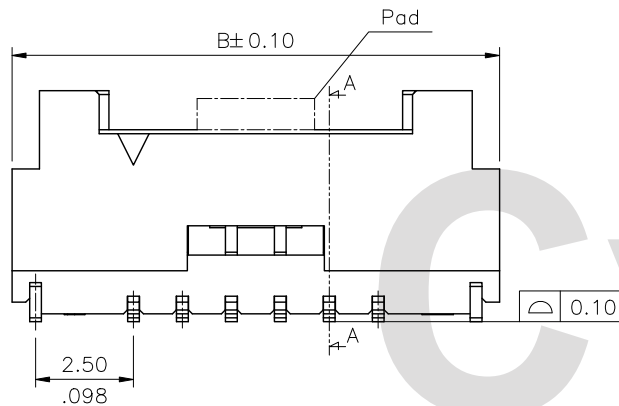

SEC. A-A

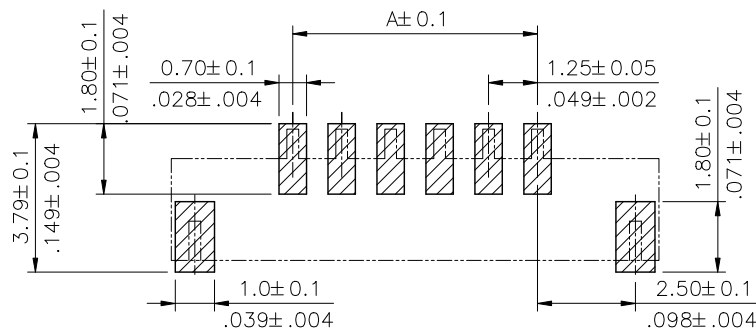

Recommended P.C. Board Layout

DIM. A = 1.25 x NO. OF SPACES
 DIM. B = DIM. A + 6.20
 DIM. C = DIM. A + 1.75
 * AVAILABLE IN 2 THROUGH 20

Halogen-Free

Lead Free Process

RoHS Compliant

4					DATE	UNIT: mm / inch	TITLE: 1.25mm Pitch WTB SMT V TYPE	 瀚荃股份有限公司 CviLux Corporation
3				DRAWN BY: Hank	5/8-13'	TOLERANCE UNLESS OTHERWISE SPECIFIED .X ± 0.30/.012 .X' ± 1" .XX ± 0.20/.008 .X" ± .XXX ± 0.10/.004 .XX" ±	MATERIAL:	
2				ENGINEER: Easley	5/8-13'		FINISH:	
1				CHECKED BY: Easley	5/8-13'		DRAWING NO. CI4609S1	PART NO. CI46**M1V*0-NH
SYM	NAME	DATE	REVISIONS	APPROVED BY: David	5/8-13'		SCALE 5 / 1	SHEET 1 OF 2

