



SERIES OR P/N	CIRCUITS	PACKING METHOD CODE	INNER PACKING NO.	INNER PACKING SIZE (CM)			INNER PACKING QTY	INSIDE CARTON NO.	INSIDE CARTON SIZE (CM)			PCS / INSIDE CARTON	CARTON NO.	CARTON SIZE (CM)			PCS / CARTON	G.W REF. (KG)
				L / D	W	H			L	W	H			L	W	H		
CF3104*D0RE/F-05-NH	4	D	PACK-CRCA120-NH-H	-	1.60	-	2000	PACK-RLCA01-NH-H	-	1.65	-	2000	PACK-CTC034-C/H	35.0	35.0	30.0	22000	
CF3106*D0RE/F-05-NH	6	D	PACK-CRCA93-NH-H	-	1.60	-	2000	PACK-RLCA01-NH-H	-	1.65	-	2000	PACK-CTC034-C/H	35.0	35.0	30.0	22000	
CF3108*D0RE/F-05-NH	8	D	PACK-CRCB439-NH-H	-	2.40	-	2000	PACK-RLCB01-NH-H	-	2.45	-	2000	PACK-CTC034-C/H	35.0	35.0	30.0	18000	
CF3110*D0RE/F-05-NH	10	D	PACK-CRCB411-NH-H	-	2.40	-	2000	PACK-RLCB01-NH-H	-	2.45	-	2000	PACK-CTC034-C/H	35.0	35.0	30.0	18000	
CF3112*D0RE/F-05-NH	12	D	PACK-CRCB369-NH-H	-	2.40	-	2000	PACK-RLCB01-NH-H	-	2.45	-	2000	PACK-CTC034-C/H	35.0	35.0	30.0	18000	
CF3114*D0RE/F-05-NH	14	D	PACK-CRCB385-NH-H	-	2.40	-	2000	PACK-RLCB01-NH-H	-	2.45	-	2000	PACK-CTC034-C/H	35.0	35.0	30.0	18000	
CF3115*D0RE/F-05-NH	15	D	PACK-CRCB440-NH-H	-	2.40	-	2000	PACK-RLCB01-NH-H	-	2.45	-	2000	PACK-CTC034-C/H	35.0	35.0	30.0	18000	
CF3116*D0RE/F-05-NH	16	D	PACK-CRCB371-NH-H	-	2.40	-	2000	PACK-RLCB01-NH-H	-	2.45	-	2000	PACK-CTC034-C/H	35.0	35.0	30.0	18000	
CF3118*D0RE/F-05-NH	18	D	PACK-CRCB441-NH-H	-	2.40	-	2000	PACK-RLCB01-NH-H	-	2.45	-	2000	PACK-CTC034-C/H	35.0	35.0	30.0	18000	
CF3119*D0RE/F-05-NH	19	D	PACK-CRCB399-NH-H	-	2.40	-	2000	PACK-RLCB01-NH-H	-	2.45	-	2000	PACK-CTC034-C/H	35.0	35.0	30.0	18000	
CF3120*D0RE/F-05-NH	20	D	PACK-CRCB442-NH-H	-	2.40	-	2000	PACK-RLCB01-NH-H	-	2.45	-	2000	PACK-CTC034-C/H	35.0	35.0	30.0	18000	
CF3122*D0RE/F-05-NH	22	D	PACK-CRCB443-NH-H	-	2.40	-	2000	PACK-RLCB01-NH-H	-	2.45	-	2000	PACK-CTC034-C/H	35.0	35.0	30.0	18000	
CF3124*D0RE/F-05-NH	24	D	PACK-CRCC111-NH-H	-	3.20	-	2000	PACK-RLCC01-NH-H	-	3.25	-	2000	PACK-CTC034-C/H	35.0	35.0	30.0	14000	
CF3126*D0RE/F-05-NH	26	D	PACK-CRCC115-NH-H	-	3.20	-	2000	PACK-RLCC01-NH-H	-	3.25	-	2000	PACK-CTC034-C/H	35.0	35.0	30.0	14000	
CF3128*D0RE/F-05-NH	28	D	PACK-CRCC112-NH-H	-	3.20	-	2000	PACK-RLCC01-NH-H	-	3.25	-	2000	PACK-CTC034-C/H	35.0	35.0	30.0	14000	
CF3130*D0RE/F-05-NH	30	D	PACK-CRCC118-NH-H	-	3.20	-	2000	PACK-RLCC01-NH-H	-	3.25	-	2000	PACK-CTC034-C/H	35.0	35.0	30.0	14000	
CF3132*D0RE/F-05-NH	32	D	PACK-CRCC135-NH-H	-	3.20	-	2000	PACK-RLCC01-NH-H	-	3.25	-	2000	PACK-CTC034-C/H	35.0	35.0	30.0	14000	
CF3140*D0RE/F-05-NH	40	D	PACK-CRCD124-NH-H	-	4.40	-	2000	PACK-RLCD01-NH-H	-	4.45	-	2000	PACK-CTC034-C/H	35.0	35.0	30.0	10000	
CF3142*D0RE/F-05-NH	42	D	PACK-CRCD142-NH-H	-	4.40	-	2000	PACK-RLCD01-NH-H	-	4.45	-	2000	PACK-CTC034-C/H	35.0	35.0	30.0	10000	

注：紙盤先用塑膠袋 (PACK-PBC013-H不打孔) 裝好后再裝入外箱,外箱中有紙板(PACK-STC008-H)兩塊、隔板(PACK-STC001-C/H)三個。

PACKING METHOD (包裝方式)：

1 PVC BAG (塑膠袋)
SIZE = L * W

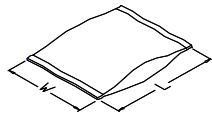

2 TUBE (塑膠管)
SIZE = L * W * H

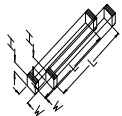

3 PVC TRAY (塑膠盒)
SIZE = L * W * H

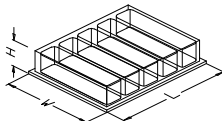

4 REEL (盤)
SIZE = D * W

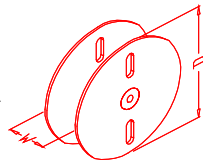

5 BOX (內紙盒)
SIZE = L * W * H

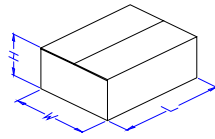

6 INSIDE CARTON (內箱)
SIZE = L * W * H

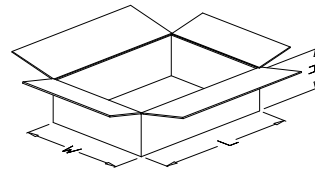

7 OUTSIDE CARTON (外箱)
SIZE = L * W * H

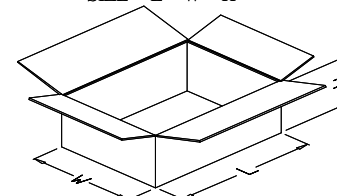

PACKING METHOD CODE (包裝方式代碼)：

- A = 1 → 7
- B = 2 → 7
- C = 3 → 7
- D = (4+1) → 7
- E = 5 → 7
- F = 1 → 6 → 7
- G = 2 → 6 → 7
- H = 3 → 6 → 7

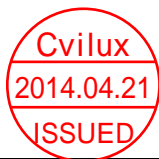

SERIES OR P/N	CIRCUITS	PACKING METHOD CODE	INNER PACKING NO.	INNER PACKING SIZE (CM)			INNER PACKING QTY	INSIDE CARTON NO.	INSIDE CARTON SIZE (CM)			PCS / INSIDE CARTON	CARTON NO.	CARTON SIZE (CM)			PCS / CARTON	G.W REF. (KG)
				L/D	W	H			L	W	H			L	W	H		
CF3104*D0RE/F-10-NH	4	D	PACK-CRCB368-NH-H	-	2.40	-	2000	PACK-RLCB01-C/-NH-H	-	2.45	-	2000	PACK-CTC034-C/H	35.0	35.0	30.0	18000	
CF3106*D0RE/F-10-NH	6	D	PACK-CRCB370-NH-H	-	2.40	-	2000	PACK-RLCB01-C/-NH-H	-	2.45	-	2000	PACK-CTC034-C/H	35.0	35.0	30.0	18000	
CF3108*D0RE/F-10-NH	8	D	PACK-CRCB438-NH-H	-	2.40	-	2000	PACK-RLCB01-C/-NH-H	-	2.45	-	2000	PACK-CTC034-C/H	35.0	35.0	30.0	18000	
CF3110*D0RE/F-10-NH	10	D	PACK-CRCB437-NH-H	-	2.40	-	2000	PACK-RLCB01-C/-NH-H	-	2.45	-	2000	PACK-CTC034-C/H	35.0	35.0	30.0	18000	
CF3114*D0RE/F-10-NH	14	D	PACK-CRCC134-NH-H	-	3.20	-	2000	PACK-RLCC01-C/-NH-H	-	3.25	-	2000	PACK-CTC034-C/H	35.0	35.0	30.0	14000	
CF3118*D0RE/F-10-NH	18	D	PACK-CRCD140-NH-H	-	4.40	-	2000	PACK-RLCD01-C/-NH-H	-	4.45	-	2000	PACK-CTC034-C/H	35.0	35.0	30.0	10000	
CF3120*D0RE/F-10-NH	20	D	PACK-CRCD121-NH-H	-	4.40	-	2000	PACK-RLCD01-C/-NH-H	-	4.45	-	2000	PACK-CTC034-C/H	35.0	35.0	30.0	10000	
CF3122*D0RE/F-10-NH	22	D	PACK-CRCD137-NH-H	-	4.40	-	2000	PACK-RLCD01-C/-NH-H	-	4.45	-	2000	PACK-CTC034-C/H	35.0	35.0	30.0	10000	
CF3124*D0RE/F-10-NH	24	D	PACK-CRCD141-NH-H	-	4.40	-	2000	PACK-RLCD01-C/-NH-H	-	4.45	-	2000	PACK-CTC034-C/H	35.0	35.0	30.0	10000	
CF3126*D0RE/F-10-NH	26	D	PACK-CRCD112-NH-H	-	4.40	-	2000	PACK-RLCD01-C/-NH-H	-	4.45	-	2000	PACK-CTC034-C/H	35.0	35.0	30.0	10000	
CF3130*D0RE/F-10-NH	30	D	PACK-CRCE33-NH-H	-	5.60	-	2000	PACK-RLCE01-C/-NH-H	-	5.65	-	2000	PACK-CTC034-C/H	35.0	35.0	30.0	8000	
注：紙盤先用塑膠袋 (PACK-PBC013-H不穿孔) 裝好后再裝入外箱,外箱中有紙板(PACK-STC008-H)兩塊、隔板(PACK-STC001-C/H)三個。																		

PACKING METHOD (包裝方式) :

1 PVC BAG (塑膠袋)
SIZE = L * W

2 TUBE (塑膠管)
SIZE = L * W * H

3 PVC TRAY (塑膠盒)
SIZE = L * W * H

4 REEL (盤)
SIZE = D * W

5 BOX (內紙盒)
SIZE = L * W * H

6 INSIDE CARTON (內箱)
SIZE = L * W * H

7 OUTSIDE CARTON (外箱)
SIZE = L * W * H

PACKING METHOD CODE (包裝方式代碼) :

- A = 1 → 7
- B = 2 → 7
- C = 3 → 7
- D = (4+1) → 7
- E = 5 → 7
- F = 1 → 6 → 7
- G = 2 → 6 → 7
- H = 3 → 6 → 7