

NOTE:

- Material:  $\triangle$   
 Base: Nylon 6T + 30% GF. UL 94V-0  
 ,Color Nature  
 Contact: Phosphor Bronze,  
 with Matte Tin plated  
 Tab: Brass, with Matte Tin plated  
 $\triangle$  PAD: Nylon 6T + 30% GF. UL 94V-0  
 ,Color Nature
- For Lead Free IR Reflow Process

**ORDERING CODE**

CI11 \*\* M 1 V R0 - LF  
 ① ② ③ ④ ⑤ ⑥ ⑦

- ① Series No.
- ② Contacts:
- ③ M= SMT type header
- ④ Plating:  
 1= 100 $\mu$ " Min. Matte Tin Plated  
 over 50 $\mu$ " Nickel  
 2= Gold flash plated over  
 1.27 $\mu$ m(50 $\mu$ " ) Nickel
- ⑤ Type: V= Straight
- ⑥ Other option:  
 R0= Tape & reel packing  
 (With pick & place pad)(Standard)  
 RN= Tape & reel packing  
 (without pack & place pad)  
 T0= Tube packing  
 (without pack & place pad)
- ⑦ LF= For Lead Free IR Process

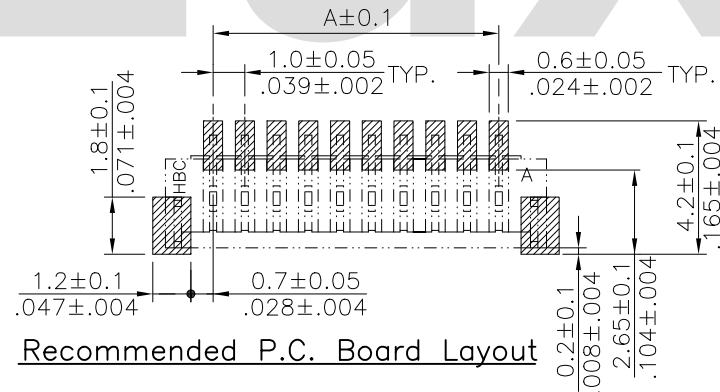
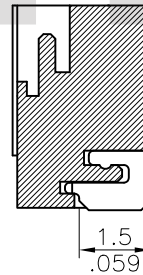
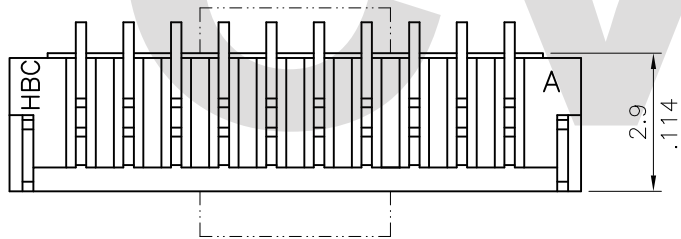
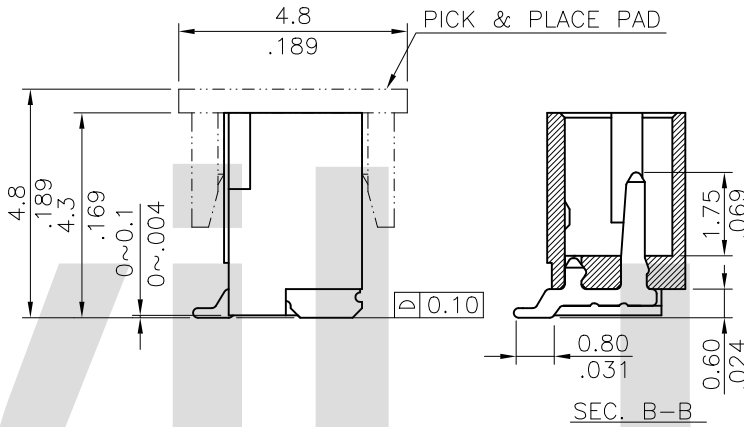
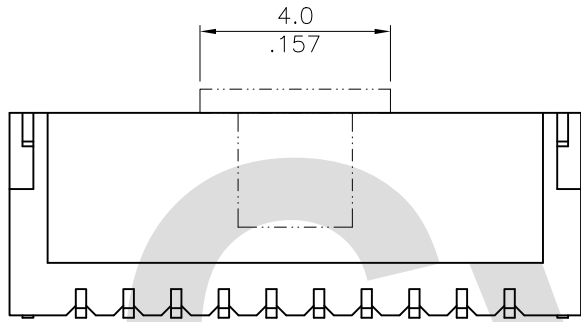

DIM. A = 1.00 x NO. OF SPACES  
 DIM. B = DIM. A + 3.0

\* AVAILABLE IN 2 THROUGH 18,20 AND 26 CIRCUITS

Lead Free Process

RoHS Compliant

$\triangle$ 11	Enya	11/11-13'	ECNT113103/ECRB113027		DATE	UNIT: mm / inch	TITLE: 1.00MM(.079")	瀚荃股份有限公司 CviLux Corporation
$\triangle$ 10	Sun	7/05-11'	ECR10039-2/ECN11060	DRAWN BY: Enya	11/11-13'	TOLERANCE UNLESS OTHERWISE SPECIFIED	WIRE TO BOARD CONNECTOR	
$\triangle$ 9	Sandy	2/19-09'	ECN09066/ECR08097-0	ENGINEER: Sun	11/13-13'	.X ± 0.30/.012 X' ± 1'	MATERIAL:	DRAWING NO. CI1113SK PART NO. CI11**M*V**--LF
$\triangle$ 8	Sandy	9/4-08'	ECN08430	CHECKED BY: Eisley	11/15-13'	.XX ± 0.20/.008 X' ±	FINISH:	
SYM	NAME	DATE	REVISIONS	APPROVED BY: Eisley	11/15-13'	.XXX ± 0.10/.004 XX' ±	SCALE	6 / 1 SHEET 1 OF 2



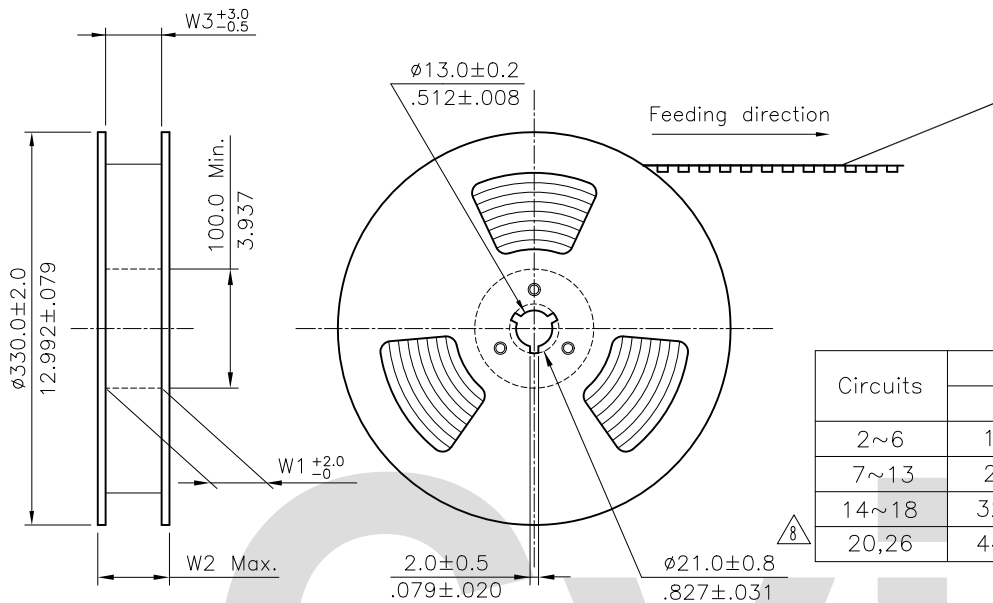

NOTE :

- △10 \* Reel Material : Corrugated Paper
- \* Carrier Material : Clear, Conductive Polystyrene Alloy
- \* Cover Tape Material : Polyester
- \* Cover Tape Peel Strength : 0.1N – 1.3N
- \* Carrier camber is within 1mm in 100mm
- \* All dimensions meet EIA-481-2 & EIA-481-3 requirements.
- \* Quantity : 1000 PCS/Reel

Circuits	Dimension					Packing (Reel/Caton)
	E	F	W1	W2	W3	
2~6	16.0(.630)	-	16.5(.650)	22.5(.886)	16.5(.650)	11
7~13	24.0(.945)	-	24.5(.965)	30.5(1.201)	24.5(.965)	9
14~18	32.0(1.260)	28.40(1.118)	32.5(1.280)	38.5(1.516)	32.5(1.280)	7
20,26	44.0(1.732)	40.40(1.591)	44.5(1.752)	50.5(1.988)	44.5(1.752)	5

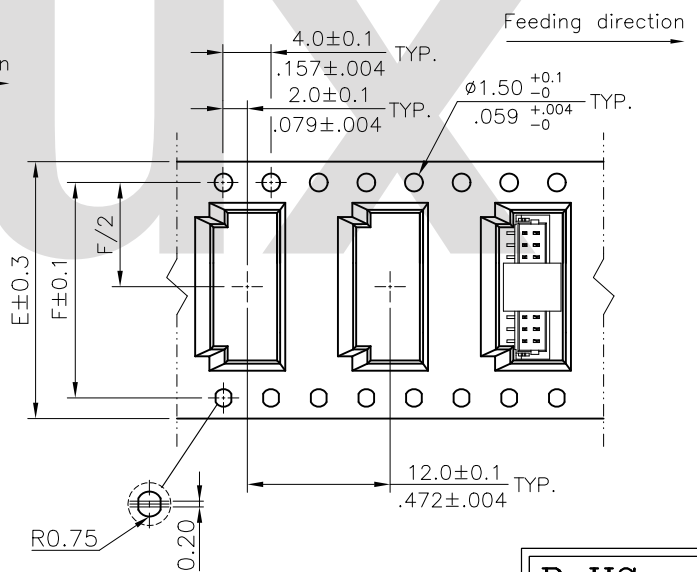
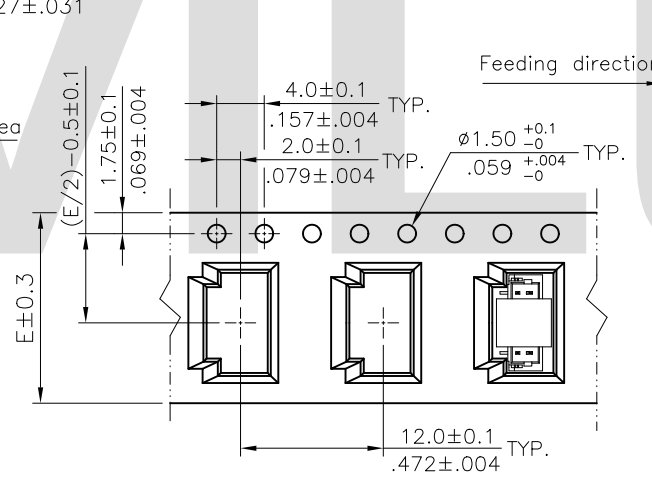
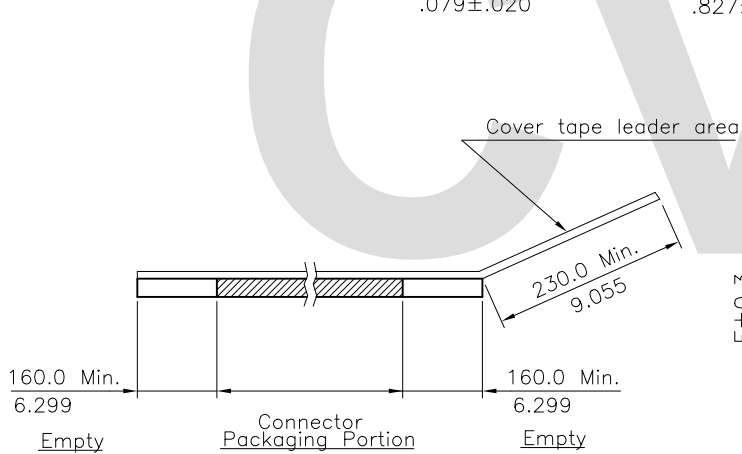

WIDTH : 16.24 mm Carrier

WIDTH : 32.44 mm Carrier

RoHS Compliant

△11	Enya	11/11-13'	ECNT113103/ECRB113027		DATE	UNIT: mm / inch	TITLE: 1.00MM(.079")	瀚荃股份有限公司 CviLux Corporation
△10	Sun	7/05-11'	ECR10039-2/ECN11060	DRAWN BY: Enya	11/11-13'	TOLERANCE UNLESS OTHERWISE SPECIFIED	WIRE TO BOARD CONNECTOR	
△9	Sandy	2/19-09'	ECN09066/ECR08097-0	ENGINEER: Sun	11/13-13'	.X ±	X' ± 1'	MATERIAL:  FINISH:
△8	Sandy	9/4-08'	ECN08430	CHECKED BY: Eisley	11/15-13'	.XX ±	.X' ±	
SYM	NAME	DATE	REVISIONS	APPROVED BY: Eisley	11/15-13'	.XXX ±	.XX' ±	DRAWING NO. <b>CI1113SK</b> PART NO. <b>CI11**M*V**--LF</b> SCALE SHEET 2 OF 2

CVILUX CORP  
 2013.11.25  
 ISSUED