

Recommended P.C. Board Layout

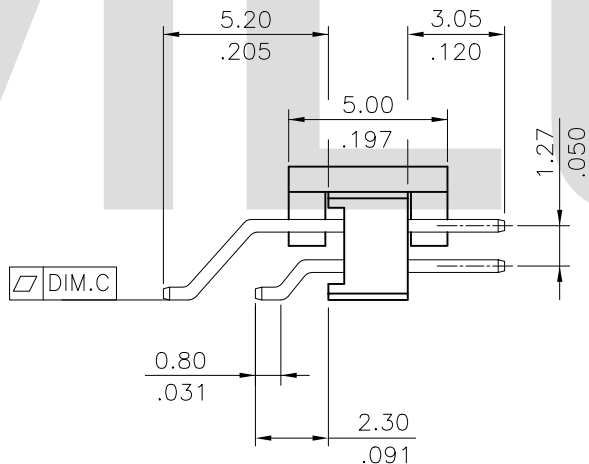

DIM. A = 1.27 X No. of Spaces  
 DIM. B = DIM. A + 1.27

\* Available in 4 through 100 Circuits

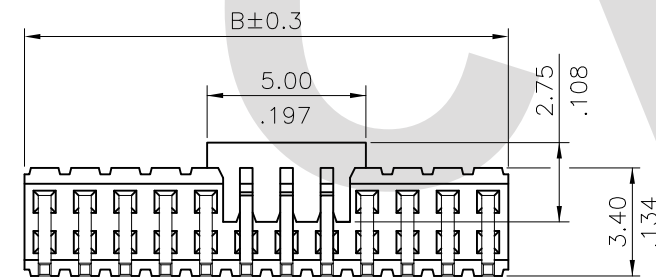
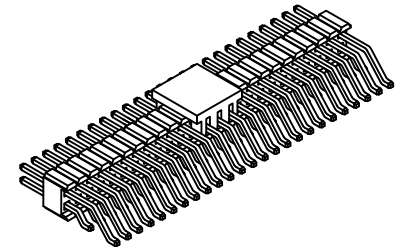

Notes:

- \* Material:  
Contact: Brass
- \* For Lead-Free IR Reflow process

PIN	DIM.C
4~50	0.10
52~100	0.15

Ordering Code

CH60 \*\* 2 S A 00 -T0  
 ① ② ③ ④ ⑤ ⑥ ⑦

- ① Series No.
- ② No. of Circuits: 04 to 100 (X1=100)
- ③ Plating Code:  
2= Gold flash plated over Nickel
- ④ S= Right angle SMT Type
- ⑤ Insulation:  
A= Nylon 6T UL 94V-0, Color Black
- ⑥ Pin Length Option code:
- ⑦ -T0 = Tube Packing

Lead Free Process

RoHS compliant

SYM	NAME	DATE	REVISIONS	APPROVED BY:	Eisley	2/24-15'	UNIT: mm / inch	TITLE: 1.27MMx1.27MM RIGHT ANGLE DUAL ROW BOARD MOUNT PIN HEADER
4							TOLERANCE UNLESS OTHERWISE SPECIFIED	MATERIAL:
3								
2							.X ± 0.30 / .012    .X' ± 1"	FINISH:
1								
							.XX ± 0.20 / .008    .X' ±	
							.XXX ± 0.10 / .004    .XX' ±	

CVILUX CORP  
 2015.02.26  
 ISSUED



瀚荃股份有限公司  
 CviLux Corporation

DRAWING NO.	CH6001SA	PART NO.	CH60**2SA00-T0
SCALE	3 / 1	SHEET	1 OF 1