

CI11 Series 1.00mm(.039") Dual Row Wire to Board Housing & Terminal

- ⊙ Insulator: Polyester UL 94V-0, Color Nature
- ⊙ Terminal: Tin plated, Phosphor Bronze
- ⊙ Mate with CI11 headers
- ⊙ Compact design
- ⊙ Protrusions design for easy pull out

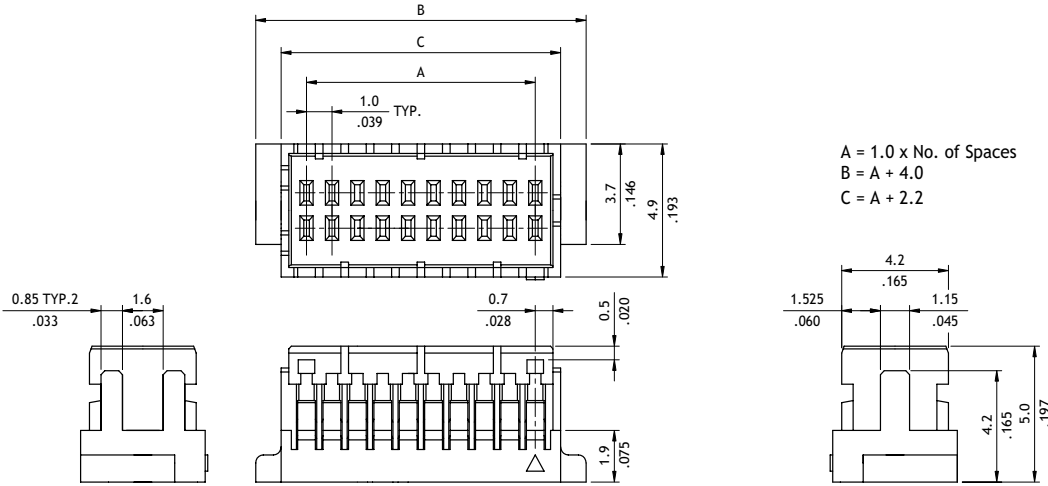

A = 1.0 x No. of Spaces
 B = A + 4.0
 C = A + 2.2

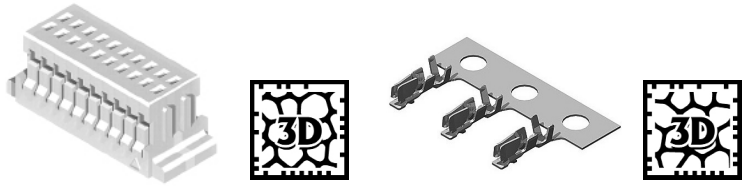
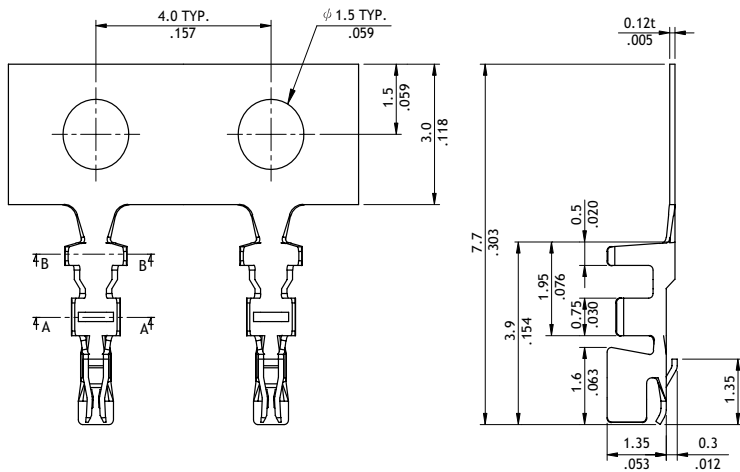

Wire Range	Insulation Diameter	Reel Qty
AWG #28-#32	0.4-0.8(mm) (.016-.031)	16,000 PCS

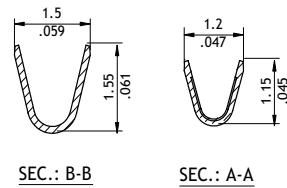

Ordering Code

1 2 3 4 5 6 **1 2 3 4 5 6**
CI11 50 S D 000 - NH **CI11 T01 1 P P H**

- ① Series No.
- ② No. of Circuits: 14, 16, 20, 30, 40, 50
- ③ S = Housing
- ④ D = Dual Row Type
- ⑤ Other Options: 000 = Standard
 *Special options consult manufacturer
- ⑥ -NH = Halogen-Free

- ① Series No.
- ② Type: T01 = AWG #28 ~ #32
- ③ Plating Code: 1 = Tin over Nickel
- ④ Material: P = Phosphor Bronze
- ⑤ Plating Method: P = Post Plating
- ⑥ Other Options:
 H = Low Single contact force