

## CS09 Series 2.54mm(.100") Single in Line Adapter Strip

- Machined contact
- Highly reliable board interconnecting

RoHS Compliant 

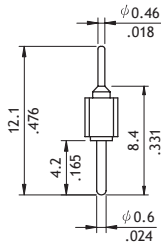
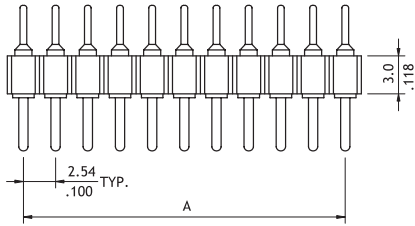
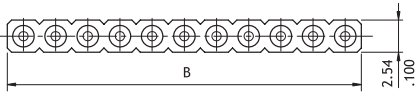
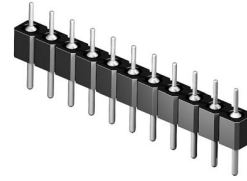

$A = 2.54 * \text{No. of Spaces}$   
 $B = A + 2.44$

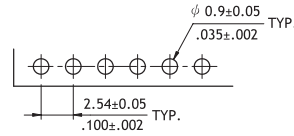

Recommended P.C. Board Layout

### Ordering Code

**1**      **2**      **3**      **4**      **5**  
**CS09**   **40**   **2**   **1**   **A00**

- 1** Series No.
- 2** No. of Circuits: 02 to 40
- 3** Plating Code: 2 = Gold flash over Nickel
- 4** Color: 1 = Black
- 5** Other Options:  
 A00 = Standard  
 \*Special options consult manufacturer

## CS10 Series 2.54mm(.100") Single in Line SIP Socket

- High reliability screwed machined terminals with multiple finger contacts
- Sealed and prevent flux wicking
- Insulator: PPS UL 94V-0
- Contact: Gold plated Beryllium copper

RoHS Compliant

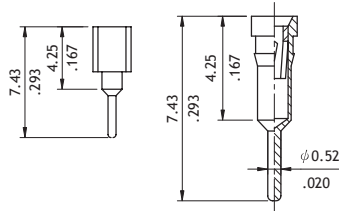
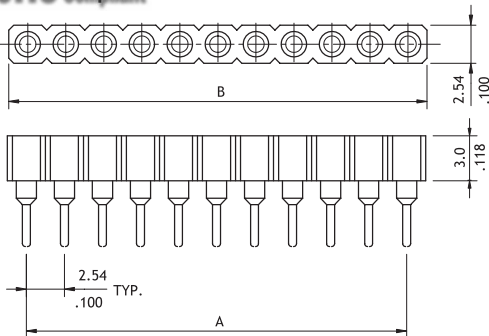
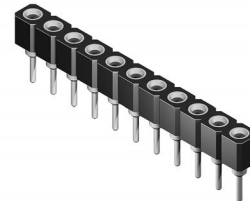

Pin detail

$A = 2.54 * \text{No. of Spaces}$   
 $B = A + 2.44$

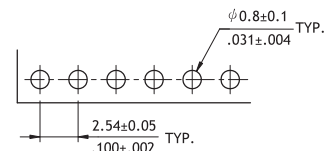

Recommended P.C. Board Layout

### Ordering Code

**1**      **2**      **3**      **4**      **5**  
**CS10**   **40**   **D**   **1**   **000**

- 1** Series No.
- 2** No. of Circuits: 04 to 80
- 3** Plating Code: D = Tin plated sleeve with Gold flash plated contact
- 4** Color: 1 = Black
- 5** Other Options:  
 000 = Standard  
 \*Special options consult manufacturer