

CB91 Series 2.54mm(.100") Dual Row Female Headers

⊙ Mates with CH81, CH84 and CH85 series

RoHS Compliant

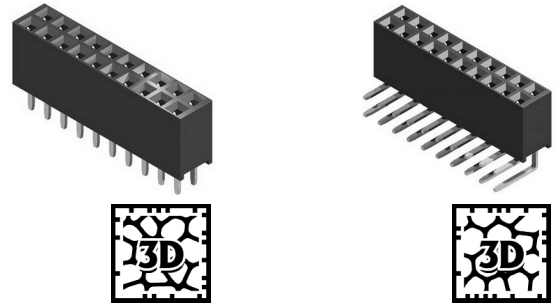

P/N CB91**2V100

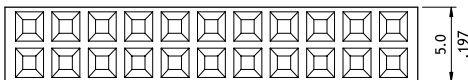

$$A = 2.54 * \text{No. of Spaces}$$

$$B = A + 3.04$$

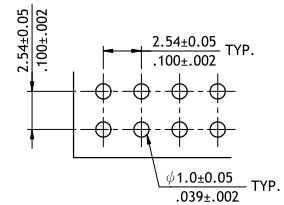
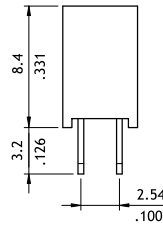
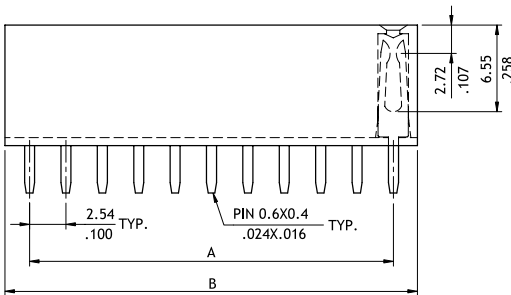

Recommended P.C. Board Layout

P/N CB91**2H100

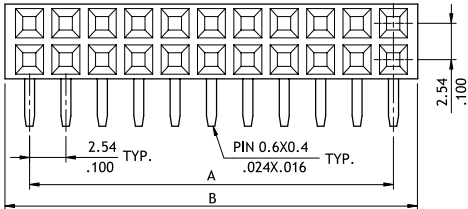

$$A = 2.54 * \text{No. of Spaces}$$

$$B = A + 3.0$$

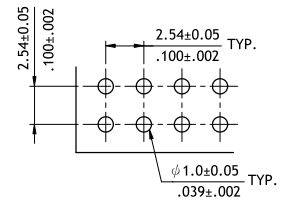
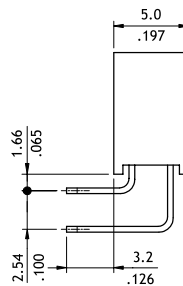
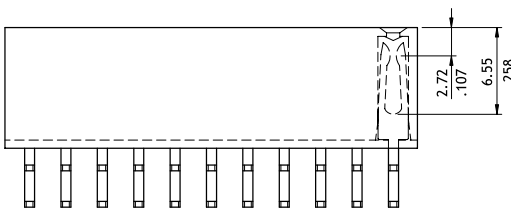

Recommended P.C. Board Layout

Ordering Code

1 **2** **3** **4** **5** **6**
CB 9 1 **8 0** **2** **V** **1** **0 0**

- 1** Series No.
- 2** No. of Circuits: 04 to 50, 60, 64, 66, 80
- 3** Plating Code:
2 = Gold flash over Nickel
- 4** Tail Style: V = Vertical
H = Right Angle

- 5** Color: 1 = Black
- 6** Other Options:
00 = Standard
*Special options consult manufacturer