

CA31 Series 1.27mm(.050") Flat Cable - IDC DIP Plugs

⊙ Can be used CW03 1.27mm(.050") Center Spacing flat ribbon cable

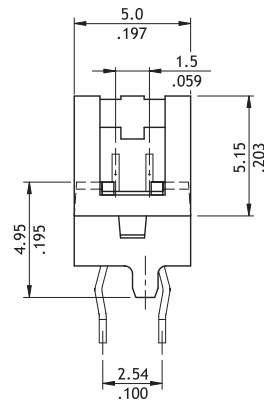

A= 1.27 x No. of Spaces
 B= A + 3.3
 C= A + 2.1
 D= A + 4.7

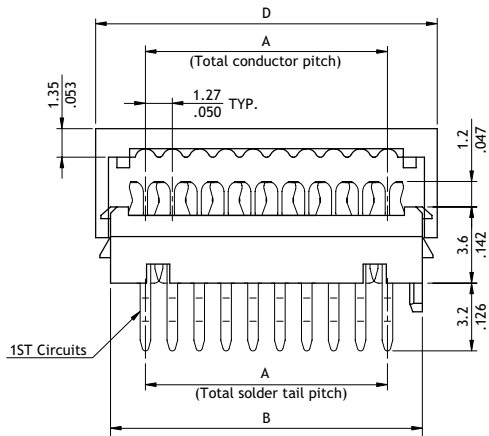
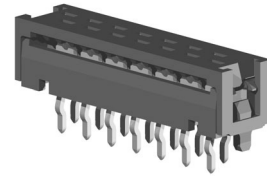
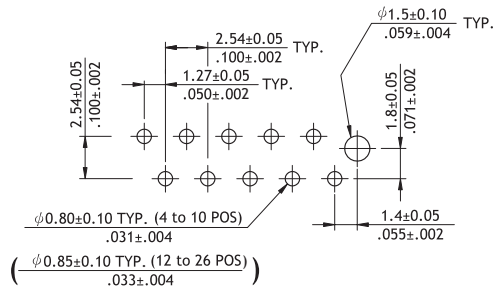
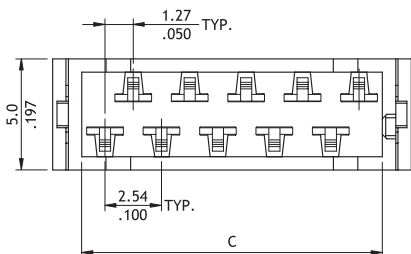

Recommended P.C. Board Layout

Ordering Code

① CA 3 1 ② 2 6 ③ P ④ 1 ⑤ 3 ⑥ 0 0

- ① Series No.
- ② No. of Circuits: 04 to 26
- ③ Contact Type: P = Plug
- ④ Plating Code:
 1 = Matte Tin over Nickel
 *Optional plating available but MOQ requested

- ⑤ Color: 3 = Red
- ⑥ Other Options:
 00 = Standard
 *Special options consult manufacturer