

CP05 Series 3.50mm (.138") High Voltage DIP Latch Type Connectors

- Current Rating: 1.0A AC/DC (AWG #24)
- Voltage Rating: 1400V AC/DC
- Insulator: High temperature plastic UL 94V-0, Color Nature
- Terminal: Tin plated Brass

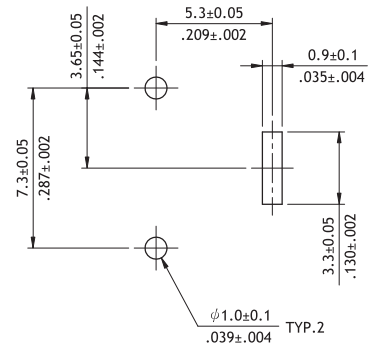
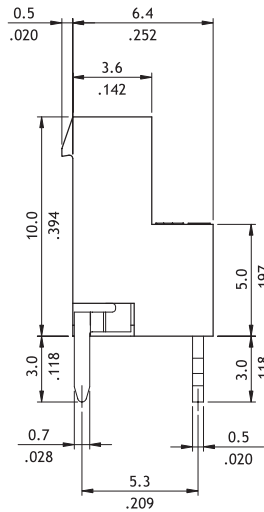
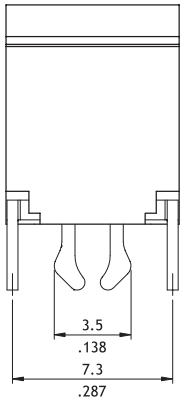
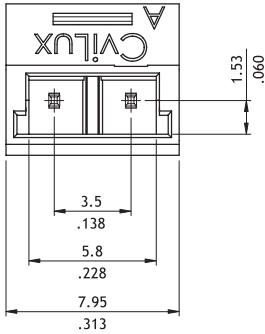

Recommended P.C. Board Layout

Ordering Code

① CP05 ② 02 ③ P ④ 1 ⑤ V ⑥ L ⑦ 0 - ⑧ NH

- ① Series No.
- ② No. of Circuits: 02
- ③ P = Header
- ④ Plating: 1 = Matte Tin over Nickel
- ⑤ Contact Type: V = Straight DIP Type
- ⑥ Type: L = Latch Type
- ⑦ Other Options:
0 = Standard
- ⑧ -LF = For Lead Free soldering process
-NH = For Lead Free soldering process and Halogen-Free