

Wire Range	Insulation Diameter	Reel Q'ty
AWG #18x(3~4)	2.05 (.079) MAX	3,500 PCS

Ordering Code:

CT11 TA3 1 P E 0  
 ① ② ③ ④ ⑤ ⑥

- ① Series No.
- ② Type: TA3= AWG #18x(3~4)
- ③ Plating: 1= 2.03μm(80μ") Min. Tin over 0.76μm(30μ") Nickel
- ④ Material: P= Phosphor Bronze
- ⑤ Plating method: E= Pre-tinned
- ⑥ Option: 0= Standard

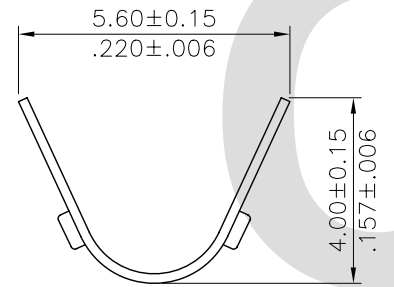

SEC:A-A

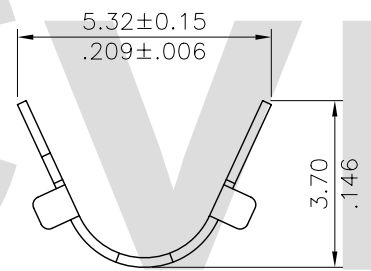

SEC:B-B

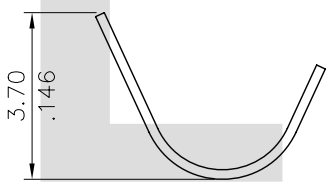

SEC:C-C

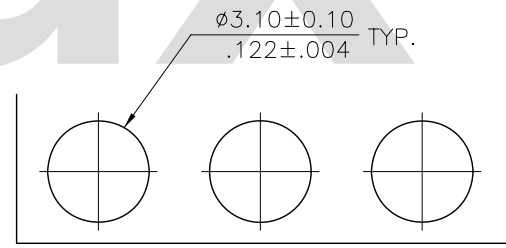

Recommended P.C. Board Layout

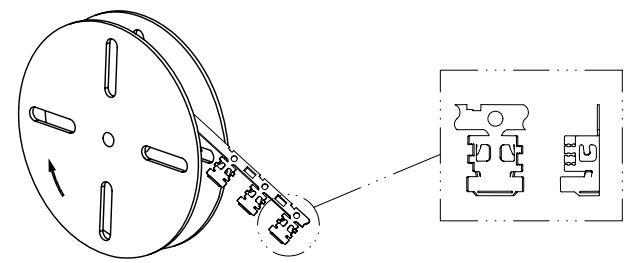

電鍍後捲料方向

CVILUX CORP.  
 2005.03.29  
 ISSUED

RoHS Compliant

4					DATE	UNIT: mm / inch	TITLE:	瀚荃股份有限公司 CviLux Corporation
3				DRAWN BY: Sun	3/24/05'	TOLERANCE UNLESS OTHERWISE SPECIFIED	BOARD IN TERMINAL	
2				ENGINEER: Eisley	3/24/05'	.X ± 0.20/.008 X* ± 1'	MATERIAL:	
1	SUN	3/22/05'	ECN05104	CHECKED BY: David	3/24/05'	.XX ± 0.10/.004 X* ±	FINISH:	
SYM	NAME	DATE	REVISIONS	APPROVED BY: Alex	3/24/05'	.XXX ± 0.05/.002 XX* ±		DRAWING NO. CT1101SD PART NO. CT11TA31PE0 SCALE 6 / 1 SHEET 1 OF 1