

Ordering Code:

CP35 TN* * P EP
 ① ② ③ ④ ⑤

- ① Series No.
- ② Accept wire gage:
 TN1= AWG #26 ~ #30
 TN2= AWG #20 ~ #24
- ③ Plating code:
 1= Tin plated over Nickel
 A= Selective Gold flash plated over 50μ" Nickel
 B= Selective 15μ" Gold plated over 50μ" Nickel
 C= Selective 30μ" Gold plated over 50μ" Nickel
- ④ Material : P= Phosphor Bronze
- ⑤ Style: EP= Plug terminal

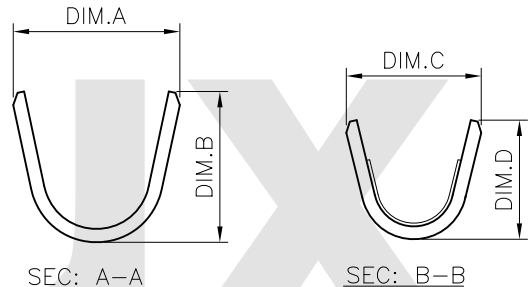
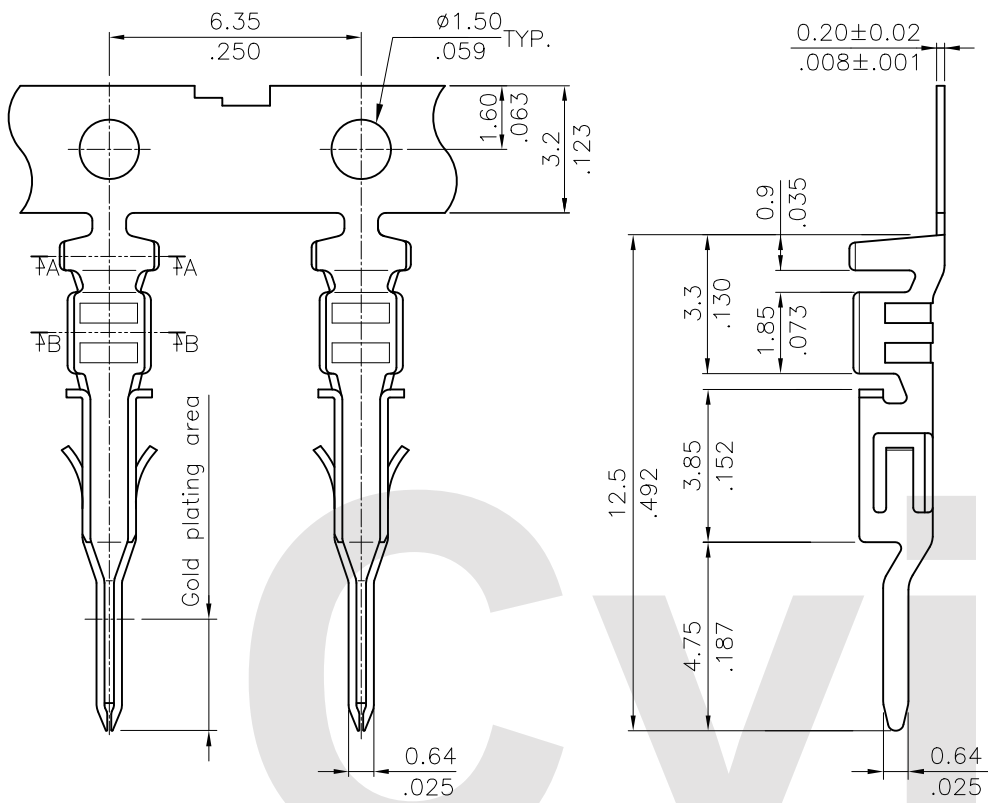

P/N	Wire Gauge	Insulation Diameter	Finish	Reel Q'TY
CP35TN11PEP	AWG#26~#30	1.35 (.053) MAX.	2.03μm (80μinch) Min. Tin plated over 0.76μm (30μinch) Nickel	12,000 PCS
CP35TN21PEP	AWG#20~#24	2.50 (.098) MAX.		
CP35TN1APEP	AWG#26~#30	1.35 (.053) MAX.	Selective gold flash on surface contact area over 1.27μm (50μinch) Nickel	
CP35TN2APEP	AWG#20~#24	2.50 (.098) MAX.		
CP35TN1BPEP	AWG#26~#30	1.35 (.053) MAX.	Selective 0.38μm (15μinch) gold on surface contact area over 1.27μm (50μinch) Nickel	
CP35TN2BPEP	AWG#20~#24	2.50 (.098) MAX.		
CP35TN1CPEP	AWG#26~#30	1.35 (.053) MAX.	Selective 0.76μm (30μinch) gold on surface contact area over 1.27μm (50μinch) Nickel	
CP35TN2CPEP	AWG#20~#24	2.50 (.098) MAX.		

P/N	DIM.A	DIM.B	DIM.C	DIM.D
CP35TN1*PEP	2.1 (.083)	1.9 (.075)	1.7 (.067)	1.5 (.059)
CP35TN2*PEP	2.5 (.098)	2.4 (.094)	2.1 (.083)	2.0 (.079)

RoHS Compliant

④	Sun	6/23-16'	ECRB116035/ECNT116136	DATE	UNIT: mm / inch	TITLE:	瀚荃股份有限公司 CviLux Corporation
③	Enya	11/07-13'	ECNT113108/ECNT113091/ECRT113022	DRAWN BY: Sun	7/11-16'	CP35 MALE CRIMP TERMINAL	
②	Sandy	3/17-08'	ECN08140	ENGINEER: Sun	7/11-16'	MATERIAL:	DRAWING NO. CP3504SI PART NO. CP35TN**PEP
①	Jim	10/26 06'	ECN06396	CHECKED BY: Eisley	7/12-16'	FINISH:	
SYM	NAME	DATE	REVISIONS	APPROVED BY: Eisley	7/12-16'		SCALE 5 / 1 SHEET 1 OF 1

CVILUX CORP
 2016.07.14
 ISSUED