

Part No.	Wire Range	Insulation Diameter	Reel Q'ty
CP31T031BEP	AWG #20~#24	2.48 (.098) MAX.	5,000 PCS.
CP31T041BEP	AWG #16~#20	3.50 (.138) MAX.	3,500 PCS.

Ordering Code:

CP31 T0\* 1 B E P  
 ① ② ③ ④ ⑤ ⑥

- ① Series No.
- ② Accept wire gage:  
 T03= AWG #20 ~ #24  
 T04= AWG #16 ~ #20
- ③ Plating code:  
 1= 2.03μm(80μ") Tin over 0.76μm(30μ") Nickel
- ④ Material : B= Brass
- ⑤ Plating method: E= Pre-tinned
- ⑥ Style: P= Plug terminal

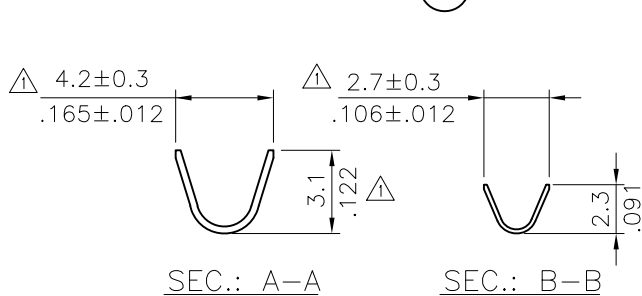

(P/N: CP31T031BEP)

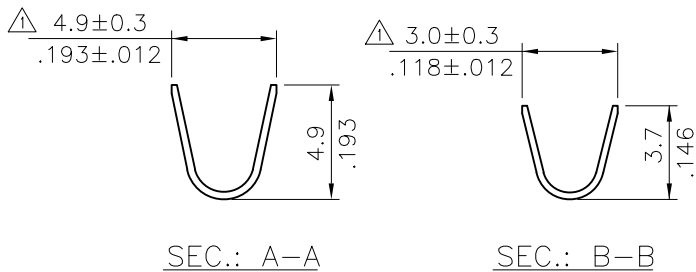

(P/N: CP31T041BEP)

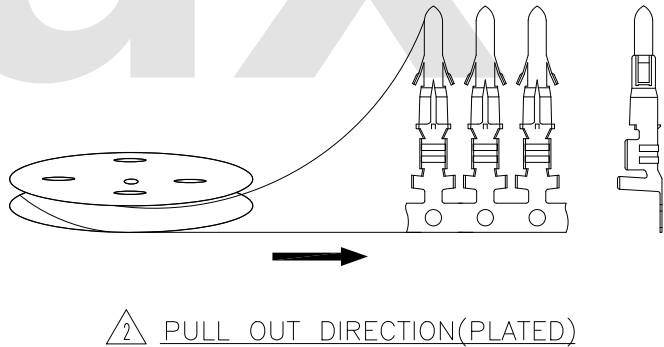

RoHS Compliant

④					DATE	UNIT: mm / inch	TITLE:	瀚荃股份有限公司 CviLux Corporation
③				DRAWN BY: Karen	6/22-15'	TOLERANCE UNLESS OTHERWISE SPECIFIED	CRIMP CLIP TERMINAL	
②	Karen	6/13-15'	ECNT115140/ECRT115017	ENGINEER: Sun	6/23-15'	.X ± 0.20/.008 X' ± 1'	MATERIAL:	
①	SUN	4/05/04'	ECN04128/ECRO4033-0	CHECKED BY: Eisley	6/23-15'	.XX ± 0.10/.004 X' ±	FINISH:	
SYM	NAME	DATE	REVISIONS	APPROVED BY: Eisley	6/23-15'	.XXX ± 0.05/.002 XX' ±		DRAWING NO. CP3103SF
								PART NO. CP31T0*1BEP
								SCALE 5 / 1
								SHEET 1 OF 1

**CVILUX CORP**  
 2015.07.02  
 ISSUED