

Material:

- * Insulation: PBT+30%GF. UL 94V-0, Color Black
- * Contact: Phosphor Bronze
- * Latch: Stainless Steel

P/N	DIM.A	Accept wire gage
CI94PFIA1AL	0.75	AWG #18
CI94PFIA1BL	0.60	AWG #20~#22

Ordering Code:

CI94 P FI A 1 A L
① ② ③ ④ ⑤ ⑥ ⑦

- ① Series No.
- ② P= Power
- ③ FI= Female IDC TYPE
- ④ Plating code:
A= Selective Gold flash plated over 1.27μm(50μ") Nickel
B= Selective 0.38μm(15μ") Gold plated over 1.27μm(50μ") Nickel
C= Selective 0.76μm(30μ") Gold plated over 1.27μm(50μ") Nickel
- ⑤ Color: 1= Black
- ⑥ Type: A= Accept AWG#18
B= Accept AWG#20~#22
- ⑦ Other option: L= With Latch

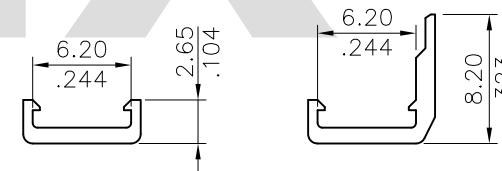
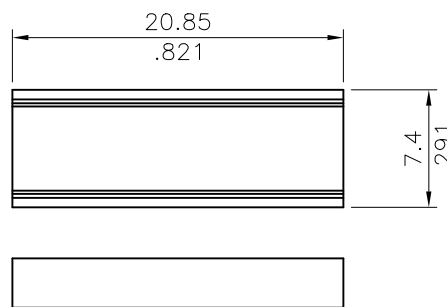
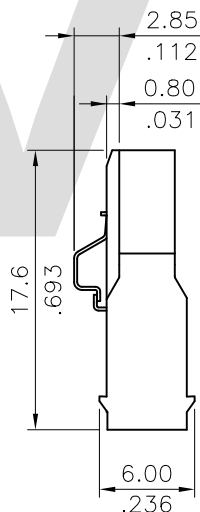
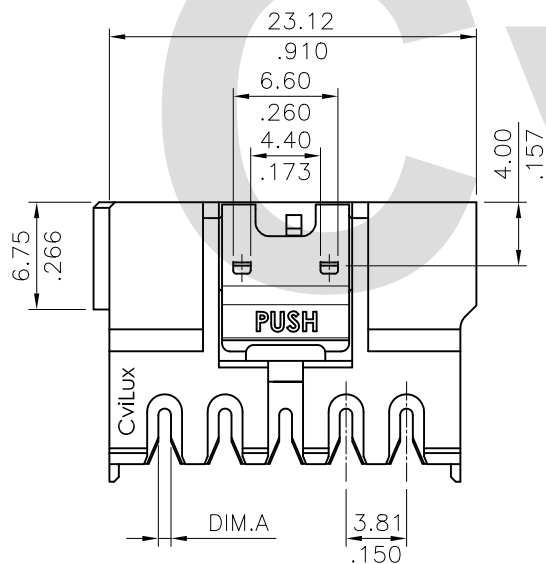

P/N:CI94PFIC010
(Through Cover)

P/N:CI94PFIC012
(One End Cover)

Tin-Lead Process

RoHS compliant

SYM	NAME	DATE	REVISIONS	APPROVED BY:	DATE	UNIT: mm / inch	TITLE: SERIAL ATA POWER IDC TYPE RECEPTACLE CONN.(LATCH)
⑩	Sandy	4/29-14'	ECNT114076			UNIT: mm / inch	MATERIAL: FINISH:
⑨	Sandy	11/10-10'	ECN10365	DRAWN BY: Sandy	4/29-14'	TOLERANCE UNLESS OTHERWISE SPECIFIED	
⑧	Hank	1/20-09'	ECN09030	ENGINEER: Eisley	4/30-14'	.X ± 0.30/.012 X: ± 1"	
⑦	Sandy	12/11-08'	ECN08607	CHECKED BY: Eisley	4/30-14'	.XX ± 0.20/.008 .X: ±	
				APPROVED BY: David	4/30-14'	.XXX ± 0.10/0.04 .XX: ±	

CVILUX CORP
2014.05.09
ISSUED

瀚荃股份有限公司
CviLux Corporation

DRAWING NO.	CI9415SK	PART NO.	CI94PFI*1*L
SCALE	2 / 1	SHEET	1 OF 1