

Part No.	Wire Range	Insulation Diameter	Reel Q'ty
CI94TM3*PPO	AWG #18~#22	2.10 (.083) MAX.	5,000 PCS
CI94TMA*PPO	AWG #18x2~#22x2	2.10 (.083) MAX.	5,000 PCS

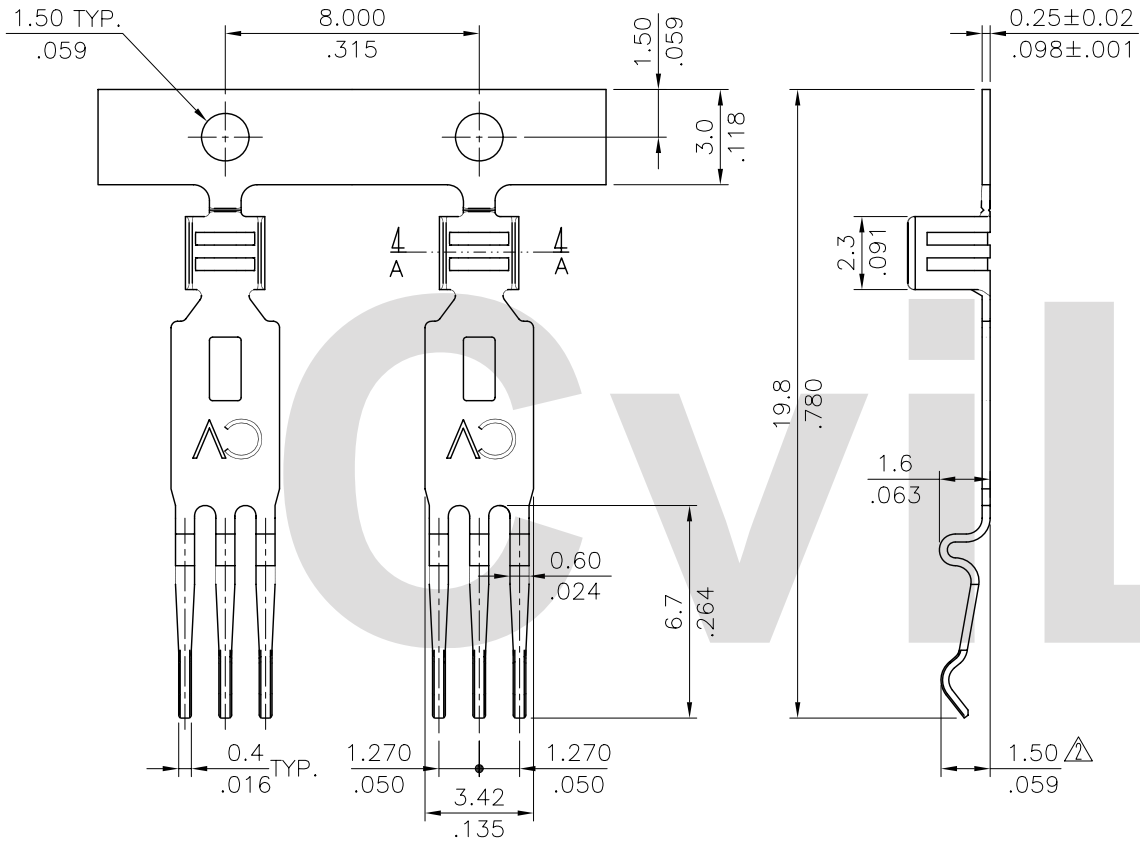

Ordering Code:

CI94 TM* * P P 0
 ① ② ③ ④ ⑤ ⑥

- ① Series No.
- ② TM3 = AWG #18 ~ #22
 TMA = AWG #18x2 ~ #22x2
- ③ Plating Code
 A= Selective Gold flash plated over 50μ" Nickel
 B= Selective 15μ" Gold plated over 50μ" Nickel
 C= Selective 30μ" Gold plated over 50μ" Nickel
- ④ P= Phosphor Bronze
- ⑤ P= Post plating
- ⑥ Other option: 0= Standard

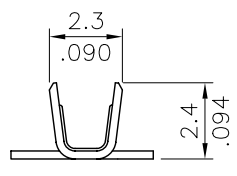

SEC.: A-A
 P/N:CI94TM3*PPO

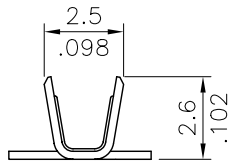

SEC.: A-A
 P/N:CI94TMA*PPO

RoHS Compliant

④						DATE	UNIT: mm / inch	TITLE: SERIAL ATA POWER MOLDING TYPE TERMINAL	 瀚荃股份有限公司 CviLux Corporation
③			DRAWN BY: Eisley		12/21-04'	TOLERANCE UNLESS OTHERWISE SPECIFIED		MATERIAL:	
②			ENGINEER: Eisley		12/21-04'	.X ± 0.30/.012	.X* ± 1'		
①	Eisley	12/21/04'	ECN04420		CHECKED BY: David	12/22-04'	.XX ± 0.20/.010	.X* ±	FINISH:
SYM	NAME	DATE	REVISIONS	APPROVED BY: Alex	12/22-04'	.XXX ± 0.10/0.04	.XX* ±	DRAWING NO. CI9410SA	PART NO. CI94TM**PPO
								SCALE 4 / 1	SHEET 1 OF 1