

Material:

* Insulation: Glass filled polyester UL 94V-0

* Contact: Brass

Ordering Code:

CI79 ** P 1 H *0
 ① ② ③ ④ ⑤ ⑥

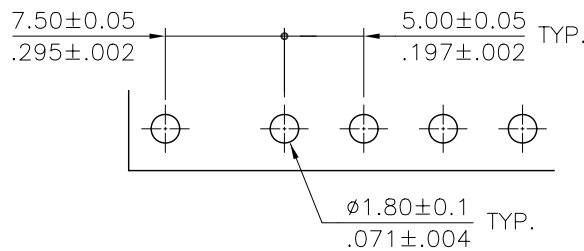
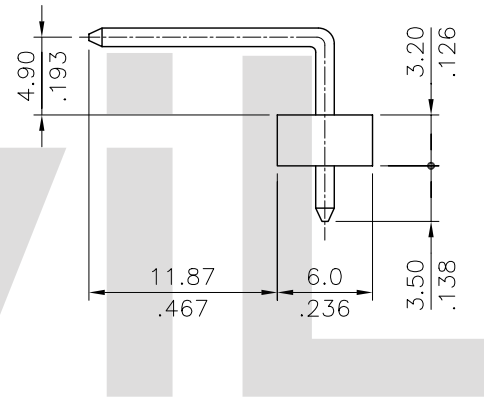
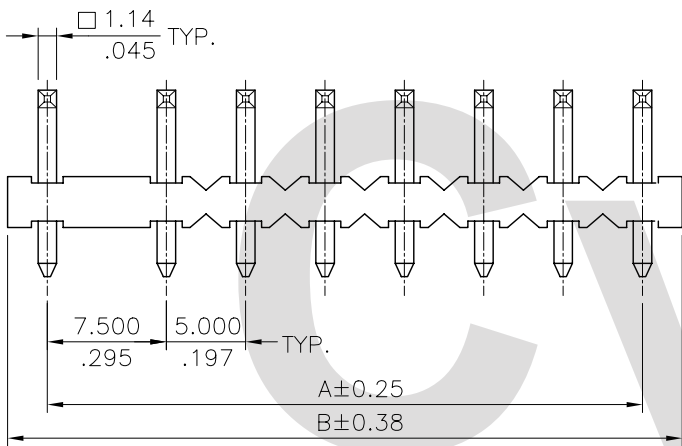

A = 5.00 * No. of Spaces + 2.50

B = A + 5.00

* Available in 2 through 20 circuits

① Series No.

CI79= 7.5-5.0mm center spacing

② No. of Circuits

③ Contact type: P= Pin header

④ Plating option:

1= 3.05μm(120μ") Min. Tin
 over 0.76μm(30μ") Nickel

2= Gold flash plated over
 1.27μm(50μ") Nickel

3= 0.38μm(15μ") Gold plated
 over 1.27μm(50μ") Nickel

4= 0.76μm(30μ") Gold plated
 over 1.27μm(50μ") Nickel

⑤ Tail Style: H= Right angle

△⑥ Option: 00= Color White(Nature)
 10= Color Black

Recommended P.C. Board Layout

RoHS Compliant

④																			
③																			
②																			
①	SUN	8/10/04'	ECN04305																
SYM	NAME	DATE	REVISIONS																

CVILUX.CORP
 2004.08.10
 ISSUED

DRAWN BY: Sun
 ENGINEER: Easley
 CHECKED BY: David
 APPROVED BY: Alex

DATE: 08/10-04'
 08/10-04'
 08/10-04'
 08/10-04'

UNIT: mm / inch
 TOLERANCE
 UNLESS OTHERWISE SPECIFIED
 .X ± 0.38/.015 X' ± 1"
 .XX ± 0.25/.010 X" ±
 .XXX ± 0.15/.006 .XX" ±

TITLE: 7.50-5.00MM(.295"-.197")
 BOARD MOUNT PIN HEADER
 MATERIAL:
 FINISH:

瀚荃股份有限公司
 CviLux Corporation

DRAWING NO. CI7902SD
 SCALE 2 / 1

PART NO. CI79**P1H*0
 SHEET 1 OF 1