

A = 5.00 \* No. of Spaces

B = A + 5.00

\* Available in 2 through 20 circuits

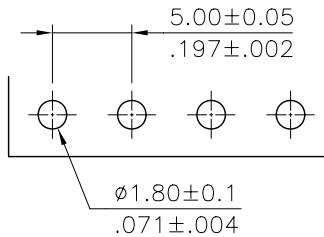

Recommended P.C. Board Layout

Material:

\* Insulation: Glass filled polyester UL 94V-0

\* Contact: Brass

Ordering Code:

CI78 \*\* P 1 V 00  
 ① ② ③ ④ ⑤ ⑥

- ① Series No.  
CI79= 7.5-5.0mm center spacing
- ② No. of Circuits
- ③ Contact type: P= Pin header
- ④ Plating option:  
 1= 3.05μm(120μ") Min. Tin  
 over 0.76μm(30μ") Nickel  
 2= Gold flash plated over  
 1.27μm(50μ") Nickel  
 3= 0.38μm(15μ") Gold plated  
 over 1.27μm(50μ") Nickel  
 4= 0.76μm(30μ") Gold plated  
 over 1.27μm(50μ") Nickel
- ⑤ Tail Style: V= Straight
- ⑥ Option: 00= Color White(Nature)

RoHS Compliant

4						DATE	UNIT: mm / inch	TITLE:	瀚荃股份有限公司 CviLux Corporation	DRAWING NO.	CI7801SC	PART NO.	CI78**P1V00
3						09/28-01'	TOLERANCE UNLESS OTHERWISE SPECIFIED	5.00MM(.197") BOARD MOUNT PIN HEADER		DRAWING NO.	CI7801SC	PART NO.	CI78**P1V00
2						09/28-01'	.X ± 0.38/.015 X' ± 1"	MATERIAL:		SCALE	2 / 1	SHEET	1 OF 1
1						09/28-01'	.XX ± 0.25/.010 X' ±	FINISH:					
SYM	NAME	DATE	REVISIONS	APPROVED BY:	Alex	09/28-01'	.XXX ± 0.15/.006 .XX' ±						

CVILUX.CORP  
 2001.09.28  
 ISSUED